



Pond Lane, Worthing, BN13 2RH

Offers Over £350,000

A charming two-bedroom semi-detached flint stone cottage, built in 2013, offered in excellent condition. The property features a west-facing rear garden, car barn, additional parking space, and an extra garden area used as an allotment. The ground floor includes an entrance hall, lounge/diner with patio doors to the garden, modern fitted kitchen, and a cloakroom. Upstairs, there are two bedrooms with built-in wardrobes and a modern refitted bathroom with a double shower. The west-facing garden is landscaped for low maintenance with a patio, artificial lawn, flower borders, and a garden shed. Additional features include a front courtyard, storage shed, and undercover parking. Viewing is highly recommended to appreciate this delightful cottage.



Council Tax Band: C

- Charming semi-detached flint stone cottage
- West-facing garden with patio and artificial lawn
- Spacious lounge with patio doors to the garden
- Refitted bathroom with a double shower
- Car barn with undercover parking and extra space
- Built in 2013 and offered in excellent condition
- Modern fitted kitchen with integrated appliances
- Two bedrooms with built-in wardrobes
- Additional garden area used as an allotment
- Front courtyard and storage shed included



Worthing, a picturesque seaside town on the south coast of England, exudes a unique charm with its blend of Victorian elegance and contemporary vitality. Known for its extensive pebble beach, historic pier, and well-maintained promenade, Worthing offers residents and visitors alike a captivating coastal experience. The town's vibrant cultural scene is enriched by theatres, art galleries, and frequent events, creating a lively atmosphere. With its beautiful parks, such as Beach House Park and Highdown Gardens, Worthing provides green spaces for leisure and relaxation. The town's bustling town centre features a diverse array of shops, restaurants, and entertainment venues, contributing to its reputation as a welcoming and thriving community. Worthing's accessibility, rich history, and scenic beauty make it a sought-after destination for those seeking a coastal haven with a perfect blend of tradition and modernity.

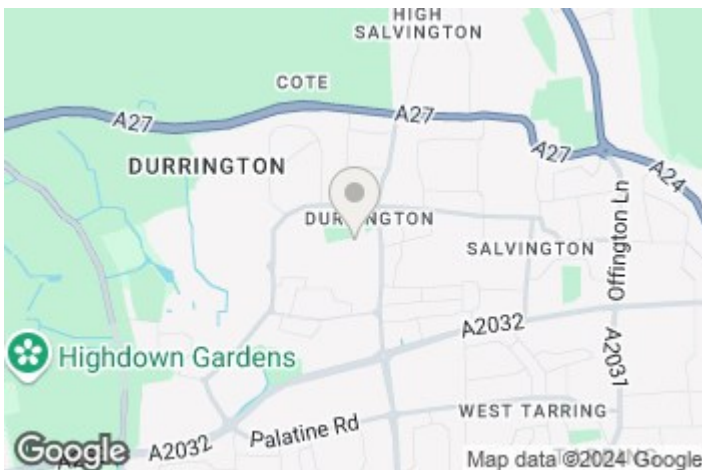

EPC Rating:

C

Energy Efficiency Rating		Current	Potential
Very energy efficient - lower running costs			
(92 plus)	A		90
(81-91)	B		
(69-80)	C	78	
(55-68)	D		
(39-54)	E		
(21-38)	F		
(1-20)	G		
Not energy efficient - higher running costs			
England & Wales		EU Directive 2002/91/EC	

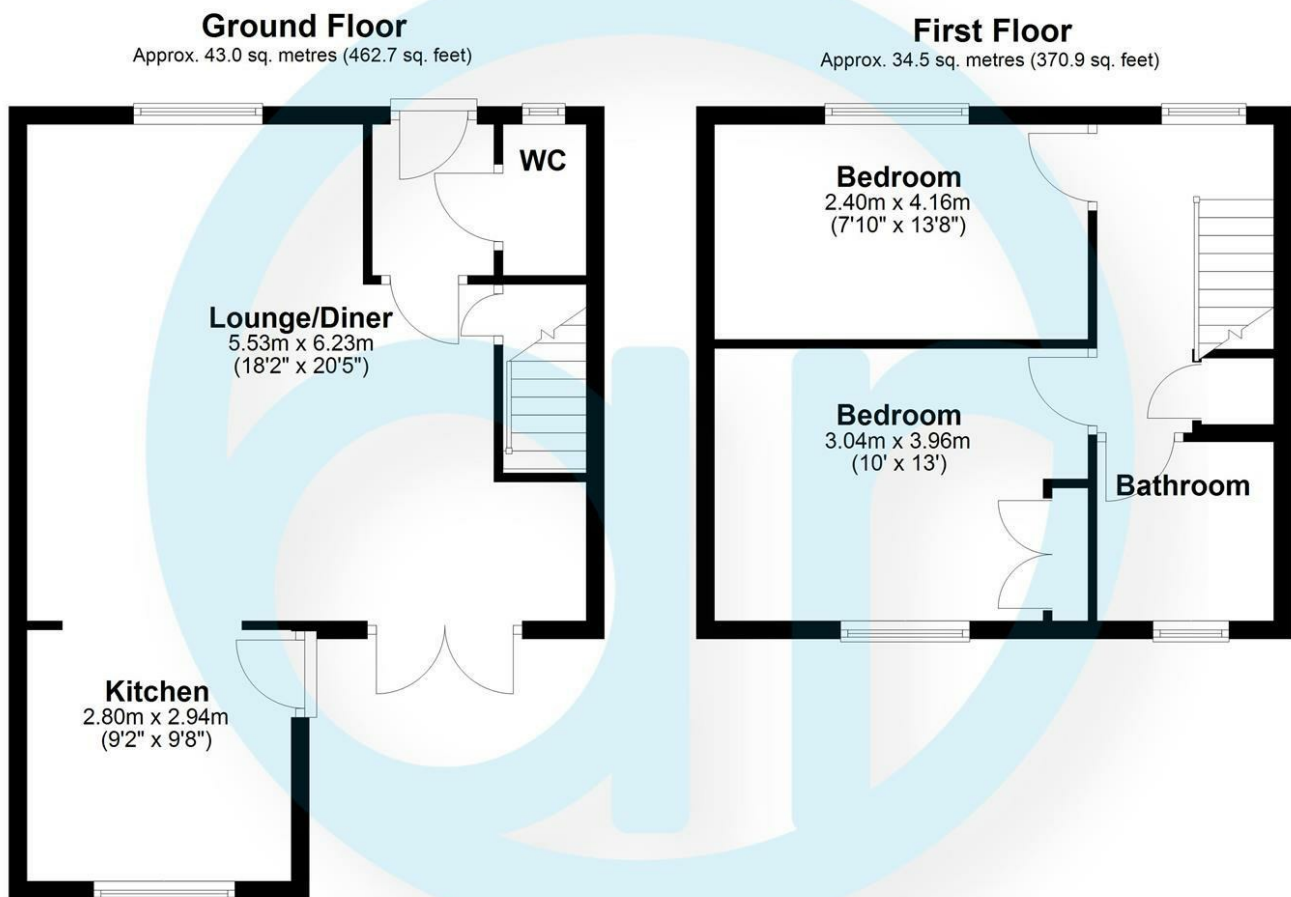

Total area: approx. 77.4 sq. metres (833.6 sq. feet)

Aspire Residential | Goring-by-Sea

28 Goring Road
Goring-by-Sea
Worthing
BN12 4AD
Telephone: 01903 259 961
Email: info@aspireresidential.co.uk



Aspire Residential | Durrington / Salvington

5 Selden Parade
Salvington Road
Worthing
BN13 2HL
Telephone: 01903 910 424
Email: enquiries@aspireresidential.co.uk

Aspire Residential and Aspire Residential Estate Agents are trading names of Aspire Residential Sales Limited, a Company registered in England and Wales with registration number 11659289. VAT No. 317450614

IMPORTANT NOTICE TO PURCHASERS: We endeavour to make our sales particulars accurate and reliable, however, they do not constitute or form part of an offer or any contract and none is to be relied upon as statements of representation or fact. The services, systems and appliances listed in this specification have not been tested by us and no guarantees as to their operating ability or efficiency are given. All measurements have been taken as a guide to prospective buyers only, and are not precise. If you require clarification or further information on any points, please contact us, especially if you are traveling some distance to view.