



9 Pickerings Avenue , Measham, DE12 7SB Price Guide £300,000

*** GUIDE PRICE - £300,000-£310,000 ***

Positioned on a generous corner plot within one of Measham's most desirable developments, this superb three-bedroom detached family home offers well-balanced accommodation, a private garden, and excellent parking options, including a detached single garage.

The property welcomes you with a bright and airy entrance hall leading to a downstairs cloakroom, a spacious dual-aspect reception room, and a contemporary dining kitchen – the perfect space for both everyday family living and entertaining. A separate utility room provides additional practicality.

Upstairs, the home continues to impress with three well-proportioned double bedrooms. The principal bedroom benefits from fitted wardrobes and a modern en-suite shower room, while the remaining bedrooms are served by a stylish family bathroom.

Externally, the house enjoys off-road parking to the side elevation, a detached single garage, and a beautifully maintained rear garden that is both private and non-overlooked – ideal for

Viewing

Please contact our Berkley Kibworth Office on 0116 2796161 if you wish to arrange a viewing appointment for this property or require further information.

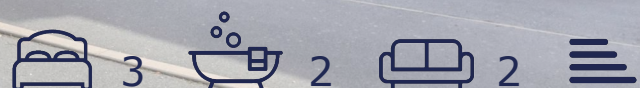

Floor Plan

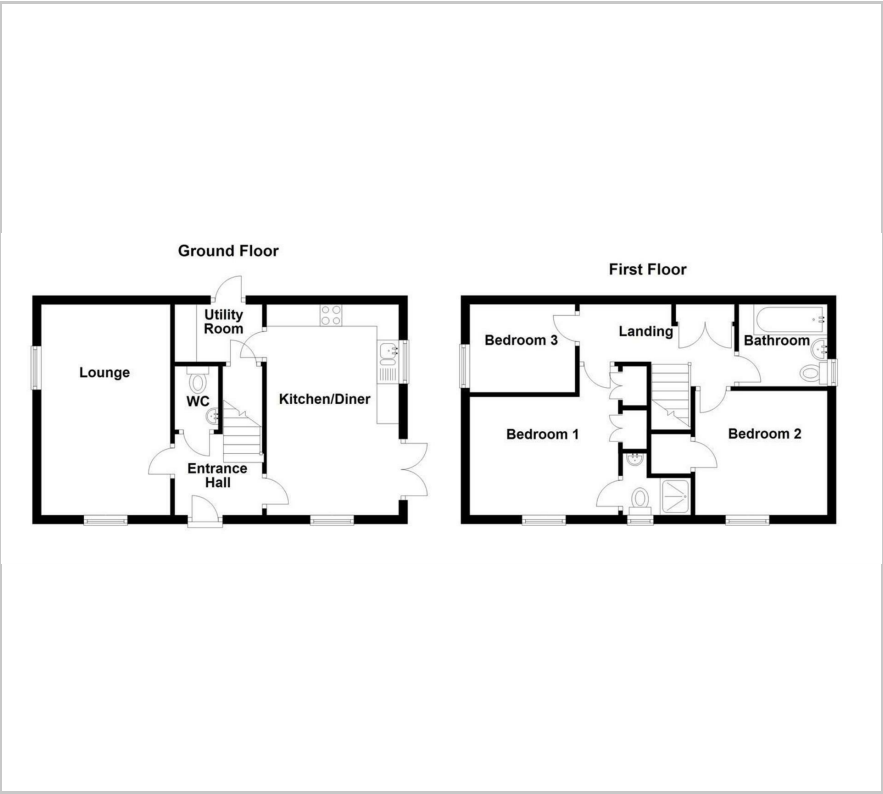

Area Map



Energy Efficiency Graph



These particulars, whilst believed to be accurate are set out as a general outline only for guidance and do not constitute any part of an offer or contract. Intending purchasers should not rely on them as statements of representation of fact, but must satisfy themselves by inspection or otherwise as to their accuracy. No person in this firms employment has the authority to make or give any representation or warranty in respect of the property.