



*Elnathan Mews, London, W9 2JE*  
*Offers In Excess Of £1,000,000 Freehold*







**2 x**  **1 x**  **1 x** 

The subject property is a low-built, semi-detached, two-bedroom terraced house, situated in a charming mews in the sought-after Little Venice area. Spread across two storeys, the property offers two generously sized double bedrooms, two WC facilities, a functional kitchen, a lobby area, and the added benefit of a private unofficial roof terrace, perfect for outdoor relaxation or additional workspace.

Originally constructed in the 1990s with solid brick elevations, the property remains in structurally sound condition. Internally, while the building features a basic finish, it presents an ideal opportunity for refurbishment to suit modern requirements. The property is equipped with a gas central heating system, with radiators installed throughout. Unofficial roof terrace that been used for many decades.



Elnathan mews, London, W9  
Approximate Gross Internal Floor Area = 77.4 sq m / 834 sq ft

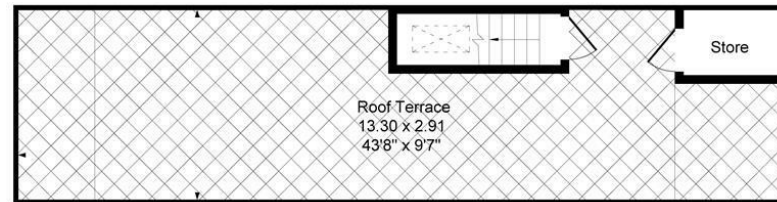

Second Floor



First Floor

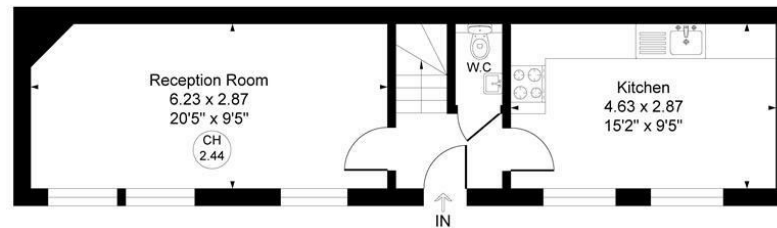

Ground Floor

Illustration for identification purposes only, measurements are approximate, not to scale.

**Important Notice** Debussy Property Service Ltd trading as Braithwait for themselves and for the vendor of this property whose agents they are, give notice that (i) these particulars do not constitute any part of an offer or contract, (ii) all statements contained within these particulars are made without responsibility on the part of Braithwait or the vendor, (iii) whilst none in good faith, none of the statements contained within these particulars are to be relied upon as a statement of representation or fact, (iv) any intending purchaser must satisfy him/herself by inspection or otherwise as to the correctness of each of the statements contained within these particulars, (v) the vendor does not make or give either Braithwait or any person within their employment any authority to make or give any representation or warranty whatsoever in relation to this property. Wide angled lenses may be used in photographs.

Call us on 0207 289 8889 or email [sales@braithwait.co.uk](mailto:sales@braithwait.co.uk)

