



*Castellain Road, London, W9 1HD  
Offers Over £760,000 Leasehold*





2 x  1 x  1 x 

An opportunity to buy a bright two bedroom ground floor apartment in need of cosmetic renovation only, and priced reasonably to reflect the condition. This 910 sq ft flat comprises two bedrooms on the ground floor of a desirable red brick mansion block on Castellain Road which has potential and flexibility to mould itself to the buyers needs with the possibly to add another bathroom. Benefits include a new 999 year lease just acquired , and is ideally situated on a quiet one way tree lined street in the heart of Maida Vale, half way between the junction of Randolph Avenue and Elgin Avenue, close to the cafes and shops of Lauderdale Parade and the tube at Warwick Avenue or Maida Vale.



Castellain Mansions, Castellain Road, London W9  
Approximate Gross Internal Area  
911 sq ft - 85 sq m

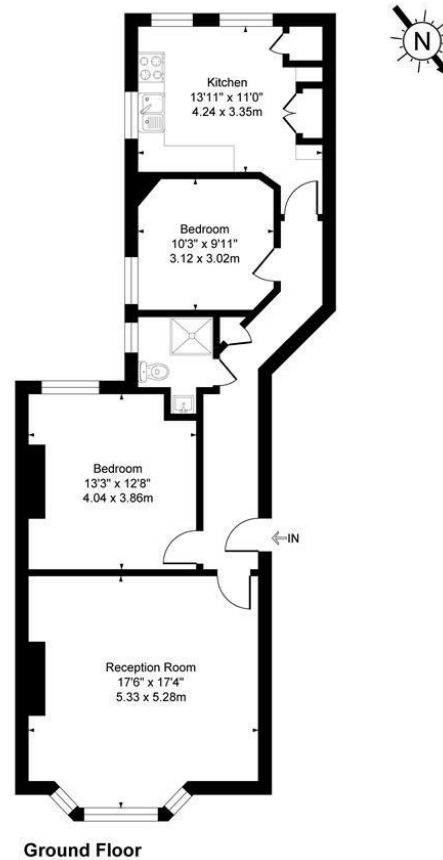

Ground Floor

Illustration for identification purposes only, not in scale

**Important Notice** Debussy Property Service Ltd trading as Braithwait for themselves and for the vendor of this property whose agents they are, give notice that (i) these particulars do not constitute any part of an offer or contract, (ii) all statements contained within these particulars are made without responsibility on the part of Braithwait or the vendor, (iii) whilst none in good faith, none of the statements contained within these particulars are to be relied upon as a statement of representation or fact, (iv) any intending purchaser must satisfy him/herself by inspection or otherwise as to the correctness of each of the statements contained within these particulars, (v) the vendor does not make or give either Braithwait or any person within their employment any authority to make or give any representation or warranty whatsoever in relation to this property. Wide angled lenses may be used in photographs.

Call us on 0207 289 8889 or email [sales@braithwait.co.uk](mailto:sales@braithwait.co.uk)

