



**Allesley Hall Drive, Coventry, CV5 9RD**

**Loveitts**  
PART OF | SHELDON BOSLEY KNIGHT



# Property Description

This stunning two bedroom retirement apartment for over 55s has just come to market. This property is located in the highly sought-after area of Allesley, located in the very desirable Dovecotes development at the heart of Allesley Park. This property is within proximity to several major supermarkets, public transport and benefits from having great links to motorways

This property is located on the ground floor and consists of a communal entrance accessed via an intercom, an entrance hallway, a very spacious lounge/dining room, a kitchen, a family bathroom and two generously sized bedrooms.

\*\*\*\*VIEWING IS HIGHLY RECOMENDED  
CALL TO BOOK YOUR TIME SLOT\*\*\*\*







## Key Features

- VERY SOUGHT AFTER LOCATION
- ALLOCATED PARKING
- PRESTIGE OVER 55'S APARTMENT
- TWO BEDROOM ON THE GROUND FLOOR
- SHORT WALK FROM ALLESLEY PARK
- GREAT PUBLIC TRANSPORT LINKS
- GENEROUSLY SIZED BEDROOMS
- NO ONWARD CHAIN
- SECURE INTERCOM ENTRANCE
- EPC- TBC

**Offers In The Region  
Of  
£160,000**





## Ground Floor

Approx. 51.5 sq. metres (554.7 sq. feet)

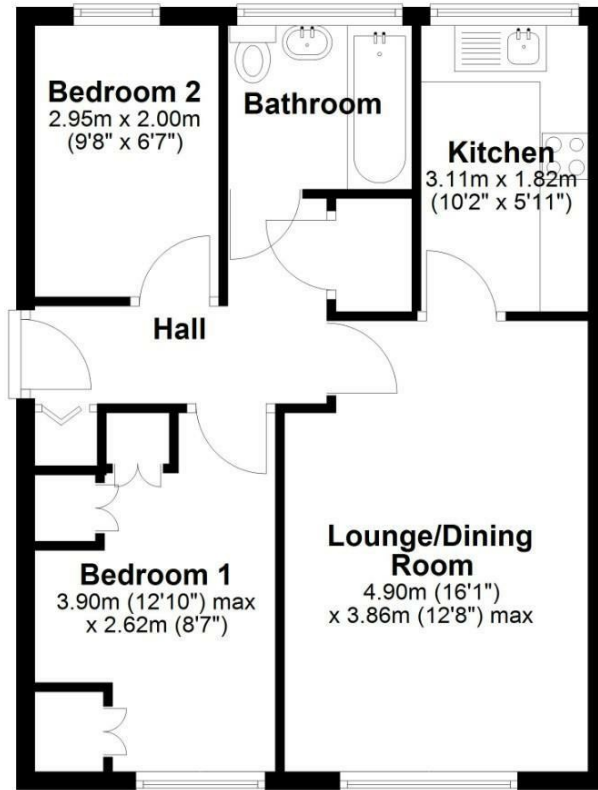

Total area: approx. 51.5 sq. metres (554.7 sq. feet)



EPC Rating -

Tenure - Leasehold

Council Tax Band - B

Local Authority  
Coventry City Council

We routinely refer clients to both our recommended Legal Firm and a panel of Financial Services Providers. It is your decision whether you choose to deal with these companies. In making that decision, you should know that we receive a referral fee





To view this property please contact our Loveitts Coventry (Sales) office  
on 02476 258421