



Upper Eastern Green Lane, Coventry, CV5 7DJ

Property Description

Loveitts welcomes to the market this three bedroom semi detached property situated in the popular residential area of Eastern Green. The property in brief comprises of entrance hallway, large lounge/dining room, fitted kitchen, three bedrooms, one of which is split so used as two bedrooms, a family bathroom and separate WC. Outside there is a rear garden and large frontage allowing for ample parking.

Having local amenities and in close proximity to multiple schools including Park Hill Primary and Eastern Green Junior, making this an ideal family residence.

Call us now to arrange your viewing.





Key Features

- Semi Detached Family Home
- Three/Four Bedrooms
- Double glazed and Gas central heated
- Enclosed Rear garden
- Driveway and Garage
- Refitted Bathroom
- Separate WC
- Call now to arrange a viewing
- EPC -TBC

**Offers In Excess Of
£280,000**



Ground Floor

Approx. 43.8 sq. metres (470.9 sq. feet)

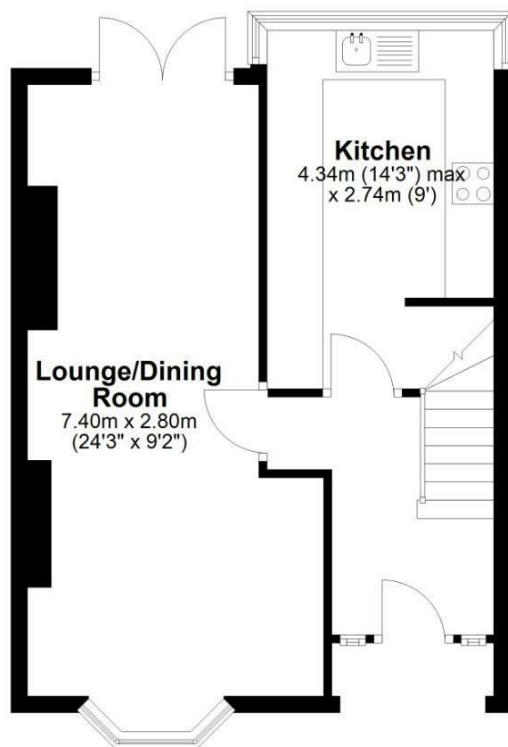

First Floor

Approx. 41.5 sq. metres (447.1 sq. feet)

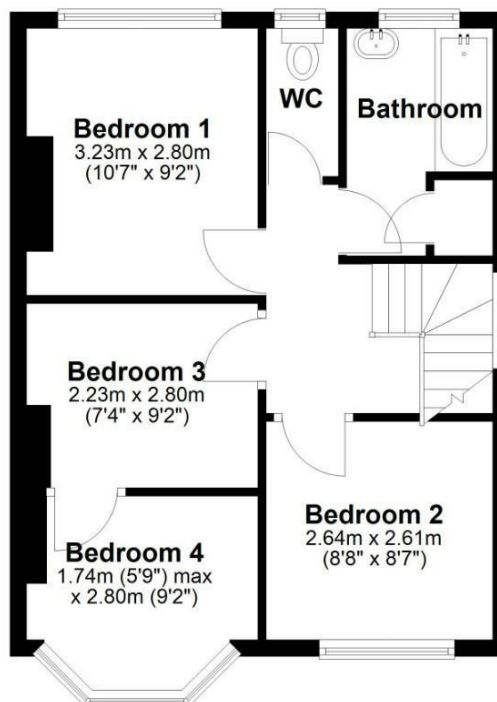

Total area: approx. 85.3 sq. metres (918.0 sq. feet)

All efforts have been made to ensure that the measurements on this floorplan are accurate however these are for guidance purposes only.
Plan produced using PlanUp.



EPC Rating -

Tenure - Freehold

Council Tax Band - C

Local Authority
Coventry City Council

We routinely refer clients to both our recommended Legal Firm and a panel of Financial Services Providers. It is your decision whether you choose to deal with these companies. In making that decision, you should know that we receive a referral fee



To view this property please contact our Loveitts Coventry (Sales) office
on 02476 258421