



Partridge Croft, Coventry, CV6 7EY

Property Description

A fantastic opportunity to acquire this well-presented, three bedroom mid-terraced property positioned in the popular residential location of Bell Green. The property is perfect for a first time buyer or family due to its close proximity to local shops, amenities and schools and is also offered for sale with no onward chain.

The ground floor accommodation comprises entrance hall with stairs rising to the first floor, spacious lounge with opening to the fitted kitchen/diner and door leading to a ground floor W.C. and rear garden. To the first floor are three bedrooms and the family bathroom featuring bath and over shower.

Further benefits include a front garden, a generous rear mostly laid to lawn, gas central heating and double glazing throughout.





Key Features

- Three Bedroom Family Home
- Spacious Lounge
- Fitted Kitchen/Diner
- Ground Floor W.C
- Family Bathroom
- No Onward Chain
- Popular Residential Location
- EPC - C

£180,000



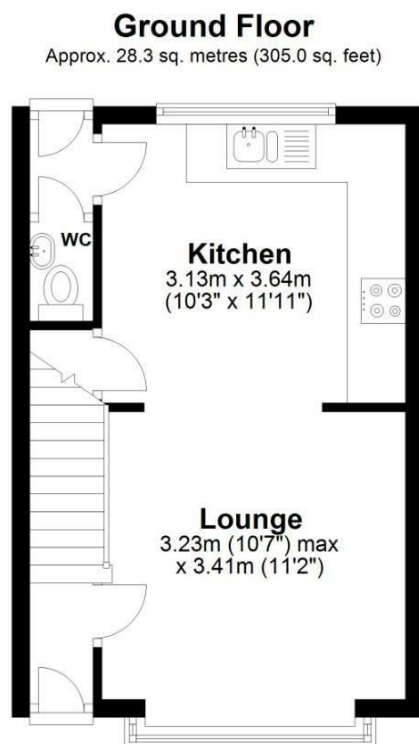

Total area: approx. 57.6 sq. metres (619.7 sq. feet)

All efforts have been made to ensure that the measurements on this floorplan are accurate however these are for guidance purposes only.
Plan produced using PlanUp.



EPC Rating - C

Tenure - Freehold

Council Tax Band - A

Local Authority

We routinely refer clients to both our recommended Legal Firm and a panel of Financial Services Providers. It is your decision whether you choose to deal with these companies. In making that decision, you should know that we receive a referral fee



To view this property please contact our Loveitts Coventry (Sales) office
on 02476 258421