



Standard Avenue, Coventry, CV4 9BS

**Loveitts**  
PART OF | SHELDON BOSLEY KNIGHT



# Property Description

A fantastic opportunity to acquire this three bedroom family home situated in the popular residential location of Tile Hill. The property is perfect for a first time buyer, family or investor due to its convenient access to great road links, local shops, amenities and schools. The property is also offered for sale with no onward chain.

The accommodation on offer comprises entrance hallway with stairs rising to the first floor, lounge with bay window, separate dining room and fitted kitchen with oven and gas hob. To the first floor are two double bedrooms, a single bedroom and the family bathroom.

Further benefits include a front garden and a generous rear garden mostly laid to lawn.









# Key Features

- Three Bedroom Family Home
- Popular Residential Location
- Lounge
- Separate Dining Room
- Fitted Kitchen
- Family Bathroom
- No Onward Chain
- EPC - D

**£200,000**

EPC Rating - D

Tenure - Freehold

Council Tax Band - B

Local Authority -  
Coventry

## Ground Floor

Approx. 35.7 sq. metres (383.9 sq. feet)

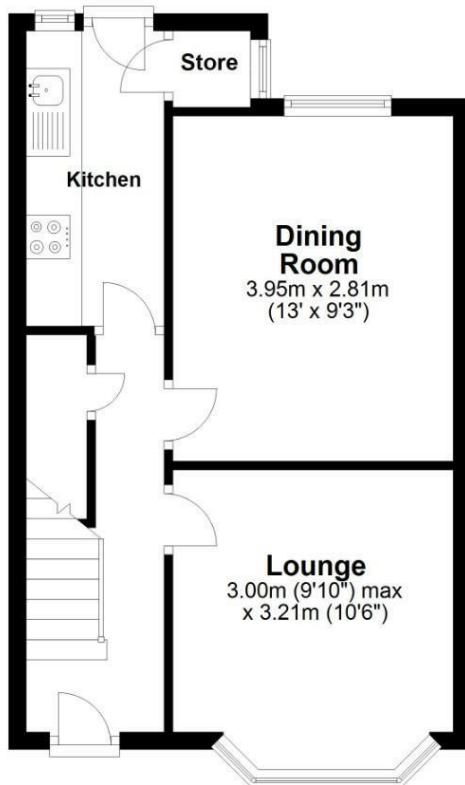

## First Floor

Approx. 34.8 sq. metres (374.2 sq. feet)

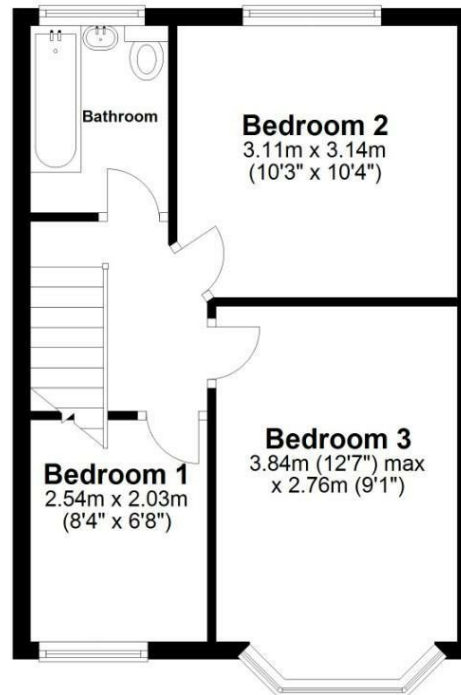

Total area: approx. 70.4 sq. metres (758.1 sq. feet)

All efforts have been made to ensure that the measurements on this floorplan are accurate however these are for guidance purposes only.  
Plan produced using PlanUp.

We routinely refer clients to both our recommended Legal Firm and a panel of Financial Services Providers. It is your decision whether you choose to deal with these companies. In making that decision, you should know that we receive a referral fee