

Loveitts est. 1843

part of

**SHELDON
BOSLEY
KNIGHT**

LAND AND
PROPERTY
PROFESSIONALS



Eastcotes, Coventry, CV4 9AS

Property Description

A great opportunity to acquire this three bedroom, mid-terraced property situated in the conveniently and popular residential location of Tile Hill. The property is in need of modernisation and is perfect for a first time buyer, family or investor looking to add to their portfolio. The property is also offered for sale with no onward chain.

The ground floor accommodation on offer comprises entrance hallway with stairs rising to the first floor, generous through lounge/diner featuring bay window and fitted kitchen with door leading to a rear lean-to. To the first floor are two double bedrooms, one spacious single bedroom and the family bathroom.

Further benefits include front garden, gas central heating and a considerable secure rear garden mostly laid to lawn.





Key Features

- Mid-Terraced Family Home
- Three Bedrooms
- Through Lounge/Diner
- Fitted Kitchen
- Family Bathroom
- In Need of Modernisation
- Generous Rear Garden
- No Onward Chain
- Popular Residential Location
- EPC - D

£170,000



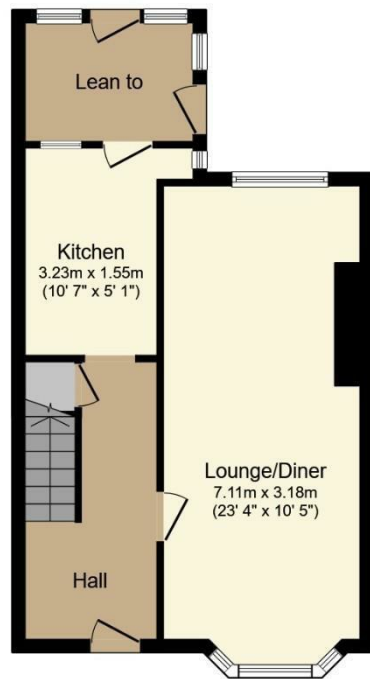

Ground Floor

Floor area 45.2 m² (487 sq.ft.)

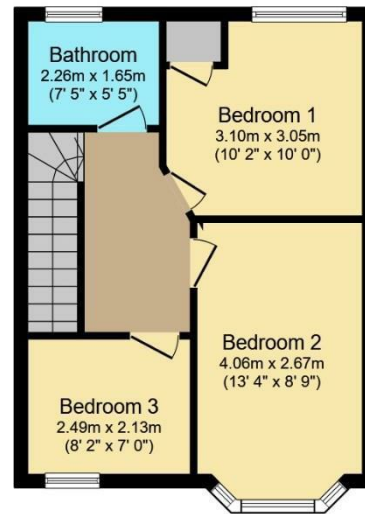

First Floor

Floor area 38.4 m² (413 sq.ft.)

TOTAL: 83.6 m² (900 sq.ft.)

This floor plan is for illustrative purposes only. It is not drawn to scale. Any measurements, floor areas (including any total floor area), openings and orientations are approximate. No details are guaranteed, they cannot be relied upon for any purpose and do not form any part of any agreement. No liability is taken for any error, omission or misstatement. A party must rely upon its own inspection(s). Powered by www.Propertybox.io



EPC Rating - D

Tenure - Freehold

Council Tax Band - B

Local Authority
Coventry City

We routinely refer clients to both our recommended Legal Firm and a panel of Financial Services Providers. It is your decision whether you choose to deal with these companies. In making that decision, you should know that we receive a referral fee



**To view this property please contact our Loveitts Coventry (Sales) office
on 02476 258421**