



57 Walsall Street, Canley, Coventry, CV4 8EZ

Loveitts are pleased to offer this three bedroom semi-detached house in Canley, Coventry. The property comprises of an entrance hallway, a living room with a feature fireplace, a large modern fitted kitchen with an integrated fridge freezer, washing machine and dishwasher and a downstairs W/C and sink. The upstairs comprises of two double bedrooms and a single bedroom and a family bathroom.

The property benefits from a rear garden, gas central heating and double glazing.

Available July - Deposit £1145

Council Tax Band A - Minimum Tenancy 6 Months

- Canley
- Semi Detached
- Three Bedrooms
- Rear Garden
- Council Tax Band A
- Available July
- Unfurnished
- Driveway
- Minimum Tenancy 6 Months

£995 Per Calendar Month

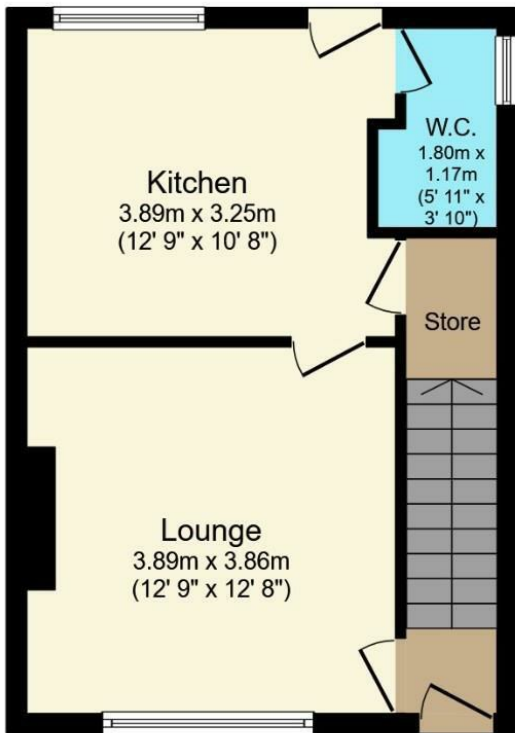

Ground Floor
 Floor area 35.7 sq.m. (385 sq.ft.) approx

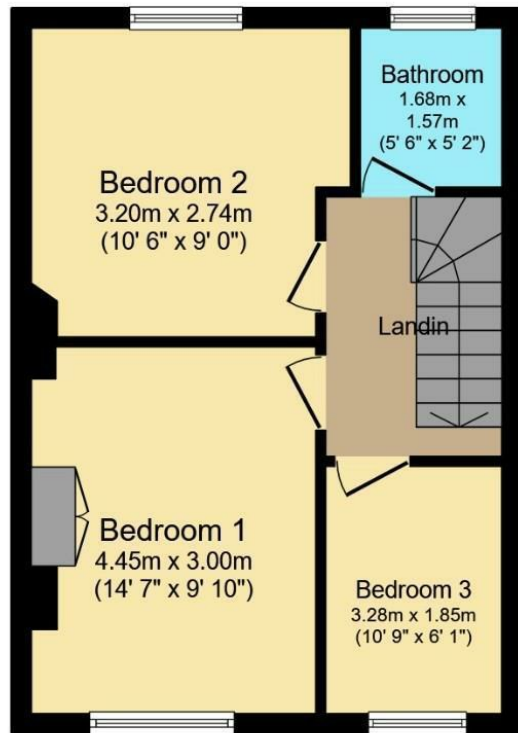

First Floor
 Floor area 35.7 sq.m. (385 sq.ft.) approx

Total floor area 71.4 sq.m. (769 sq.ft.) approx

This Floor Plan is for illustration purposes only and may not be representative of the property. The position and size of doors, windows and other features are approximate. Unauthorized reproduction prohibited. © PropertyBOX

Energy Efficiency Rating		Current	Potential
Very energy efficient - lower running costs			
(92 plus) A			88
(81-91) B			
(69-80) C			
(55-68) D			
(39-54) E		59	
(21-38) F			
(1-20) G			
Not energy efficient - higher running costs			
England & Wales		EU Directive 2002/91/EC	

Environmental Impact (CO ₂) Rating		Current	Potential
Very environmentally friendly - lower CO ₂ emissions			
(92 plus) A			88
(81-91) B			
(69-80) C			
(55-68) D			
(39-54) E			
(21-38) F			
(1-20) G			
Not environmentally friendly - higher CO ₂ emissions			
England & Wales		EU Directive 2002/91/EC	

SCAN HERE TO REGISTER YOUR INTEREST

29 Warwick Row, Coventry, West Midlands, CV1 1DY
 Tel: 02476 228111 Email: lettings@loveitts.co.uk



- RURAL
- SALES
- LETTINGS
- PLANNING & ARCHITECTURAL
- COMMERCIAL
- SURVEYS & VALUATIONS
- NEW HOMES
- BLOCK MANAGEMENT