

Loveitts est. 1943

part of

SHELDON
BOSLEY
KNIGHT

LAND AND
PROPERTY
PROFESSIONALS



Kentmere Close, Coventry, CV2 2GE

Property Description

Welcome to this three bedroom, semi-detached family home situated in the sought after residential location of Potters Green. The property is in need of modernisation throughout, is perfect for first time buyer or family looking to add their own personal touch to create a space that truly reflects their taste and style. The property is also offered for sale with no onward chain.

The ground floor accommodation comprises entrance hallway with stairs rising to the first floor, lounge with double doors opening to a separate dining room, fitted kitchen with door leading to the rear garden and rear extension housing a spacious shower room. To the first floor are two double bedrooms, a single bedroom and a further shower room.

Further benefits include boasts a well-maintained front garden, a generous mature rear garden, garage and double glazing throughout.





Location

Kentmere Close is situated in the residential location of Potters Green, a popular area for families with its close proximity to multiple shops, bus routes, open fields, parks, local pubs and restaurants.

The property also benefits from its easy access to University Hospital and road links including the M6, M1 & M69 to get you in and around the city with ease.

The property is ideally located close to a variety of primary and secondary schools such as Grace Academy Coventry and Potters Green.



Key Features

- End Terrace Family Home
- Three Bedrooms
- Lounge
- Separate Dining Room
- Ground Floor Shower Room
- Fitted Kitchen
- Upstairs Shower Room
- Front and Rear Gardens
- Garage
- No Onward Chain

**Offers Over
£170,000**

EPC Rating - F

Tenure - Freehold

Council Tax Band - B

Local Authority -
Coventry City

Ground Floor
Approx. 57.2 sq. metres (616.1 sq. feet)



First Floor
Approx. 37.5 sq. metres (403.2 sq. feet)

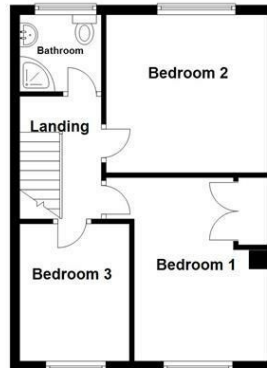

Total area: approx. 94.7 sq. metres (1019.2 sq. feet)

All efforts have been made to ensure that the measurements on this floorplan are accurate however these are for guidance purposes only.
Plan produced using PlanUp.