

# Lugus HOMES



## Wandsworth Road, London

Asking price £699,999



A beautifully presented south-west facing two-bedroom, two-bathroom apartment in the iconic Sky Gardens, Nine Elms.

The apartment features a bright open-plan living area with floor-to-ceiling windows, a fully integrated kitchen, and a winter garden showcasing stunning panoramic views across the London skyline. Both bedrooms are well-proportioned, with the principal bedroom including an en-suite and fitted wardrobes. Additional benefits include underfloor heating and comfort cooling for year-round comfort.

Residents enjoy a 24-hour concierge, gym, and landscaped gardens on the 8th and 35th floors. Ideally located just 0.1 miles from Nine Elms Northern Line Station and within a 0.4-mile radius of Vauxhall Station, offering Victoria Line and National Rail services into and out of London.

Photos may show similar apartments within the development.



Area Map

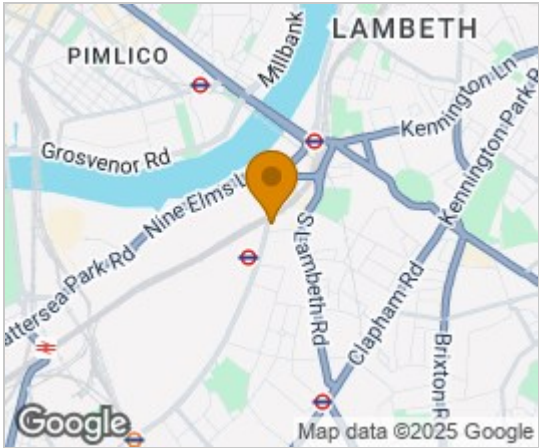

Floor Plans

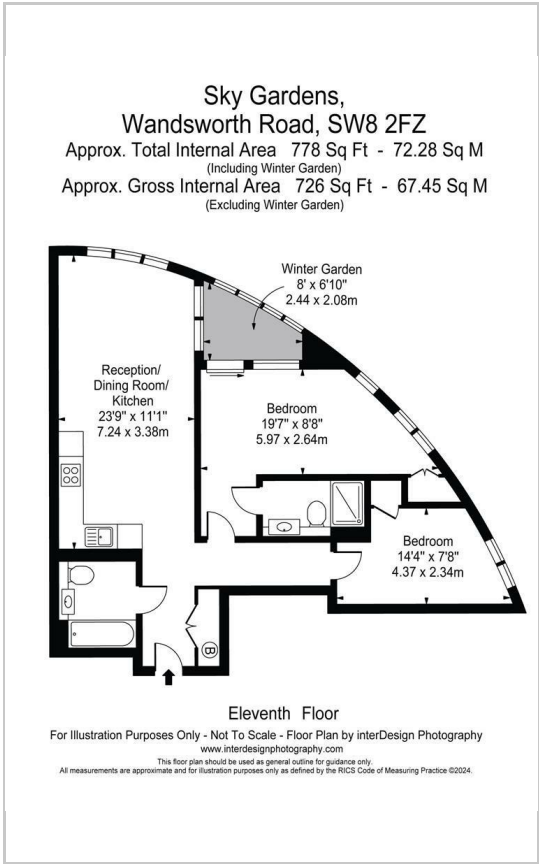

Energy Efficiency Graph

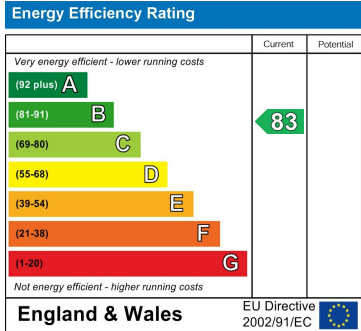

These particulars, whilst believed to be accurate are set out as a general outline only for guidance and do not constitute any part of an offer or contract. Intending purchasers should not rely on them as statements of representation of fact, but must satisfy themselves by inspection or otherwise as to their accuracy. No person in this firms employment has the authority to make or give any representation or warranty in respect of the property.