

# Lugus HOMES



1 Riverside Court, London, SW8 5DB

Asking price £945,000









# 1 Riverside Court

London, SW8 5DB

- River facing views
- 2 Bathrooms
- 1,164 internal square feet
- Recently refurbished
- Long Lease
- 3 Bedrooms
- On-site porter service
- Car parking space included
- West-facing aspect
- Ample storage within apartment

This three bedroom riverside property is located in the sought after and exclusive Riverside Court development on the South bank of the River Thames is a must see.

The property has been refurbished throughout offering great value for money with approximately 1,164 sq. ft of internal living space, three double bedrooms (with built in wardrobes) and two bathrooms. There is a fully equipped separate kitchen, a large reception room and fantastic views of the River Thames.

Situated 0.4 mile radius from Vauxhall Station (Victoria Line and National Rail) and 0.5 mile radius to the Northern Line Stations at Nine Elms and Battersea Power Station, enabling quick access into Central London and the West End. Waitrose, Sainsbury's and a number of boutique independent café's and bars all can be found within walking distance.

Further benefits include a gated car parking space, on-site concierge service with a long lease and a share of freehold.





Directions







## Floor Plans

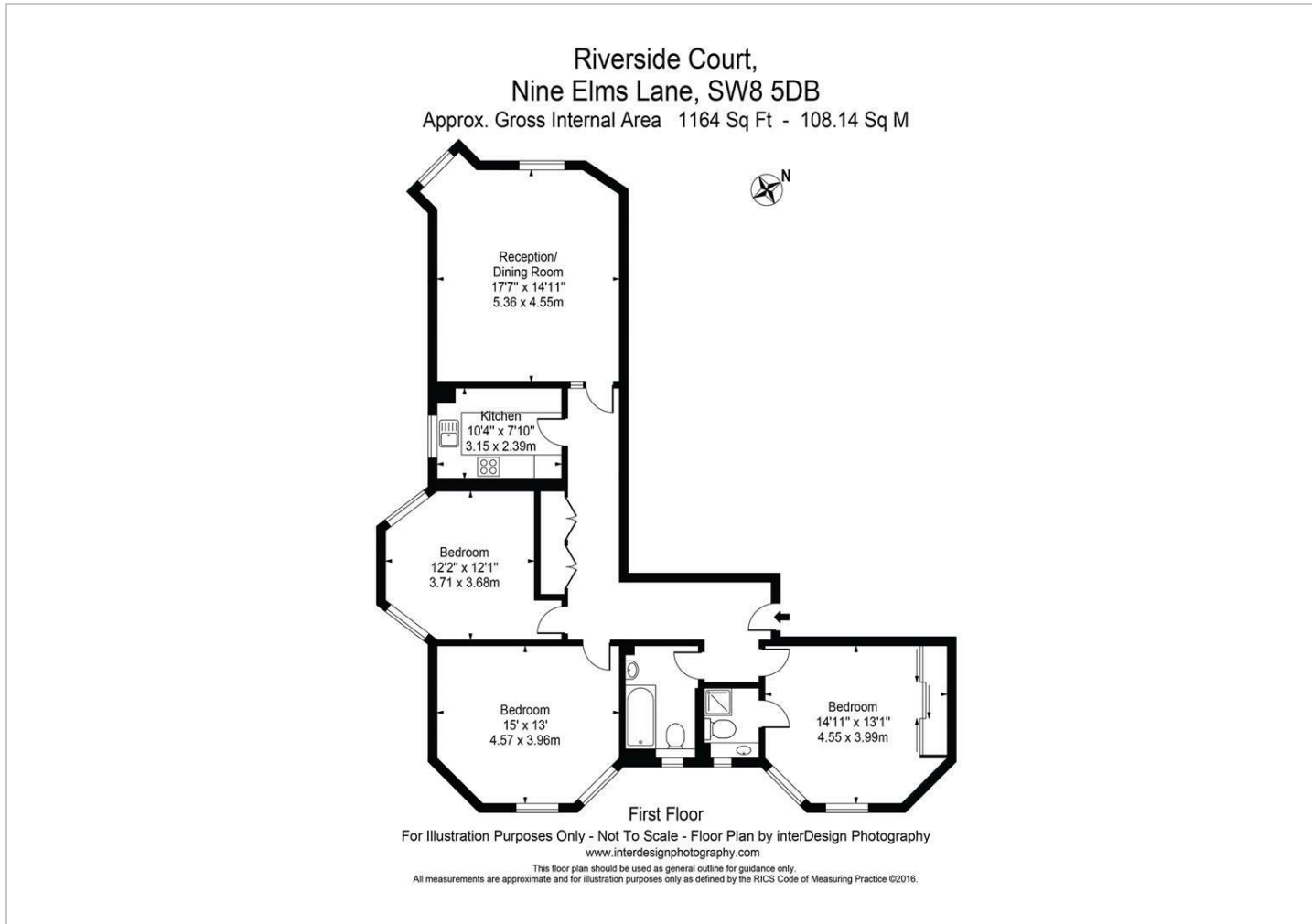

## Viewing

Please contact our Lugas Homes Office on 07787 560885 if you wish to arrange a viewing appointment for this property or require further information.

The particulars are set out as a general outline only for the guidance of intended purchasers or lessees, and do not constitute, any part of a contract. Nothing in these particulars shall be deemed to be a statement that the property is in good structural condition or otherwise nor that any of the services, appliances, equipment or facilities are in good working order. Purchasers should satisfy themselves of this prior to purchasing.

24 Lower Downs Road, Raynes Park, London, SW20 8QG  
Tel: 07787 560885 Email: info@lugushomes.co.uk lugushomes.co.uk

## Location Map

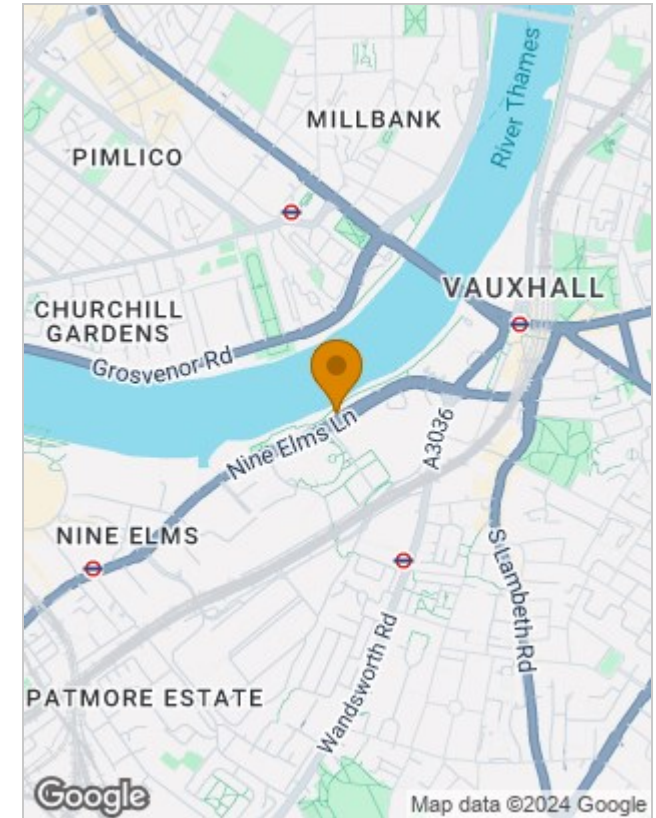

## Energy Performance Graph

