



33 Savoy House 5 Lockgate Road, London, SW6 2WH

£3,750 Per month





£3,750 Per month

33 Savoy House 5 Lockgate Road

London, SW6 2WH

A stunning brand new two-bedroom two-bathroom apartment is a must see at Chelsea Creek. Located on the fifth floor, the property benefits from 778 Sq. Ft of internal living space, offering a bright and spacious open plan kitchen and living room, making this property the perfect place to entertain and relax.

The apartment benefits from floor to ceiling windows, fully equipped and integrated Miele kitchen appliances, underfloor heating and comfort cooling, private balcony, two double bedrooms with built in wardrobes, family bathroom and ensuite to the main bedroom.

This property is rented unfurnished.



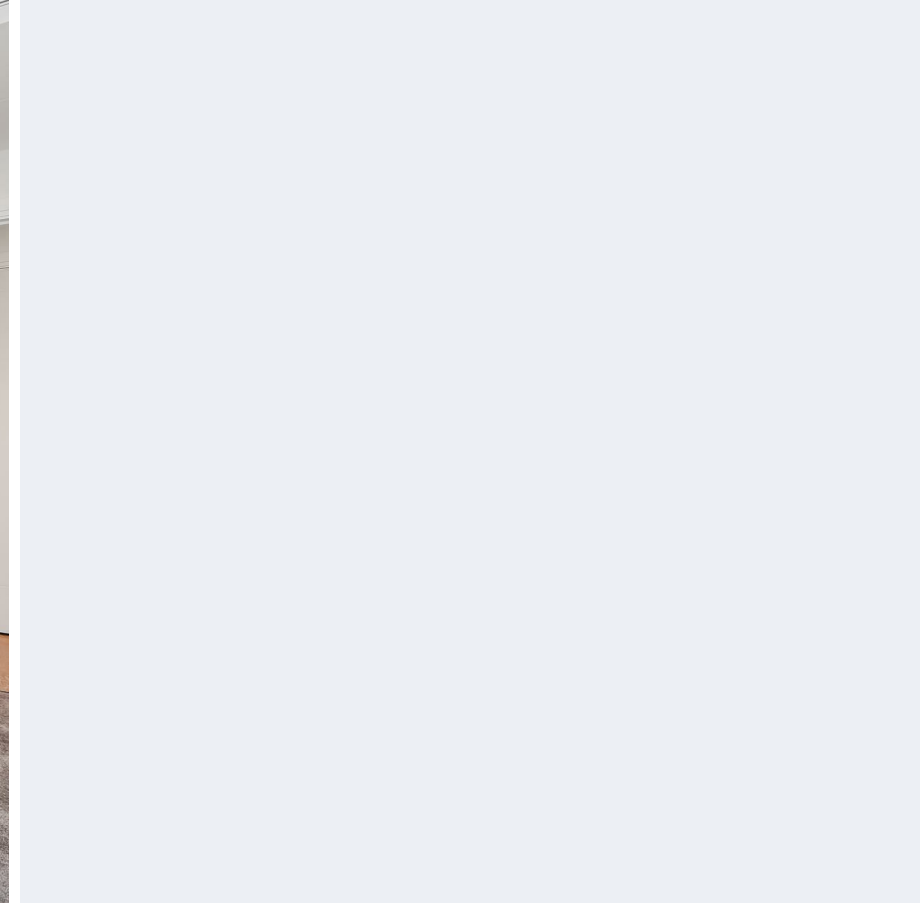

Directions





Floor Plans

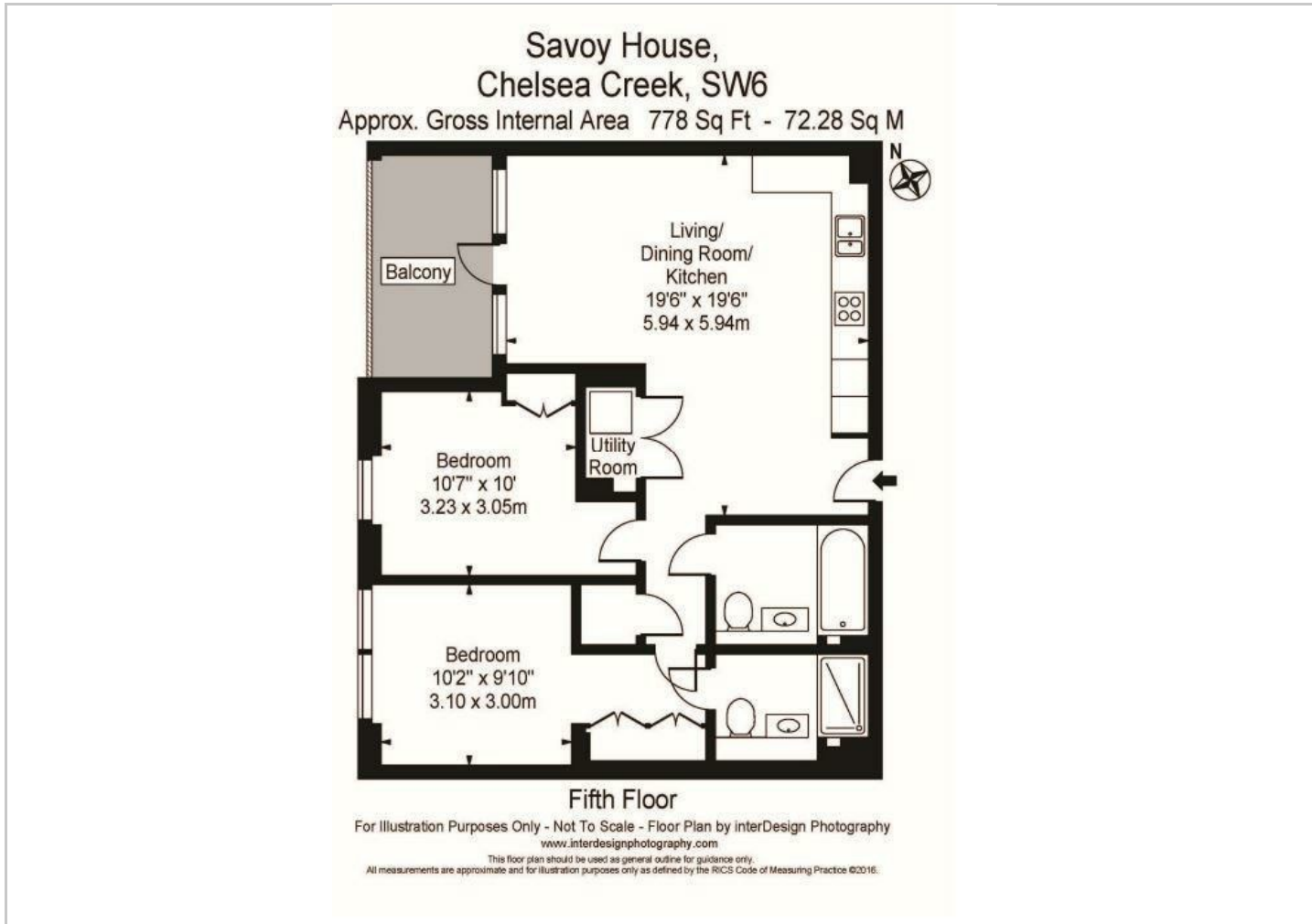

Viewing

Please contact our Lugas Homes Office on 07787 560885 if you wish to arrange a viewing appointment for this property or require further information.

The particulars are set out as a general outline only for the guidance of intended purchasers or lessees, and do not constitute, any part of a contract. Nothing in these particulars shall be deemed to be a statement that the property is in good structural condition or otherwise nor that any of the services, appliances, equipment or facilities are in good working order. Purchasers should satisfy themselves of this prior to purchasing.

24 Lower Downs Road, Raynes Park, London, SW20 8QG
Tel: 07787 560885 Email: info@lugushomes.co.uk lugushomes.co.uk

Location Map

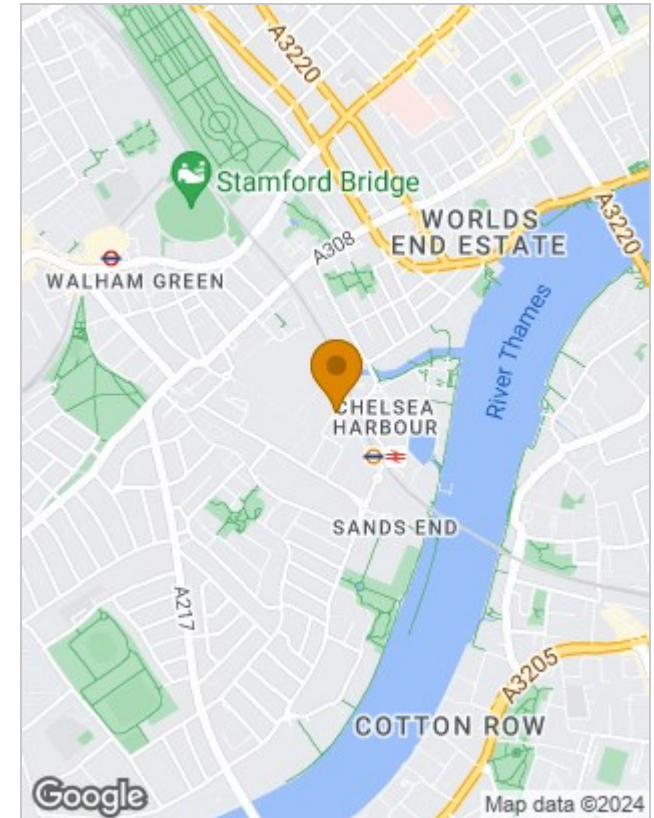

Energy Performance Graph

Energy Efficiency Rating		Current	Potential
<i>Very energy efficient - lower running costs</i>			
(92 plus) A			
(81-91) B			
(69-80) C			
(55-68) D			
(39-54) E			
(21-38) F			
(1-20) G			
<i>Not energy efficient - higher running costs</i>			
England & Wales	EU Directive 2002/91/EC		