

Directions

Viewings

Viewings by arrangement only. Call 01604 210693 to make an appointment.

EPC Rating

Energy Efficiency Rating		
	Current	Potential
Very energy efficient - lower running costs		
(92 plus) A		
(81-91) B		
(69-80) C		
(55-68) D		
(39-54) E		
(21-38) F		
(1-20) G		
Not energy efficient - higher running costs		
England & Wales		
EU Directive 2002/91/EC		

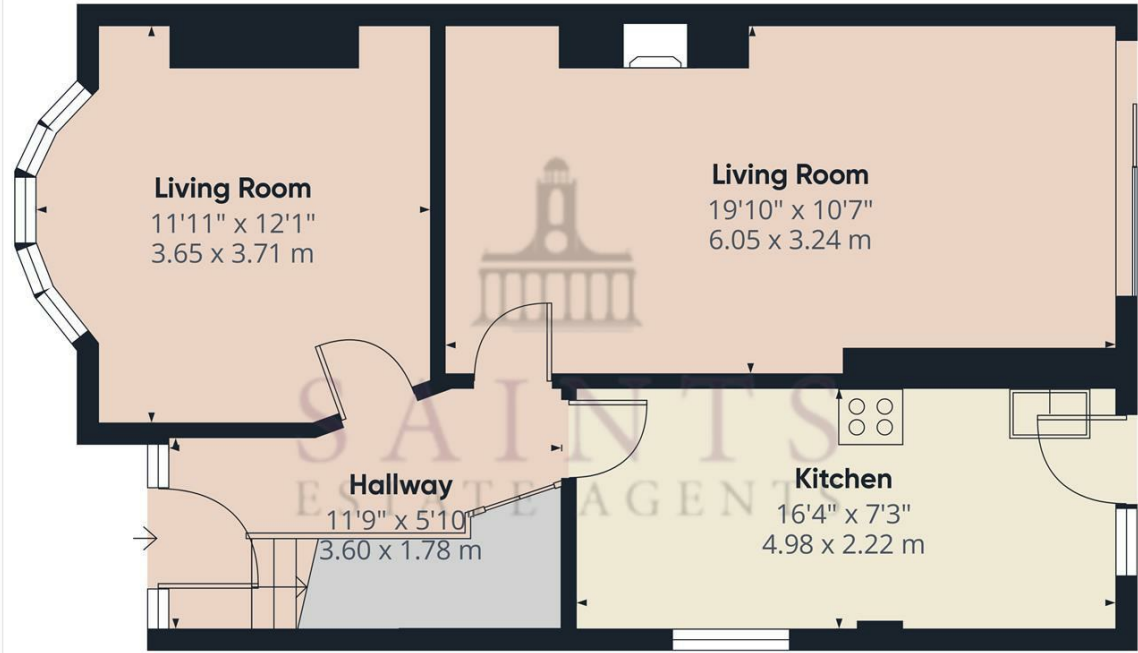

Approximate total area¹⁾
531.62 ft²
49.39 m²

(1) Excluding balconies and terraces.

While every attempt has been made to ensure accuracy, all measurements are approximate, not to scale. This floor plan is for illustrative purposes only.

Calculations are based on RICS IPMS 3C standard.

GIRAFFE360



20 Mayfield Road, Northampton, NN3 2RE

Offers in the region of £349,995

- Extended Three Bedroom
- Garage
- Downstairs Cloakroom
- Popular Location
- Double Glazed Windows Throughout
- Semi Detached
- Spacious Rear Garden
- Block Paved Driveway For Several Cars
- Gas to Radiator Central Heating
- MUST BE VIEWED

20 Mayfield Road, Northampton NN3 2RE

This extended three-bedroom semi-detached home offers a fantastic opportunity for families or individuals seeking comfortable living in a popular location. The property features a spacious rear garden, perfect for outdoor activities and entertaining. A block-paved driveway provides ample parking for several cars, complemented by a garage for additional storage or vehicle use.

The ground floor includes a convenient downstairs cloakroom, enhancing practicality. Inside, the house benefits from gas-to-radiator central heating and double-glazed windows throughout, ensuring warmth and energy efficiency.

Situated in a sought-after area, this home combines modern conveniences with a welcoming design, making it an excellent choice for those looking to settle in a well-connected and desirable neighbourhood.

 3

 2

 null



Council Tax Band: C



- Hall

Double glazed door leading to hallway, stairs rising to first floor landing, door to rooms.
- Dining Room

Double glazed leaded light bay window to front, radiator, feature fireplace, laminate flooring.
- Lounge

Double glazed sliding door to rear, feature fireplace with wood surrounding, laminate flooring.
- Downstairs Cloakroom

Low level WC and handbasin (Situating under the stairs).
- Kitchen

Range of eye and base units with work surfaces all over, double glazed windows to rear, double glazed door to rear, double oven, electric hob with extractor fan, sink with mixer taps.
- First Floor Landing

Door to all rooms, loft hatch part boarded.
- Bedroom 1

Laminate flooring, double glazed bay window to front, radiator.
- Bedroom 2

Laminate flooring, double glazed window to rear, radiator.
- Bedroom 3

Double glazed window to front, carpeted, radiator.
- Front Garden

Several cameras for security purposes, block paved driveway providing off road parking for several vehicles going to garage.
- Rear Garden

Part paved patio area, two sheds, sun room with power and light, mainly laid to lawn, fenced to sides, gated access to sides.