

DURDEN & HUNT

INTERNATIONAL



Foxglove Gardens, Wanstead E11

£725,000

- Sought After Location
- Modern Kitchen With Integrated Appliances
- Primary Bedroom With En Suite
- Excellent Transport Links
- Lounge And Dining Room
- Two Additional Bedrooms
- Garden
- Downstairs WC
- Family Bathroom

1 High Street, Wanstead, E11 2AA
0208 150 7574

wanstead@durdenandhunt.co.uk
<https://www.durdenandhunt.co.uk/>

Foxglove Gardens

Approx. Gross Internal Area 924 Sq Ft - 85.84 Sq M

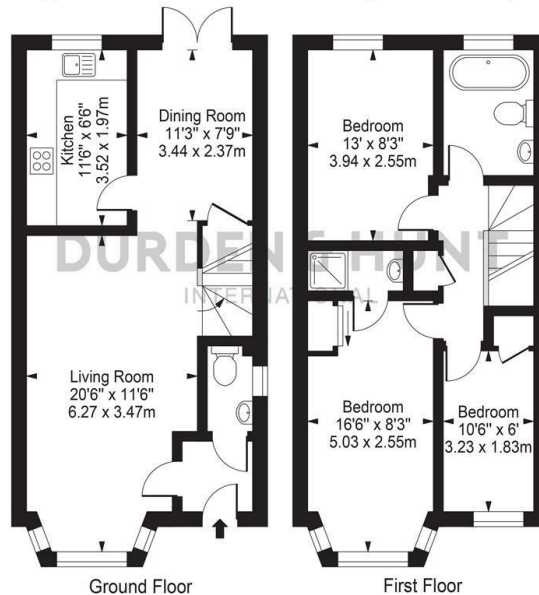

For Illustration Purposes Only - Not To Scale

This floor plan should be used as a general outline for guidance only and does not constitute in whole or in part an offer or contract. Any intending purchaser or lessee should satisfy themselves by inspection, searches, enquiries and full survey as to the correctness of each statement. Any areas, measurements or distances quoted are approximate and should not be used to value a property or be the basis of any sale or let.

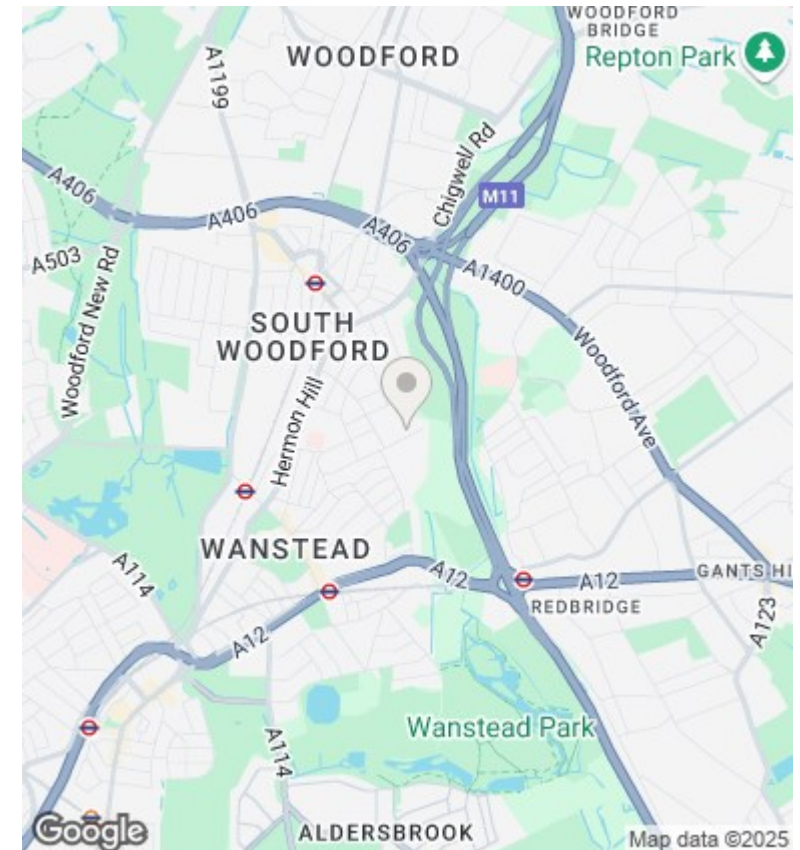

Viewings

Viewings by arrangement only. Call 0208 150 7574 to make an appointment.

Council Tax Band

E

EPC Rating:

C

Energy Efficiency Rating		
	Current	Potential
Very energy efficient - lower running costs		
(92 plus) A		85
(81-91) B		
(69-80) C	72	
(55-68) D		
(39-54) E		
(21-38) F		
(1-20) G		
Not energy efficient - higher running costs		
England & Wales	EU Directive 2002/91/EC	