

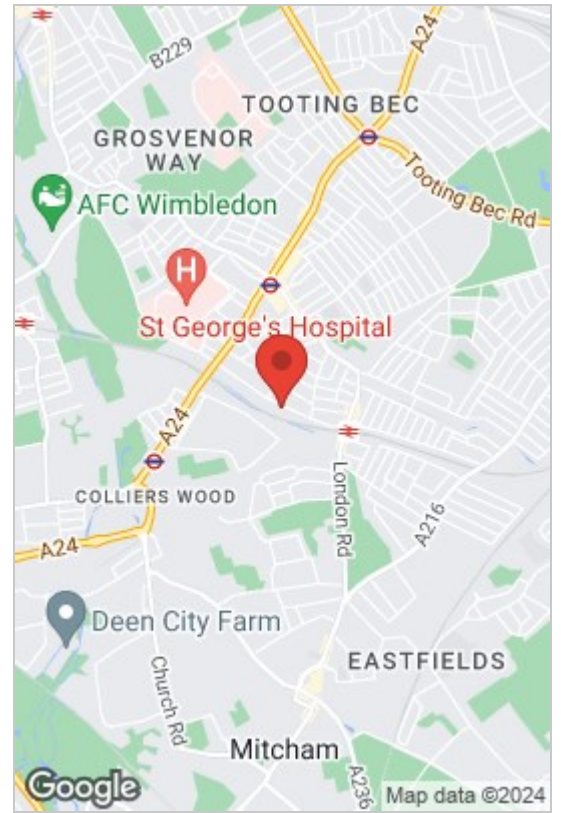

Longley Road, London, SW17 9LH
£2,650 Per Calendar Month

 3  1  1  D

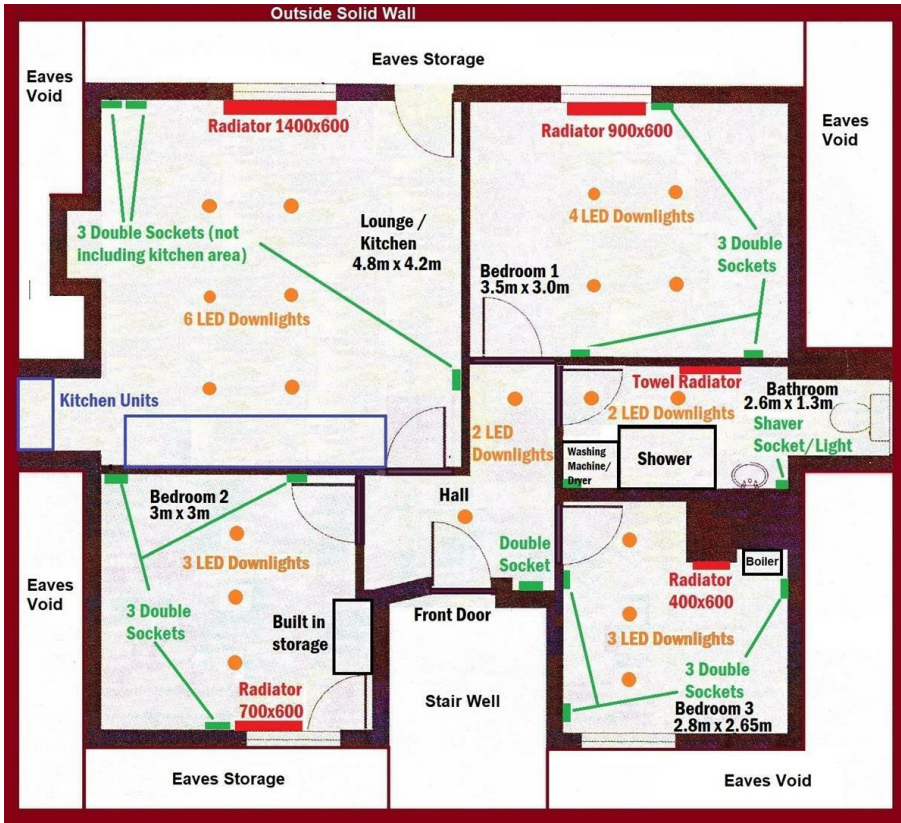



- Two Large Doubles
- Newly Refurbished Bathroom
- Excellent Location
- Newly Refurbished Kitchen
- Top Floor
- Pyrolytic (self-cleaning) Oven

Fabulous top floor three bedroom flat which has been fully modernised. There are two good size double bedrooms one with a built in wardrobe, and a further a large single. Large newly fitted kitchen/living room, integrated fridge freezer and slimline dishwasher, built in oven and induction hob and plenty of storage. Newly fitted shower room with walk in shower and heated towel rail, cupboard housing washing machine and tumble dryer. Gas central heating, double glazed windows and laminated wood flooring. Located within walking distance of Tooting High Street with multiple shopping outlets and between Colliers Wood and Tooting Broadway Northern Line Tube Stations. Tooting main line station and St Georges Hospital are also within walking distance. EARLY VIEWING ESSENTIAL.



Council Tax Band: C

Energy Efficiency Rating			Environmental Impact (CO ₂) Rating		
Very energy efficient - lower running costs	Current	Potential	Very environmentally friendly - lower CO ₂ emissions	Current	Potential
(92 plus) A			(92 plus) A		
(81-91) B			(81-91) B		
(69-80) C			(69-80) C		
(55-68) D			(55-68) D		
(39-54) E			(39-54) E		
(21-38) F			(21-38) F		
(1-20) G			(1-20) G		
Not energy efficient - higher running costs			Not environmentally friendly - higher CO ₂ emissions		
England & Wales	EU Directive 2002/91/EC		England & Wales	EU Directive 2002/91/EC	

These particulars, whilst believed to be accurate are set out as a general outline only for guidance and do not constitute any part of an offer or contract. Intending purchasers should not rely on them as statements of representation of fact, but must satisfy themselves by inspection or otherwise as to their accuracy. No person in this firm's employment has the authority to make or give any representation or warranty in respect of the property.