





## Barnes Way, Manor Park, Dorchester

Offers Over £500,000

4 2 4





Located in the ever-popular Manor Park area, this beautifully presented and thoughtfully extended four-bedroom semi-detached home offers flexible living across three floors—ideal for families, home-workers, and those who love to entertain.

Set back from the road, the property features a private driveway, garage with power, and a bright sunroom entrance leading into a lovely courtyard-style garden.

The well-equipped kitchen/breakfast room includes solid ash wood units and underfloor heating, while a spacious utility area with walk-in shower and additional storage links the house to the garage and rear garden.

At the heart of the home is a stunning open-plan living space, including a sitting room with multi-fuel burner, and generous dining and family areas—all with individually zoned underfloor heating and garden access.

Upstairs, you'll find three bedrooms (two doubles and a single/office) with fitted wardrobes and a luxurious family bathroom. The top floor is home to a generous master bedroom with Velux windows and far-reaching views.

Outside, the extended rear garden features decking, a large shed, and low-maintenance landscaping. The home also benefits from a hardwired alarm system, smoke/CO detectors, and gas central heating.

All set within a peaceful, family-friendly location just a short walk from Dorchester town centre, train stations, and top local schools.





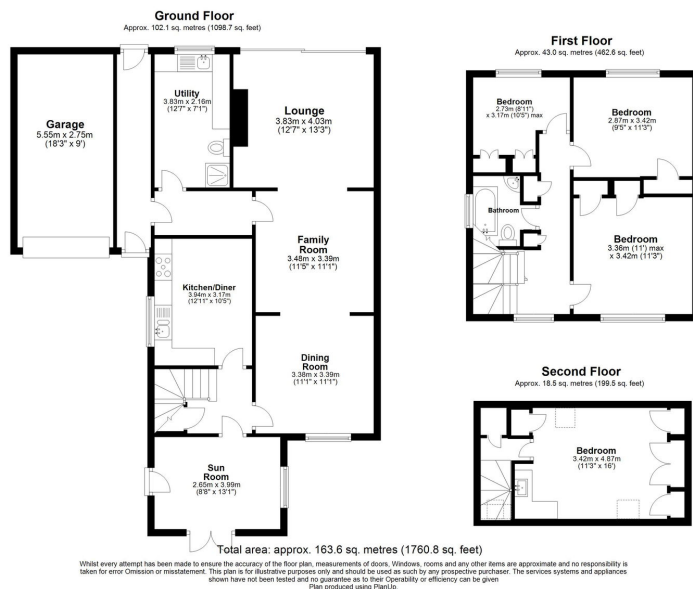

- Sought-after Manor Park location
- Driveway and single garage with power and light
- Extended living spaces including sun room and utility
- Extended to include three open plan reception rooms
- Underfloor heating
- Far-reaching views from the Master bedroom
- Multi-fuel burner and flexible open-plan layout
- Four bedrooms (three doubles) across three floors
- Landscaped rear garden and front Sun Terrace
- Vendor suited

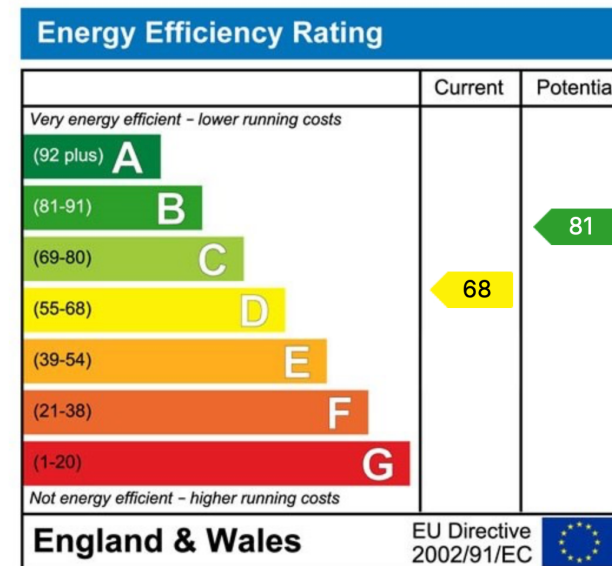

“A bespoke Estate Agency offering great customer service and communication”

Tel 020 4587 7347  
www.max25.co.uk

