



Culliford Road North, Dorchester, DT1 1US

Guide Price £130,000

🛏 1 🚿 1 🚗 1



Culliford Court is a charming development with 46 one and two-bedroom self-contained retirement apartments for those aged 55 and over.

Built by McCarthy & Stone in 2006/7, Culliford Court ensures peace of mind, comfort, and independence. It is set within expansive communal gardens and is conveniently located near the town's amenities.

Entry to this friendly community is via an entry phone system, leading to a popular residents' lounge with its own kitchen. It's perfect for entertaining family and friends or joining organized events. The community life is vibrant and inclusive.

This apartment, tucked away at the back of the building, offers a modern and fresh feel with views of the well-kept garden. The entrance hall leads to a sitting room with a dining area, featuring a large window that frames the garden view. The cosy reception room includes an electric fireplace and space for a dining table and chairs.

Twin glazed doors open to the kitchen, filled with natural light from a garden-view window. The kitchen has ample storage and food preparation space, with integrated AEG™ appliances, including an electric hob, fume hood, and electric oven. There's also space for a fridge and an additional appliance with plumbing.

The bedroom overlooks the communal gardens and features a double-glazed window, built-in wardrobes, an electric storage heater, a telephone point, a TV socket, an emergency pull cord, and a door to the entrance hall. The shower room includes a W.C. with a concealed cistern, a vanity unit with a wash hand basin, and a large shower cubicle with a screen.

Outside: Residents can enjoy the lounge, laundry room with washing machines and dryers, and a guest room (by reservation). The landscaped gardens and seating areas are perfect for residents and their families, with well-kept lawns, stocked borders, mature trees, and shrubs.



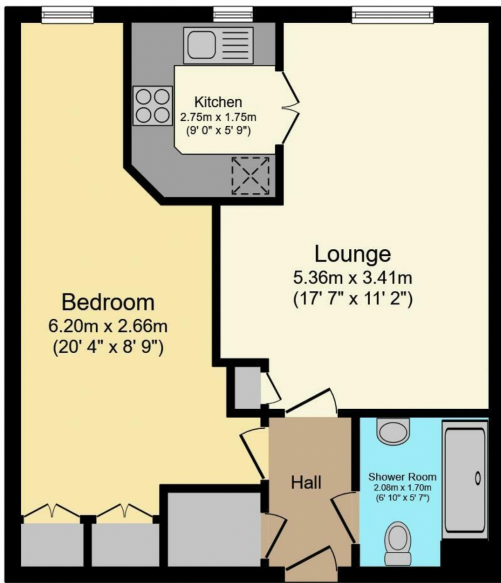

- One Bedroom First Floor Apartment
- Bright And Spacious
- Guest suite
- Communal gardens & Car Park
- Minimum Age 55
- Mobility scooter store
- Set in a highly sought after retirement complex
- Lease: 125 years from 2006

