



2 Bed
House - Terraced
located in

Asking price £450,000



fairoaks

GROUND FLOOR
422 sq.ft. (39.2 sq.m.) approx.

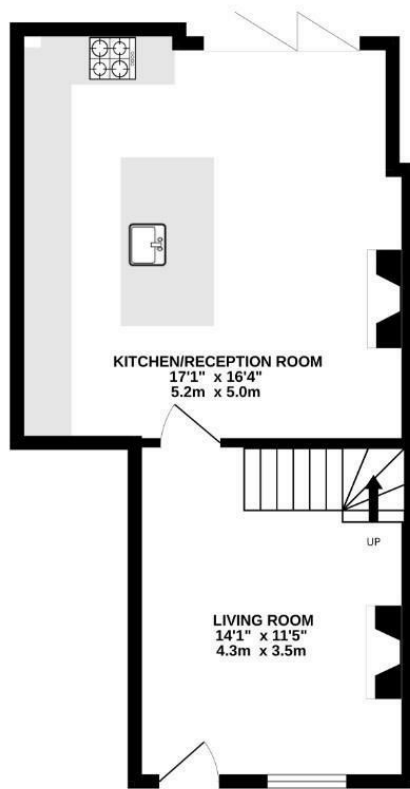

1ST FLOOR
360 sq.ft. (33.5 sq.m.) approx.

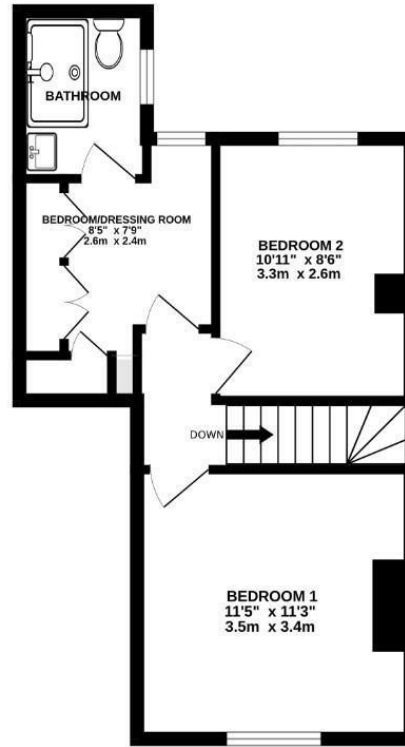

TOTAL FLOOR AREA: 782 sq.ft. (72.7 sq.m.) approx.

Whilst every attempt has been made to ensure the accuracy of the floorplan contained here, measurements of doors, windows, rooms and any other items are approximate and no responsibility is taken for any error, omission or mis-statement. This plan is for illustrative purposes only and should be used as such by any prospective purchaser. The services, systems and appliances shown have not been tested and no guarantee as to their operability or efficiency can be given.
Made with Metropix ©2024

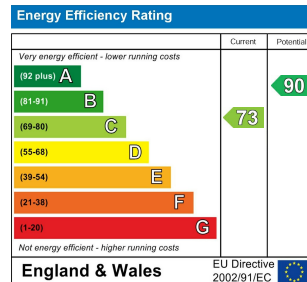

DIRECTIONS

Located in the picturesque town of Westerham, this cottage is within walking distance of local amenities, boutique shops, and delightful cafes. With its period features, comfortable living spaces, and enchanting garden, this property is a rare find and a perfect place to call home. Don't miss the opportunity to experience the charm and character of this exquisite cottage.

CONTACT

Nicholson House Thames Street
Weybridge
Surrey
KT13 8JG

E: jamie@fairoaksgroup.co.uk
T: 07969 282 159



fairoaks