



萊英家
Let **UK** Home

2 Bedrooms

Flat

Located in London

£6,000 Per Month



info@letukhome.co.uk

<https://www.letukhome.co.uk/>

02045348146



17 Watermark House 10 Salutation Gardens

London | | WC1X 0EA



Let UK Home are excited to offer this spectacular two bedroom apartment in the heart of Watermark House part of the Postmark.

This property comprises a large bright open plan kitchen and living room leading to a large private balcony with great views, two double bedrooms with fitted wardrobes (master en-suite), a large family sized bathroom and ample storage.

Five-star luxury facilities 24-hour VIP concierge service, private living room, cinema, rooftop terrace and bar, gym, sauna, treatment room, luxury swimming pool, spa.

The area surrounding the development is dotted with places of great historical and cultural interest, including Farringdon and Clerkenwell that retain medieval architecture, the renovated and vibrant King's Cross central business district, the academically-rich Chancery Lane, and the East London Tech City on Old Street, which is comparable to Silicon Valley in the United States. In addition, a number of must-see cultural attractions such as the British Museum, British Library and Barbican Center are just a stone's throw away from the project.

17 Watermark House 10 Salutation Gardens

£6,000 Per Month

- 5th Floor
- 24h Security
- The Gym
- Concierge Service
- Swimming Pool



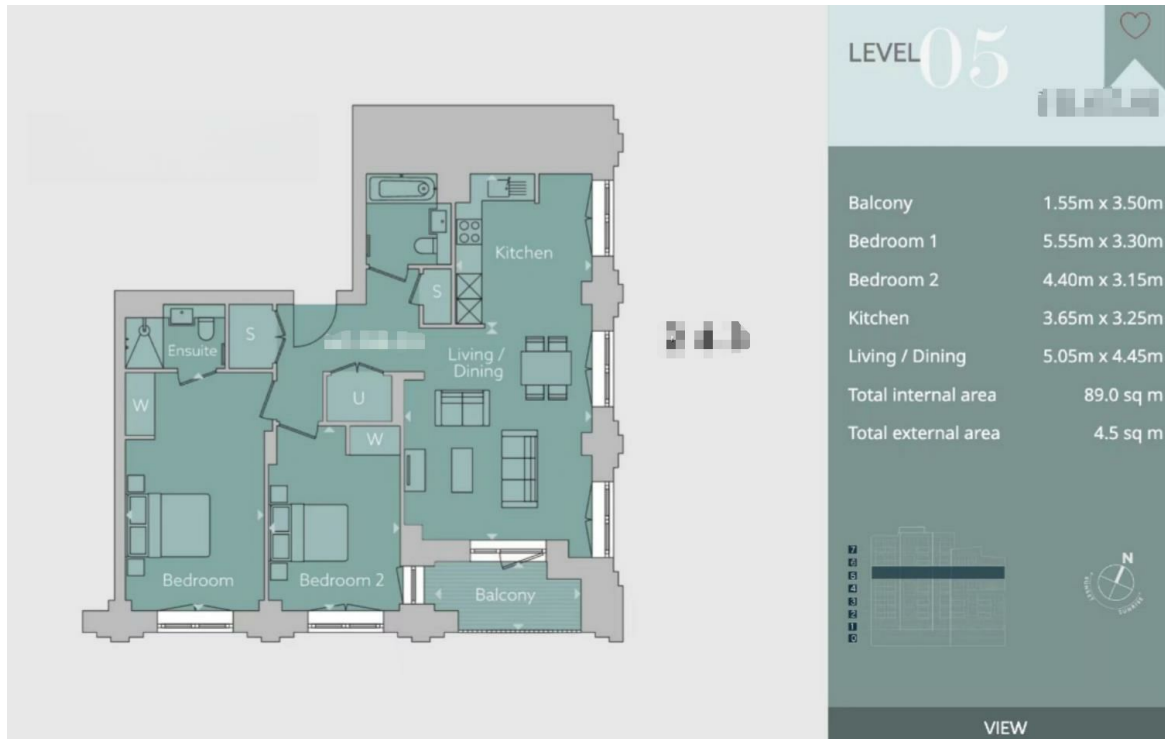

萊英家
Let **UK** Home

6/F Two Kingdom Street
London
W2 6BD

02045348146

info@letukhome.co.uk

Council Tax Band: New Build

Local Authority:

Agents Note: Whilst every care has been taken to prepare these particulars, they are for guidance purposes only. All measurements are approximate and are for general guidance purposes only and whilst every care has been taken to ensure their accuracy, they should not be relied upon and potential buyers/tenants are advised to recheck the measurements.

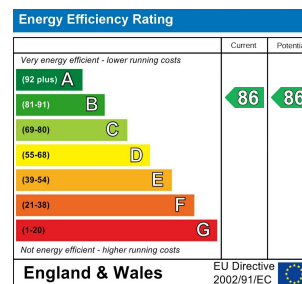

<https://www.letukhome.co.uk/>