

Leslie's Place, Plot 1 Victoria Street, Ventnor, PO38 1ES

Asking Price £465,000

EPC Rating: Council Tax Band:

ELLIOTT
LINCOLN
ESTATE AGENTS & ASSOCIATES

Reassuringly familiar, refreshingly new



Located in the picturesque seaside town of Ventnor, this beautifully designed end of terrace four-bedroom townhouse offers modern living across three spacious floors. Part of an exclusive new development of just six terrace homes, this property combines high-spec finishes with the charm of coastal living.

Call or WhatsApp: 01983 642622
office@elliottlincoln.co.uk
www.elliottlincoln.co.uk

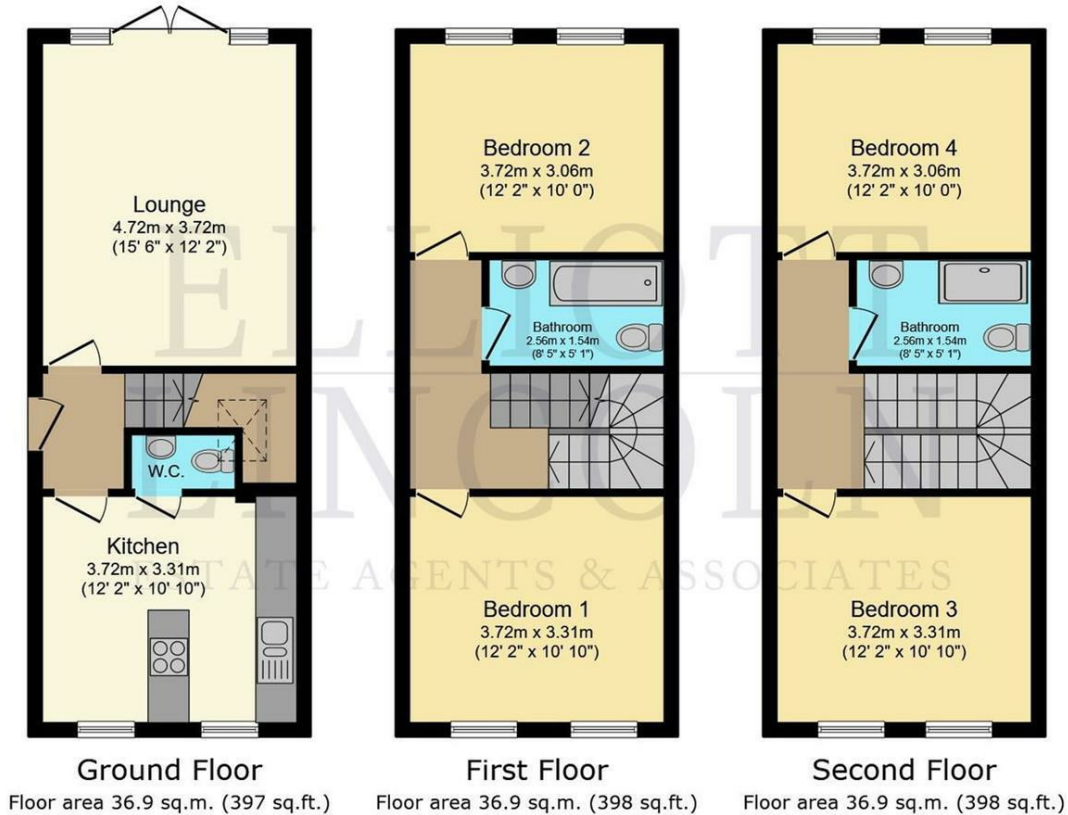

Total floor area: 110.7 sq.m. (1,192 sq.ft.)

This floor plan is for illustrative purposes only. It is not drawn to scale. Any measurements, floor areas (including any total floor area), openings and orientations are approximate. No details are guaranteed, they cannot be relied upon for any purpose and do not form any part of any agreement. No liability is taken for any error, omission or misstatement. A party must rely upon its own inspection(s). Powered by www.Propertybox.io

Energy Efficiency Rating		
	Current	Potential
Very energy efficient - lower running costs		
(92 plus) A		
(81-91) B		
(69-80) C		
(55-68) D		
(39-54) E		
(21-38) F		
(1-20) G		
Not energy efficient - higher running costs		
England & Wales		EU Directive 2002/91/EC