



Silver Sands Court, Bembridge.

Offers in the Region of **£265,000**

Possibly the best location in this sought after development. A one-bedroom apartment enjoying a private patio overlooking the gardens and with direct access to the pavement and village.

Bedrooms: 1 | Bathrooms: 1 | Receptions: 1

Call or WhatsApp: 01983 642622
Email: office@elliottlincoln.co.uk
Web: elliottlincoln.co.uk

**ELLIOTT
LINCOLN**
ESTATE AGENTS & ASSOCIATES

Tenure: Leasehold

Property Type: Ground Floor Flat

Bedrooms: 1 | **Bathrooms:** 1 | **Receptions:** 1

- See Full Video Tour
- Over 60's
- Triple Glazing & Underfloor Heating
- Ground Floor
- Private Secure Entrance
- Very Good Condition
- Parking Available TBC with Management
- Well Maintained Development
- Communal Gardens
- Chain Free

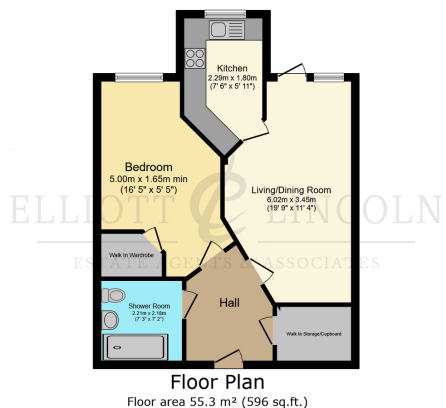

TOTAL: 55.3 m² (596 sq.ft.)

This floor plan is for illustrative purposes only. It is not drawn to scale. Any measurements, floor areas (including any total floor area), openings and orientations are approximate. No details are guaranteed. They cannot be relied upon for any purpose and do not form any part of any agreement. No liability is taken for any error, omission or misstatement. A party must rely upon its own inspection(s). Powered by www.PropertyBox.io