

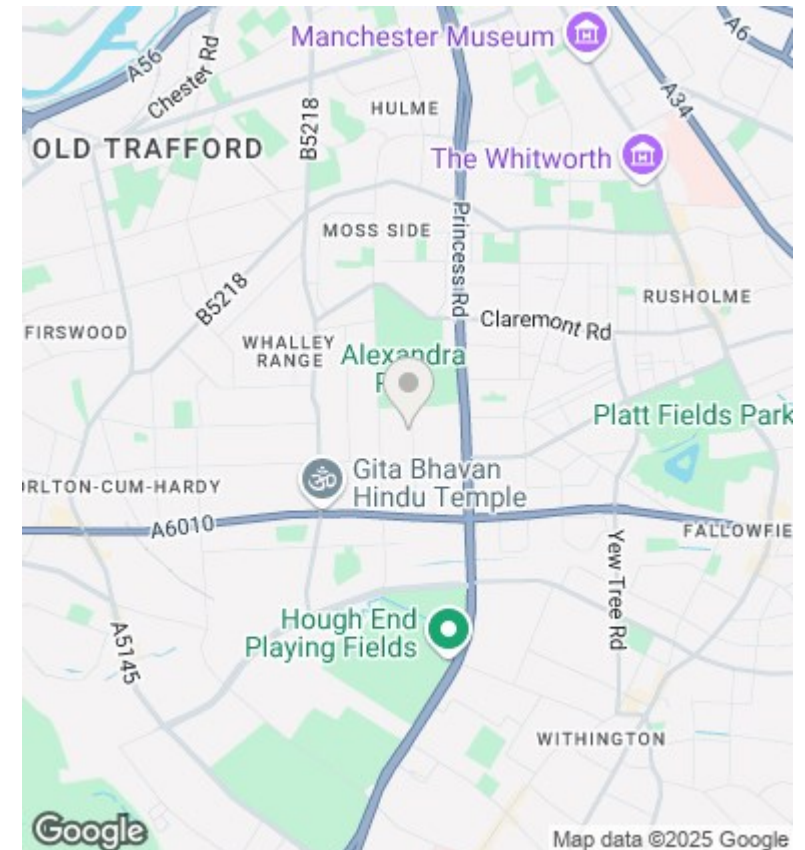

4 Manley Road, Manchester, M16 8PN

Offers Over £675,000

- 5 newly refurbished separate one-bedroom flats
- Freshly painted and new carpets throughout
- Ideal for Investors , Haste free Income
- Nearby healthcare: The Alexandra Practice NHS GP, The Range Medical Centre
- All Flats are let for £48 K Annually by Single tenant
- Gas central heating in all flats
- Close to top schools: William Grammar, KD Grammar, Whalley Range
- Modern kitchens with brand-new cookers
- Council Tax Band A (affordable)
- Regular Rent £4k Per month

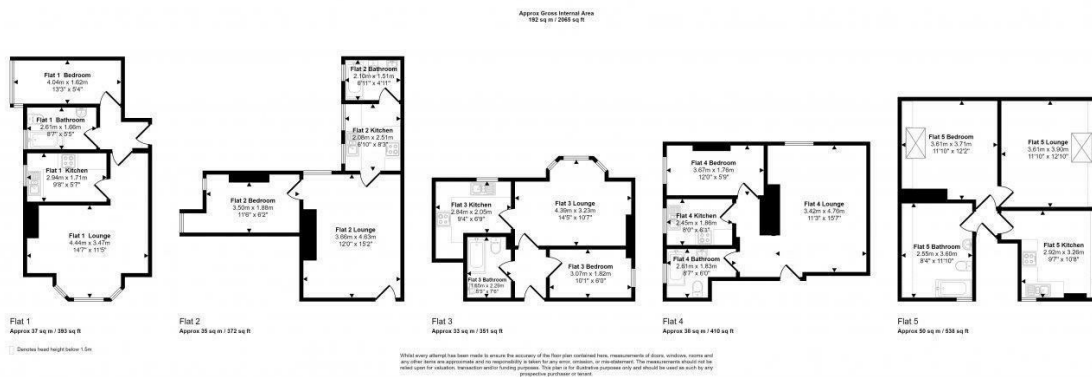

Directions

Viewings

Viewings by arrangement only. Call 0161 804 3480 to make an appointment.

Council Tax Band

EPC Rating:

Energy Efficiency Rating		
	Current	Potential
Very energy efficient - lower running costs		
(92 plus) A		
(81-91) B		
(69-80) C		
(55-68) D		
(39-54) E		
(21-38) F		
(1-20) G		
Not energy efficient - higher running costs		
England & Wales	EU Directive 2002/91/EC	