

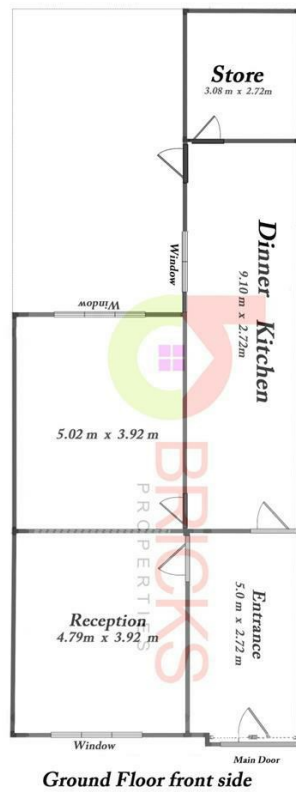

## 215 Northmoor Road, Manchester, M12 5RU

£2,475 Per Calendar Month

- 5 Bed Semi-Detached house
- Three stylish bathrooms and a separate W/C
- Perfect for larger families
- Tax Band C. EPC rating E
- 2 Spacious Reception Rooms
- Large back yard with a separate en suite room
- Situated opposite Crowcroft Park
- Modern kitchen with dining area and tiled flooring
- Private driveway to the front with generous parking capacity
- School catchment area. Crowcroft Park Primary School, Stanley Grove Primary Academy.



## Directions

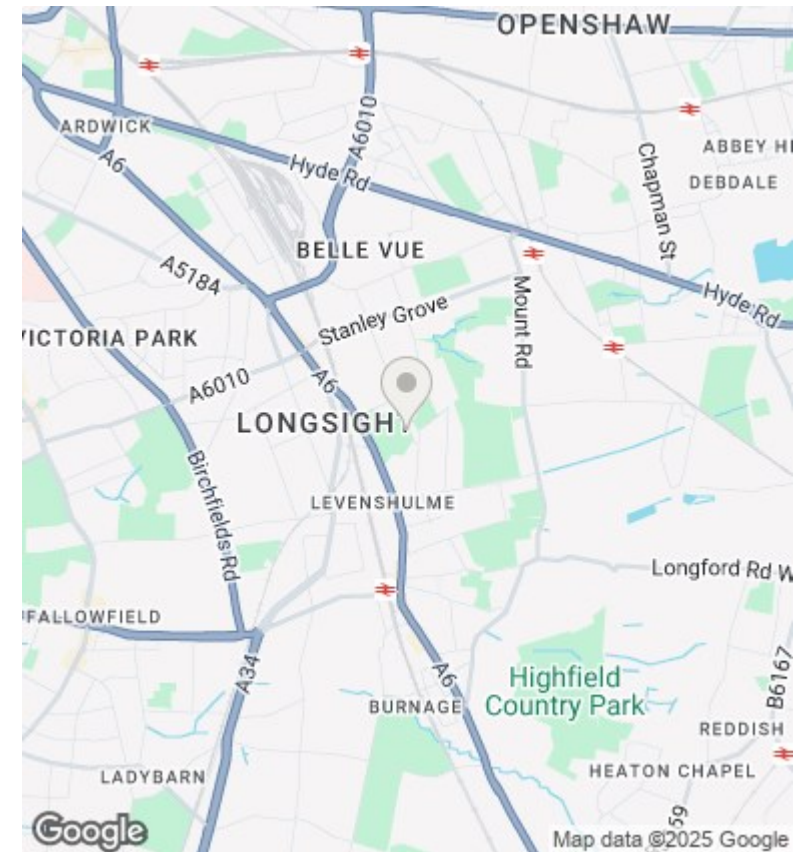

## Viewings

Viewings by arrangement only. Call 0161 804 3480 to make an appointment.

D

E