

Kensington Gate

Worcester

Rushwick, Worcester, WR2 5LE

Kensington Gate is a brand new development consisting of 2 and 3 bedroom homes in Worcester.



whg are pleased to offer the next phase of properties available for Shared Ownership

Key Features

Kitchen

- Modern fitted kitchen with oven hob & extractor
- Vinyl flooring

Bathroom

- Modern white suite with shower over bath and shower screen
- Vinyl flooring

General

- Turfed rear garden
- Excellent transport links to Worcester, Birmingham, Hereford, Gloucester & Cheltenham
- M5 just under 5 miles away

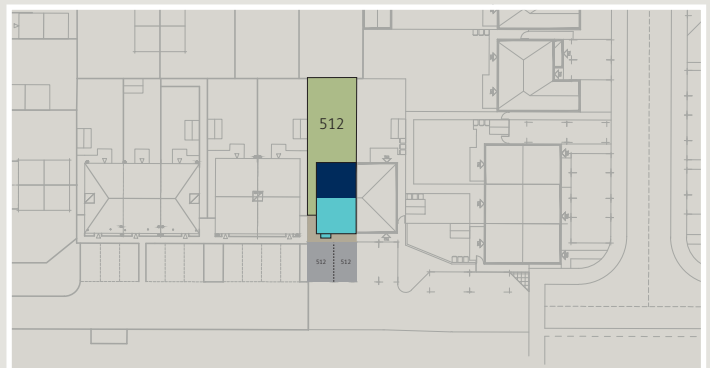

Site plan

The Tavy
2 Bed Semi-Detached House
Plot 512

For further information contact the Sales Team
📞 0300 555 6666 @sales@whgrp.co.uk

The Tavy

Plot 512

2 bedroom Semi-Detached House

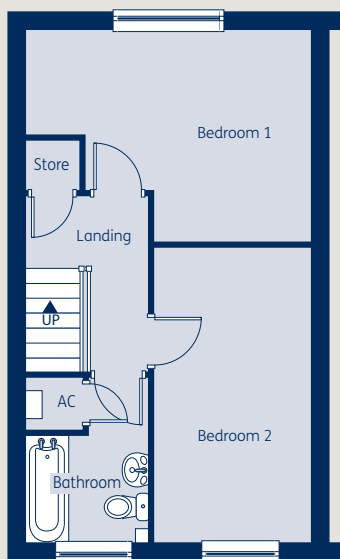
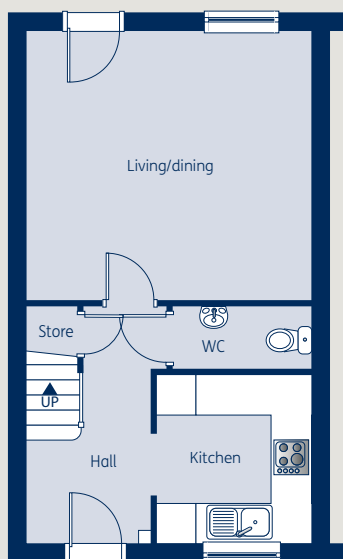

Ground Floor

Kitchen	2.73m x 2.55m	8'11" x 8'4"
Living/dining	4.66m x 4.36m	15'4" x 14'4"

First Floor

Bedroom 1	4.66m x 3.47m	15'3" x 11'4"
Bedroom 2	4.76m x 2.59m	15'8" x 8'6"
Bathroom	2.01m x 1.74m	6'7" x 5'9"

Total Floor Area: 77.07m² - 829.55 sq.ft

Room dimensions shown above are maximum approximate dimensions and given as a guide only. These should not be used as a basis for purchasing flooring or furniture. whg reserves the right to alter plans, specification, position of doors and windows and change tenure subject to demand without prior notice. Please ask your Sales Consultant for current information when reserving your new home. Information correct at time of going to print.

The Tavy 2 Bedroom Semi-Detached House		Full Market Value	40% Share Value	40% Monthly Rent Amount
Plot 512	27 Leasowe Place, Rushwick, Worcester, WR2 5LE.	£277,500	£111,000	£381.56