



Your Logo

31 Rayfield Close, Barnston

£375,000

3 2 1



- No onward chain
- Ideal for first time buyers and families
- Open-planned living
- South-west facing rear garden
- Immaculately presented
- Three double bedroom semi-detached house
- Sought after village location
- Driveway for three vehicles
- Planning permission for single storey rear extension
- Countryside walks on your doorstep



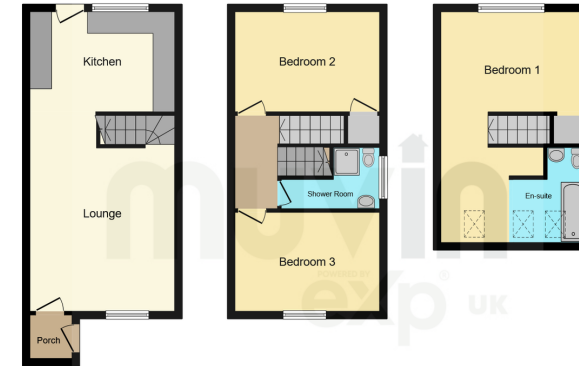

Ground Floor
Floor area 34.9 m² (375 sq.ft.)

First Floor
Floor area 33.3 m² (359 sq.ft.)

Second Floor
Floor area 25.7 m² (277 sq.ft.)

TOTAL: 93.9 m² (1,011 sq.ft.)

This floor plan is for illustrative purposes only. It is not drawn to scale. Any measurements, floor areas (including any total floor area), openings and orientations are approximate. No details are guaranteed, they cannot be relied upon for any purpose and do not form any part of any agreement. No liability is taken for any error, omission or misstatement. A party must rely upon its own inspection(s). Powered by www.Propertybox.io

OFFERING NO ONWARD CHAIN

Set in the ever popular village of Barnston is this three double bedroom, semi-detached house, boasting open planned living, ample off street parking and within a stones throw away from the picturesque Essex countryside.

