



Your Logo

Flat 9, Fullers Court, Railway Street,

Offers Over £190,000

🛏 2 🚿 1 🛋 1

- Two bedrooms
- Ideal for first time buyers
- Allocated off road parking
- Five minute walk to train station
- Open planned living space
- Top floor apartment
- Spacious lounge and kitchen areas
- Walking distance to Braintree town centre
- Communal garden



****IDEAL FOR FIRST TIME BUYERS AND INVESTORS****

Located within walking distance to Braintree town centre and the train station, this two bedroom top floor apartment has an open planned living space and benefits from allocated parking.



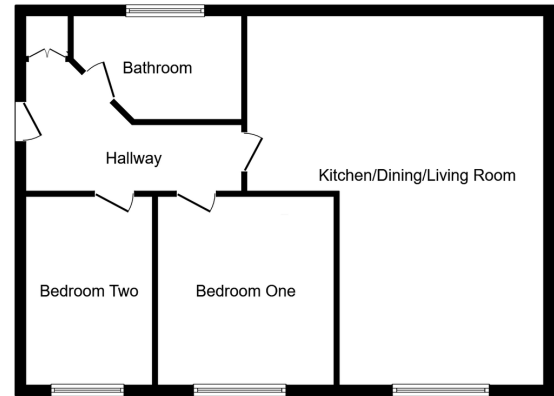

Floor Plan

This floor plan is for illustrative purposes only. It is not drawn to scale. Any measurements, floor areas (including any total floor area), openings and orientations are approximate. No details are guaranteed, they cannot be relied upon for any purpose and do not form any part of any agreement. No liability is taken for any error, omission or misstatement. A party must rely upon its own inspection(s). Powered by www.Propertybox.io

