



Willow Crescent, Cuerden Residential Park, Leyland, Lancashire, PR25 5PB

£135,000

🛏 2 🚿 1 🛋 1



- Superb two-bedroom park home bungalow
- Located on a generous plot within Cuerden Residential Park
- Modern fitted kitchen with integrated appliances
- Stylish, luxury refitted shower room
- Private driveway and useful external storage
- Beautifully refurbished to a high standard throughout
- Bright and spacious lounge/dining room
- Two well-proportioned bedrooms
- Attractive, low-maintenance gardens with seating areas
- Popular residential park with excellent access to Leyland and transport links



A superbly presented and thoughtfully refurbished two-bedroom park home bungalow, occupying a generous plot on the popular Cuerden Residential Park in Leyland. The accommodation briefly comprises a bright lounge/dining room, modern fitted kitchen with integrated appliances, two well-proportioned bedrooms and a stylish refitted shower room. Externally, the property benefits from well-maintained, low-maintenance gardens which provide a great deal of outside space, private driveway and useful external storage.

Ideally located for access to Leyland town centre, local amenities and transport links, this excellent home is ready to move straight into. Early viewing is highly recommended.

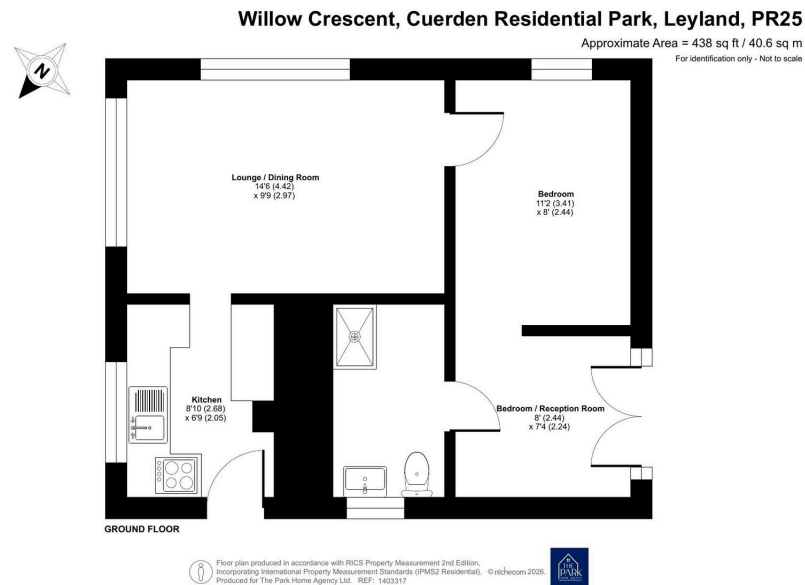

01793 230185
sales@theparkhomeagency.co.uk

Agents Notes: All measurements are approximate and quoted in metric with imperial equivalents and for general guidance only and whilst every attempt has been made to ensure accuracy, they must not be relied on. The fixtures, fittings and appliances referred to have not been tested and therefore no guarantee can be given that they are in working order. Internal photographs are reproduced for general information and it must not be inferred that any item shown is included with the property. For a free valuation, contact the numbers listed on the brochure