



Foxglove Crescent, Meadowlands Court, Poundstock, Bude, Cornwall, EX23 0FE

£185,000

🛏️ 2 🚿 2 🛋️ 1



- Detached Park Home Bungalow
- Two Double Bedrooms
- Ensuite and Guest Bathroom
- Kitchen With Integrated Appliances
- Driveway To The Side
- Well Presented Throughout
- OMAR Accent 40'x20'
- Spacious Lounge/Dining Area
- Gardens To All Sides
- No Stamp Duty To Pay



A well-presented two bedroom Omar Accent 40' x 20' park home bungalow offering spacious open-plan lounge and dining accommodation with vaulted ceilings, a modern fitted kitchen with integrated appliances, two generous double bedrooms both with built in wardrobes and the master bedroom having a stylish and spacious ensuite shower room. The property further benefits from attractive low-maintenance outdoor space and off-road parking, and is situated within this popular residential park near Bude on the Cornish coastline. Early viewing is highly recommended.

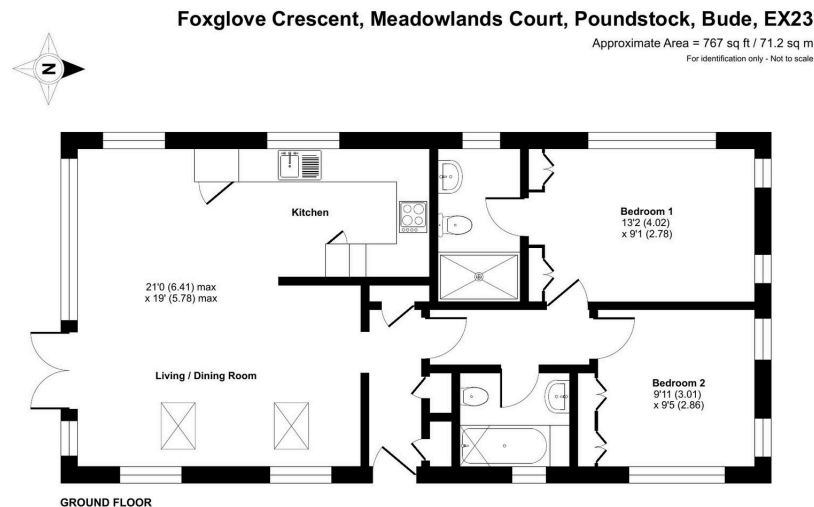

Floor plan produced in accordance with RICS Property Measurement 2nd Edition, incorporating International Property Measurement Standards (IPMS Residential). © richvecom 2020. Produced for The Park Home Agency Ltd. REF: 1456072



01793 230185
sales@theparkhomeagency.co.uk

Agents Notes: All measurements are approximate and quoted in metric with imperial equivalents and for general guidance only and whilst every attempt has been made to ensure accuracy, they must not be relied on. The fixtures, fittings and appliances referred to have not been tested and therefore no guarantee can be given that they are in working order. Internal photographs are reproduced for general information and it must not be inferred that any item shown is included with the property. For a free valuation, contact the numbers listed on the brochure