



Mytchett Farm Park, Mytchett Road, Mytchett, GU16 6AB

£150,000

3 1 1



- Detached Park Home Bungalow
- Three Bedrooms
- Gas Central Heating
- Wet Room/Shower Room
- End Of Chain Sale
- Generous Plot
- Lounge Measuring Over 17ft
- Wonderful Rear Garden Area
- Residential Park For The Over 45's
- CASH BUYERS ONLY!



A charming two/three bedroom detached park home bungalow (30'x20') located on a generous plot on the outskirts of this popular residential park near Camberley. This home gives off such a homely feel throughout and offers a spacious lounge and kitchen/dining room which both measure over 17ft in length, bedrooms one and two have built in wardrobes, there is a further room next to the second bedroom which can be utilised as a study, walk in wardrobe or an ensuite, and there is a useful wet room/shower room in addition to this. The rear garden, backing onto woodland offers a high level of privacy but is a gardeners delight and of a size not found on many homes on this park. A viewing is highly recommended.

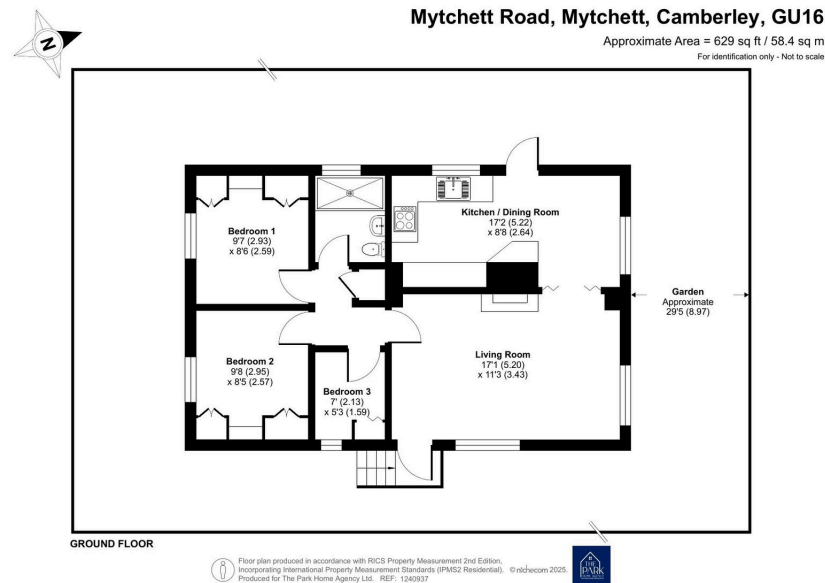

01793 230185
sales@theparkhomeagency.co.uk

Agents Notes: All measurements are approximate and quoted in metric with imperial equivalents and for general guidance only and whilst every attempt has been made to ensure accuracy, they must not be relied on. The fixtures, fittings and appliances referred to have not been tested and therefore no guarantee can be given that they are in working order. Internal photographs are reproduced for general information and it must not be inferred that any item shown is included with the property. For a free valuation, contact the numbers listed on the brochure