



# Howards Way

Moulton, Northampton

oriordanbond  
SALES & LETTINGS



GROUND FLOOR  
581 sq.ft. (54.0 sq.m.) approx.

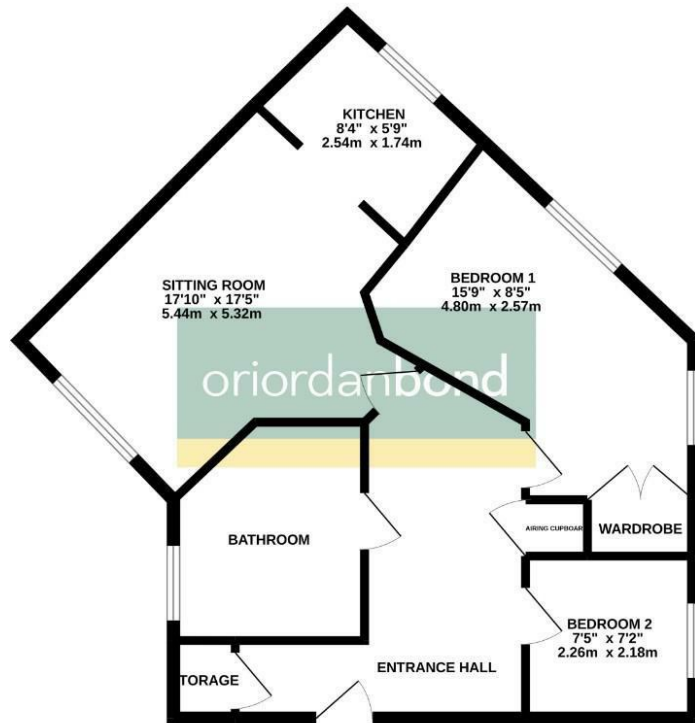

TOTAL FLOOR AREA: 581 sq.ft. (54.0 sq.m.) approx.  
While every attempt has been made to ensure the accuracy of the floorplan contained here, measurements of doors, windows, rooms and any other items are approximate and no responsibility is taken for any error, omission or misstatement. This plan is for illustrative purposes only and should be used as such by any prospective purchaser. The services, systems and appliances shown have not been tested and no guarantee as to their operability or efficiency can be given.  
Made with Metropac 03/22

## Howards Way

Moulton

NN3 6RP

OFFERS OVER £150,000

A modern first floor apartment situated on this modern estate in Moulton on the edge of Northampton. The property is offered for sale with no onward chain.

Accommodation comprises secure communal entrance, sitting/dining room, fitted kitchen with integrated appliances, two bedrooms and a bathroom. Outside are surrounding communal gardens and allocated parking for one car. Further benefits include uPVC double glazing and gas radiator heating. (B/581/-)

Leasehold Information: Lease Remaining - 109 years (as of 2024) / Ground Rent - TBC / Service Charge - TBC

### Additional information

- Council Tax Band: B
- Energy Efficiency Rating: C

### Viewing

Viewing strictly by appointment – details below

### Disclaimer

O’Riordan Bond Estate Agents Limited has not tested apparatus, equipment, fittings or services and so cannot verify they are in working order. The buyer is advised to obtain verification from their solicitor or surveyor.

O’Riordan Bond Parklands Sales  
01604 639007

parklands@oriordanbond.co.uk

