



Carey Close
Moulton, Northampton

oriordanbond
SALES & LETTINGS



Carey Close

Moulton

NN3 7SN

OFFERS OVER £325,000

A fully refurbished three bedroom semi-detached property, presented in show home condition, offered for sale with no onward chain. Located in a quiet cul-de-sac, within the heart of Moulton village, the property offers fantastic size living accommodation, off road parking and a larger than average rear garden.

This home has been finished to a very high standard and comprises entrance hall with storage, sitting room with French doors, an outstanding open plan kitchen/diner with integrated appliances, utility room, cloakroom/WC and access to the single garage. To the first floor are three good size bedrooms all with fitted wardrobes and a newly fitted, stylish three-piece family bathroom. Outside is a large, private rear garden, single garage and ample off road parking to the front. Further benefits include uPVC double glazing and gas radiator heating. (A/1193/L)

Additional information

- Council Tax Band: B
- Energy Efficiency Rating: C

Viewing

Viewing strictly by appointment – details below

Disclaimer

O'Riordan Bond Estate Agents Limited has not tested apparatus, equipment, fittings or services and so cannot verify they are in working order. The buyer is advised to obtain verification from their solicitor or surveyor.

O'Riordan Bond Parklands Sales

01604 639007

parklands@oriordanbond.co.uk

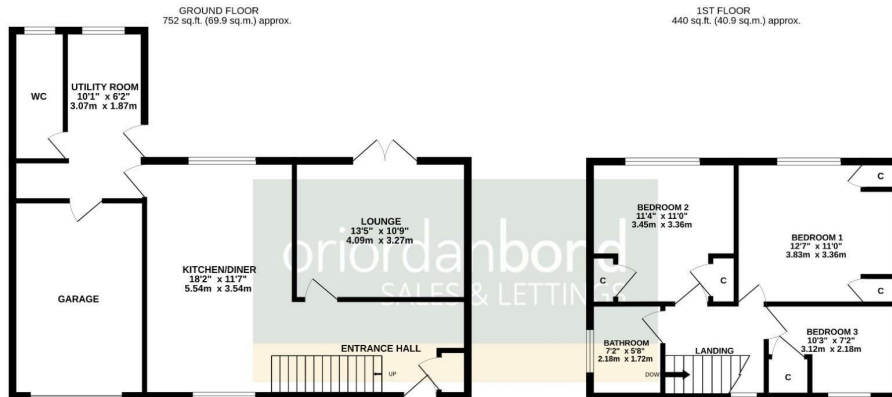

TOTAL FLOOR AREA: 1193sq.ft. (110.8 sq.m.) approx.

While every attempt has been made to ensure the accuracy of the floorplan contained here, measurements of doors, windows, rooms and any other items are approximate and no responsibility is taken for any error, omission or mis-statement. This plan is for illustrative purposes only and should be used as such by any prospective purchaser. The services, systems and appliances shown have not been tested and no guarantee as to their operability or efficiency can be given.
Made with Metropix 02024

