



**Coppice Drive**  
Parklands, Northampton

**oriordanbond**  
SALES & LETTINGS



GROUND FLOOR  
996 sq.ft. (92.5 sq.m.) approx.

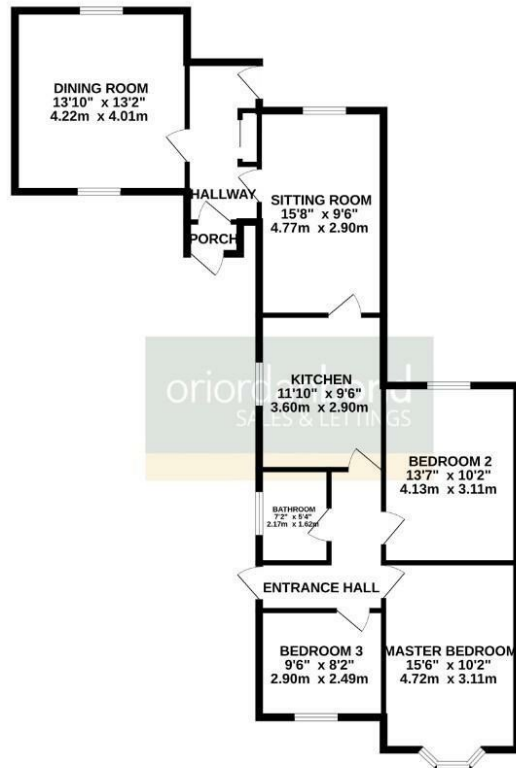

TOTAL FLOOR AREA : 996 sq.ft. (92.5 sq.m.) approx.  
Whilst every attempt has been made to ensure the accuracy of the floorplan contained herein, measurements of doors, windows, rooms and any other items are approximate and no responsibility is taken for any error, omission or misstatement. This plan is for illustrative purposes only and should be used as such by any prospective purchaser. The services, systems and appliances shown have not been tested and no guarantee as to their operability or efficiency can be given.  
Made with Hozomeq C2024.

## Coppice Drive

Parklands

NN3 6NF

GUIDE PRICE £260,000

An extended semi-detached bungalow situated in this highly sought after location within Parklands. Occupying a large and very private plot, the property requires some cosmetic updating and is offered to the market with no onward chain.

Accommodation comprises porch, entrance hall, sitting room, kitchen, large inner hall with storage, dining room/bedroom four, three further bedrooms and a refitted shower room. Outside is a front garden with block paved driveway for several vehicles leading to a single garage and a very large, private and immaculately maintained rear garden backing onto local allotments. Further benefits double glazing and electric storage heating. (C/996/XL)

### Additional information

- Council Tax Band: C
- Energy Efficiency Rating: G

### Viewing

Viewing strictly by appointment – details below

### Disclaimer

O'Riordan Bond Estate Agents Limited has not tested apparatus, equipment, fittings or services and so cannot verify they are in working order. The buyer is advised to obtain verification from their solicitor or surveyor.

O'Riordan Bond Parklands Sales

01604 639007

[parklands@oriordanbond.co.uk](mailto:parklands@oriordanbond.co.uk)

