



15 St Stephen's Street, TN9 2AB



tonbridge
property



15 St Stephen's Street, TN9 2AB

Description

Located in South Tonbridge and only moments away from the High Street and the local amenities, as well as just a short walk from Tonbridge railway station, is this well-presented charming end of terrace, two bedroom period property.

Arranged over two floors, the property comprises a good-sized living room, kitchen diner, first floor bathroom, two well-proportioned bedrooms and an easy to maintain rear garden. The property has been modernised and maintained to an excellent standard by

the current vendor and it also comes with the added benefit of a workshop to the rear of the property.

St Stephen's Street is extremely well located for access to nearby schools and the A21 and A26, and with the station only moments away, it means that commuting to London is effortless.

AGENT'S NOTE:

We understand from our seller that a pedestrian right of way exists for the adjoining property. Please refer to the Material Information pack for further information.





Overview

- Central Tonbridge Location
- End Of Terrace
- Two Bedroom Period Cottage
- Good Size Eat-in Kitchen
- First Floor Bathroom
- Easy To Maintain Garden
- No Onward Chain
- Short Walk to Tonbridge Railway Station
- Close to Local Schools and Amenities
- Moments from the A21/A26

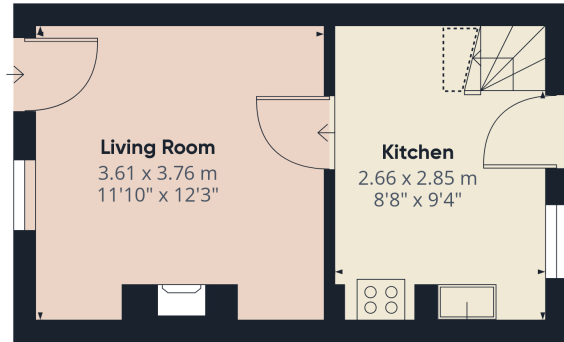

Ground Floor Building 1

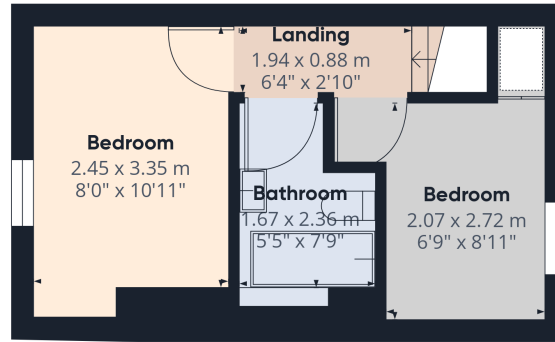

Floor 1 Building 1

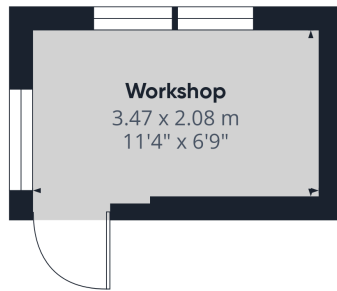

Ground Floor Building 2

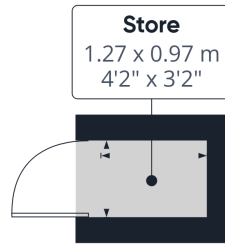

Ground Floor Building 3

Approximate total area⁽¹⁾
52.36 m²
563.6 ft²

Reduced headroom
0.39 m²
4.22 ft²

(1) Excluding balconies and terraces

Reduced headroom
(below 1.5m/4.92ft)

While every attempt has been made to ensure accuracy, all measurements are approximate, not to scale. This floor plan is for illustrative purposes only.

GIRAFFE360

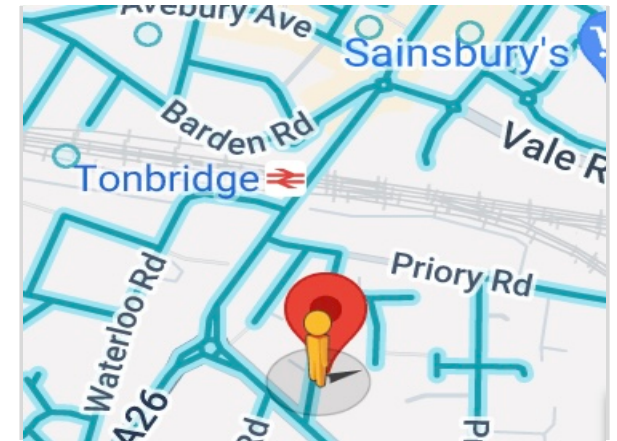

Score	Energy rating	Current	Potential
92+	A		
81-91	B		91 B
69-80	C		
55-68	D	66 D	
39-54	E		
21-38	F		
1-20	G		

Riverside House, River Lawn Road, Tonbridge, Kent TN9 1EP
01732 783 503 | info@tonbridgeproperty.co.uk

www.tonbridgeproperty.co.uk

