



OAKFIELD



Mill Drove, Uckfield
Asking Price £260,000



Mill Drove, Uckfield

Welcome to this lovely two bedroom Victorian flat in the heart of Uckfield! Nestled near centre of town, this charming two-bedroom flat presents a golden opportunity.

Benefitting from share of freehold and a long 105 year lease (as of 1st January 2024).

Middle Flat has its own private entrance. Step inside to discover a delightful home boasting two double bedrooms, a living/dining area perfect for entertaining, and a well-appointed kitchen and family bathroom. The main bedroom offers built in wardrobes, a feature fireplace and double aspect windows.

Bathed in natural light, the property provides a sense of warmth and airiness, creating an inviting feel throughout.

Conveniently positioned near Uckfield's bustling High Street and just a leisurely stroll away from the train station, this property offers not only comfort but also fantastic convenience.

Whether you're stepping onto the property ladder, this flat promises an ideal foundation for a wonderful future in Uckfield.





Sitting Room

17'0 x 12'7 (5.18m x 3.84m)

Kitchen

8'1 x 7'9 (2.46m x 2.36m)

Bedroom

14'9 x 13'1 (4.50m x 3.99m)

Bedroom

11'6 x 11'1 (3.51m x 3.38m)

Council

Council Tax Band - B £1932



Floor Plan

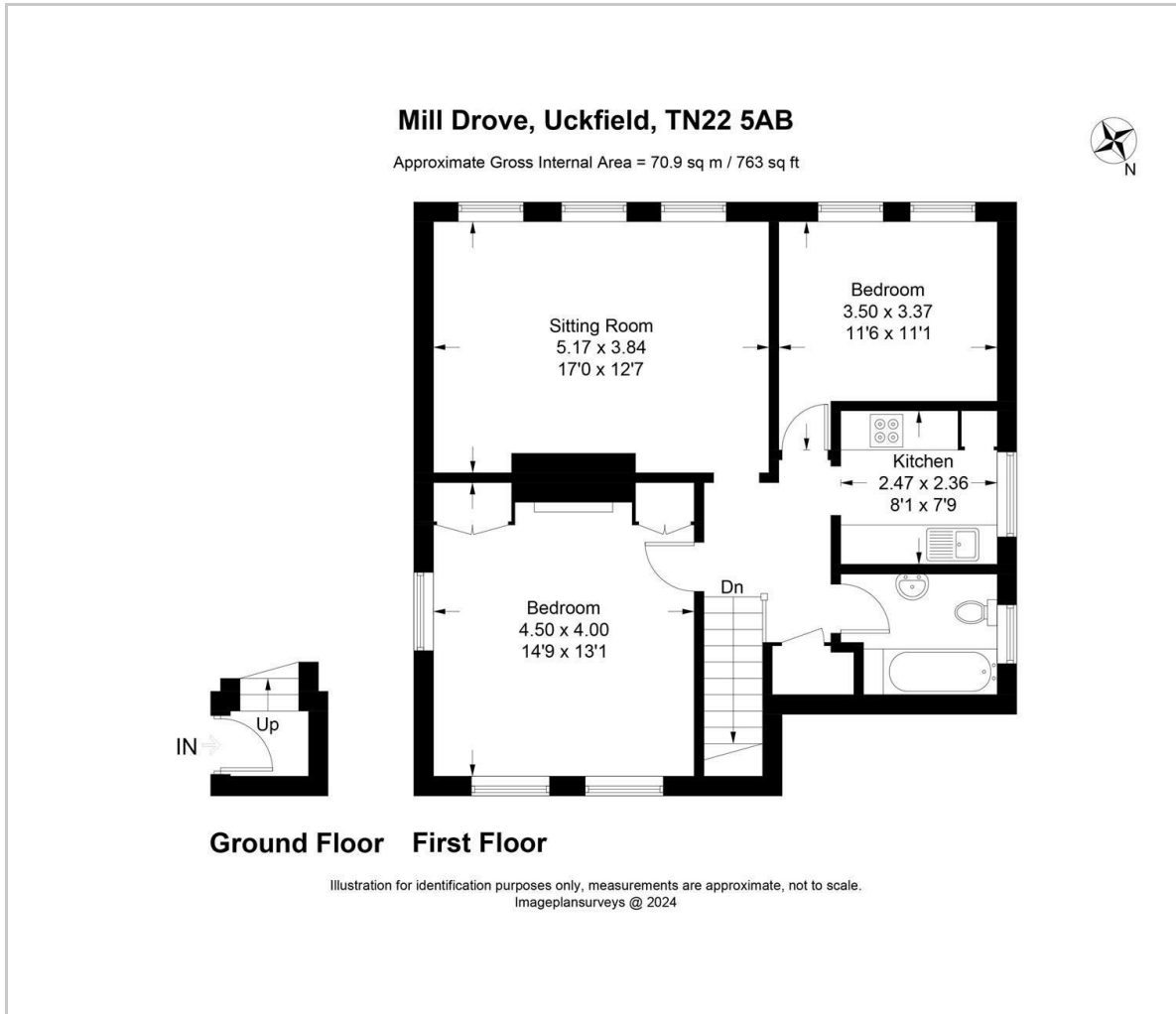

Viewing

Please contact us on 01825 762132 if you wish to arrange a viewing appointment for this property or require further information.

These particulars, whilst believed to be accurate are set out as a general outline only for guidance and do not constitute any part of an offer or contract. Intending purchasers should not rely on them as statements of representation of fact, but must satisfy themselves by inspection or otherwise as to their accuracy. No person in this firm's employment has the authority to make or give any representation or warranty in respect of the property.

Area Map

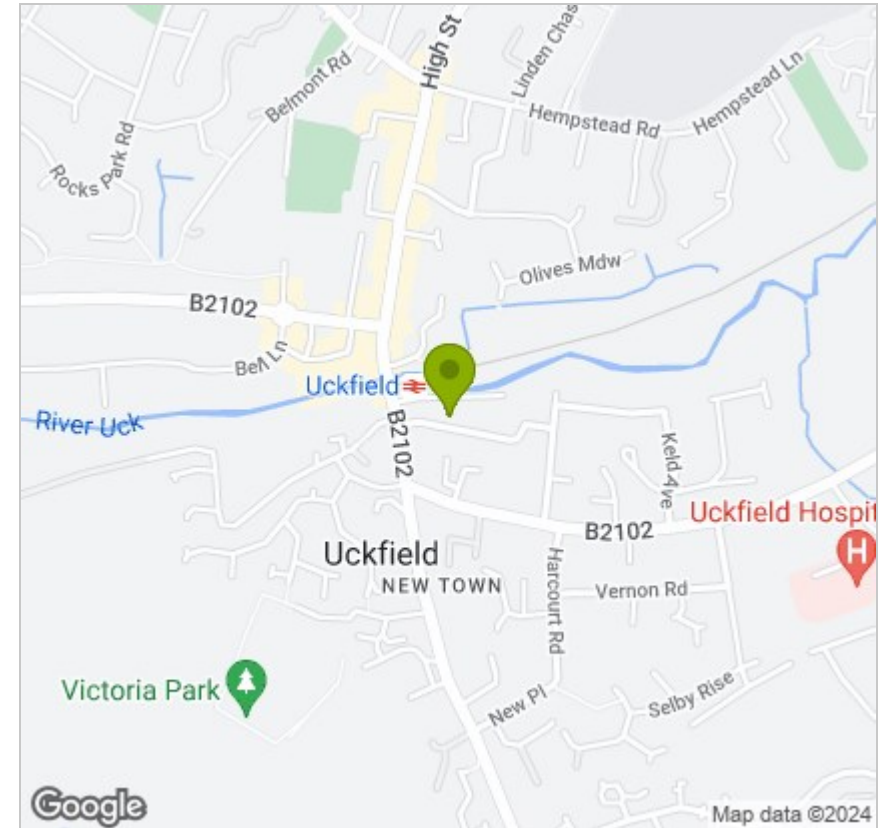

Energy Efficiency Graph

