



OAKFIELD



De Montfort Road, Lewes BN7 1ST

£950 PCM



## De Montfort Road, Lewes BN7 1ST

**\*\*Deposit Replacement Available – Provided by Zero Deposit\*\***

One-Bedroom Ground-Floor Courtyard-Style Garden Apartment with private entrance situated in the popular area of De Montfort road. Nestled in the heart of Lewes, Barnes Stables is just a short walk from the town's vibrant shops, cafes, and restaurants. Excellent transport links provide easy access to Brighton and London.

Accommodation comprises, hallway, double bedroom with built in wardrobes, bathroom with separate w.c, spacious and bright living room with direct access to the private courtyard garden which is perfect for relaxation or entertaining. The property benefits from a allocated parking space. Additional parking can be found on De Montfort road itself but you will need a parking permit from the council to park here.

This apartment is ideal for singles or couples seeking a peaceful retreat with convenient access to Lewes town centre.

Available from the end of July 2024.

Please Note:

An annual household income of £28,500 is required to meet the affordability criteria for this property.

The tenancy will begin with a 12 month initial term.





**Lounge/Diner**  
16'6 x 10'4 (5.03m x 3.15m)

**Kitchen**  
8'0 x 6'6 (2.44m x 1.98m)

**Bedroom**  
2'10 x 10'4 (0.86m x 3.15m)

**Council Tax Band - B £1,947 per annum**



## Floor Plan

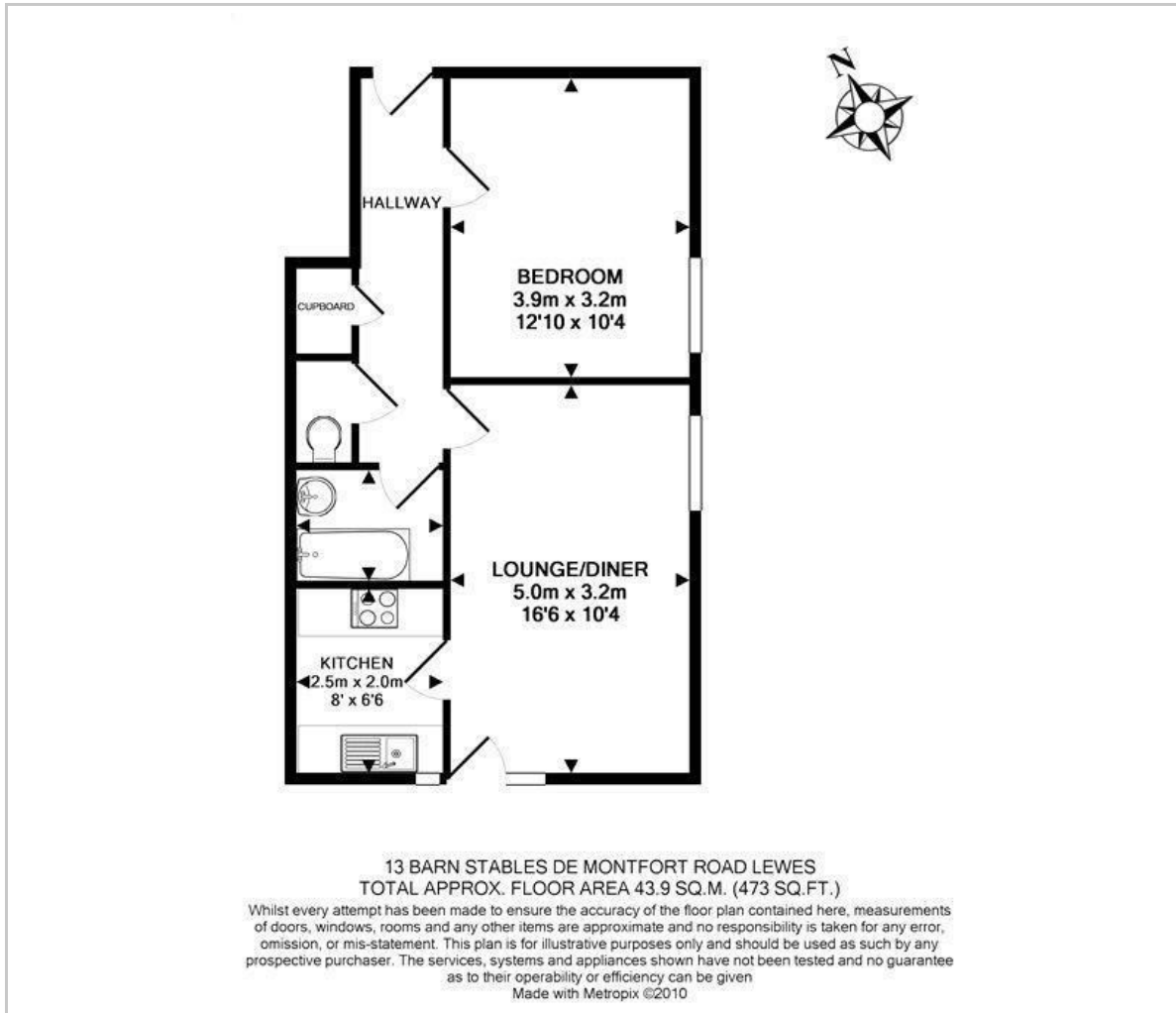

## Viewing

Please contact us on 01273 474101 if you wish to arrange a viewing appointment for this property or require further information.

These particulars, whilst believed to be accurate are set out as a general outline only for guidance and do not constitute any part of an offer or contract. Intending purchasers should not rely on them as statements of representation of fact, but must satisfy themselves by inspection or otherwise as to their accuracy. No person in this firm's employment has the authority to make or give any representation or warranty in respect of the property.

## Area Map

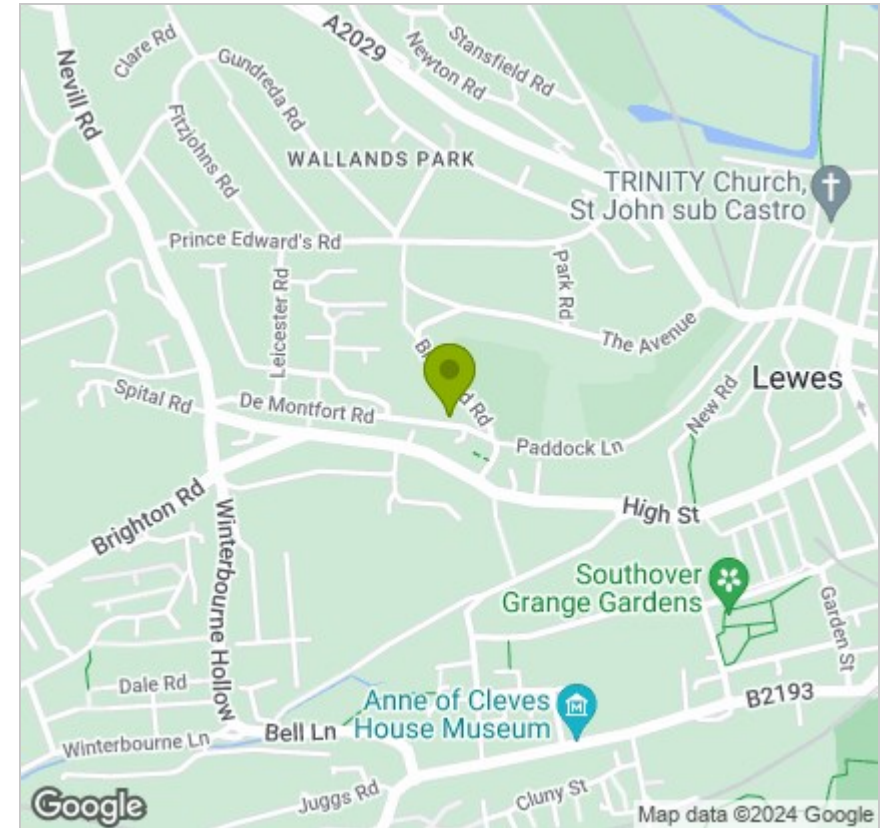

## Energy Efficiency Graph

