



OAKFIELD



Leicester Road, Lewes BN7 1SX

Asking Price £665,000



3



2



2



C

Leicester Road, Lewes BN7 1SX

Charming three bedroom Edwardian house in Lewes. Nestled in the heart of Lewes, this exquisite three bedroom Edwardian house blends timeless elegance with modern comfort.

A stunning ground floor extension, beautifully landscaped garden with patio, and a thoughtfully designed loft conversion make this home perfect for those searching for that forever family home.

Spacious and filled with natural light, each bedroom offers a serene escape, with the extension to the rear offering scope for a potential fourth bedroom, ideal for a guest suite with an additional downstairs shower room effectively serving as a potential en suite for those that wish to use the space as an additional bedroom.

Expansive living space ideal for entertaining, featuring contemporary finishes and large windows that invite the outdoors in.

The expertly designed rear extension offer a variety of uses and would be well suited to an office space or delightful garden room.

Expertly designed garden providing a tranquil oasis, complete with a stylish patio for al fresco dining and summer gatherings, enjoying glorious sunshine throughout the day.

Situated in a desirable area of Lewes, close to local amenities, schools, and excellent transport links.

This property effortlessly combines classic charm with contemporary living, making it an ideal home for those seeking comfort, style, and convenience.

Don't miss the opportunity to own this exceptional Edwardian residence in one of Lewes' most sought-after neighbourhoods. Discover the perfect blend of heritage and modernity in this beautiful Lewes home. Your dream house awaits!





Sitting Room

22' x 11'1 (6.71m x 3.38m)

Kitchen

14'8 x 7'10 (4.47m x 2.39m)

Family Room

12'2 x 8'0 (3.71m x 2.44m)

Bedroom

13'11 x 10'10 (4.24m x 3.30m)



Bedroom

11'0 x 8'9 (3.35m x 2.67m)

Eaves

12'7 x 11'9 (3.84m x 3.58m)

Council Tax Band - D £2,503 per annum



Floor Plan

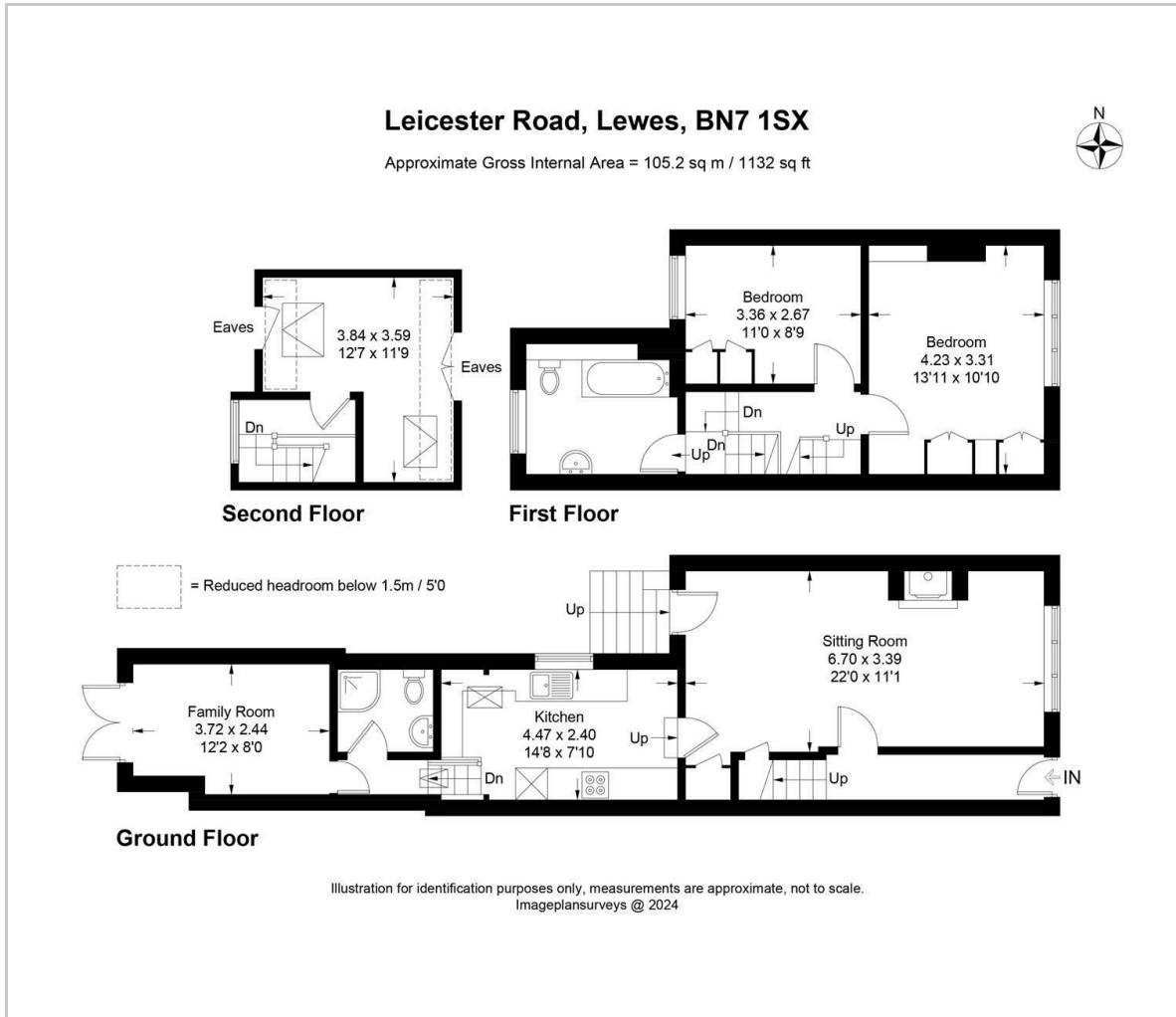

Viewing

Please contact us on 01273 474101
 if you wish to arrange a viewing appointment for this property or require further information.

These particulars, whilst believed to be accurate are set out as a general outline only for guidance and do not constitute any part of an offer or contract. Intending purchasers should not rely on them as statements of representation of fact, but must satisfy themselves by inspection or otherwise as to their accuracy. No person in this firm's employment has the authority to make or give any representation or warranty in respect of the property.

Area Map

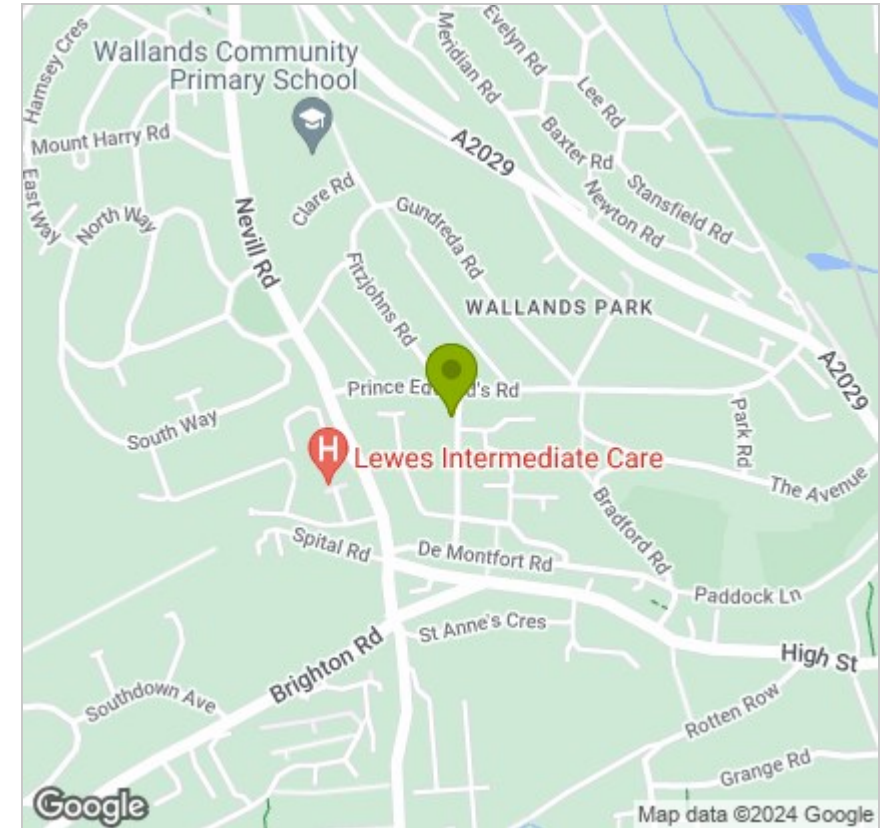

Energy Efficiency Graph

