



OAKFIELD



Church Hill, Ringmer  
Guide Price £425,000

2 1 1 D

## Church Hill, Ringmer

A delightful, homely, detached two bedroom early Victorian cottage situated on the edge of Ringmer within easy walking distance of the village centre. Believed to date back to circa 1822, this property, once part of a row of similar cottages, has withstood the test of time. In need of some modernisation and refurbishment, this charming and much loved home offers huge potential to extend the current living accommodation, subject to the requisite planning consents being attained. With the added benefits of a delightful private rear garden backing on to open fields, and off street parking. For more information call our Lewes branch 01273 474101.

The accommodation comprises covered Porch to Front Door; Reception Hall with quarry tiled floor, half wood panelled walls; Sitting Room with feature brick fireplace with inset wood burner, fitted pine cupboards with shelving over to either side of chimney breast; open Dining Room area with double glazed glass panel door onto side garden, fitted under stairs cupboard; well fitted Kitchen with range of wood-fronted base and wall units, integrated electric oven with gas hob and integrated extractor fan over, under counter space for dishwasher, washing machine and tumble dryer, wall mounted Prima gas fired boiler, tiled floor, double glazed French doors onto rear Garden.

Staircase from Reception Hall to first floor Landing with loft hatch; Principal Bedroom with dormer window and views over the rear garden to the open fields beyond, cupboard housing hot water tank, door into small Study/Dressing Room; Bedroom 2 with feature fireplace and inset cast iron grate, deep fitted wardrobe; Family Bathroom with glass shower cubicle, high cistern WC, vanity unit with inset hand wash basin, heated towel rail, half panelled walls, vinyl wood effect floor cover.

All mains services. Gas fired central heating serving panel radiators throughout. Double glazing throughout. Stripped pine doors throughout. Lewes District Council Tax Band D.





#### Outside:

To the side of the property is an off-street parking space with car port/ pergola structure and a gate leading into the South facing side garden with well stocked raised beds. A brick paved path leads into the tranquil rear garden with a central pond attracting wild Perch and Rudd, surrounded by a lawn and mature hedging and planting, backing directly onto open fields.. This south-westerly facing secluded rear garden is a delight, with an area of crazy paved patio outside of the Kitchen, and to the side a greenhouse, garden shed and outside water tap.

#### Location:

Church Hill is conveniently situated on the edge of Ringmer, within easy walking distance of the village green and the small parade of shops in the village centre. Ringmer has a great community with many events taking place throughout the year. There is also a regular bus service into Lewes and Brighton. The county town of Lewes with its more comprehensive shopping is about 4 miles distant and offers a range of independent shops, restaurants, three major supermarkets and a main line railway station with services to London - Victoria in just over the hour. The famous Glyndebourne Opera House is situated on the edge of the village, about 2 miles distant.



#### Sitting room

11'7" x 10'5" (3.54 x 3.18)

#### Dining room

17'1" x 9'8" (5.22 x 2.96)

#### Kitchen/breakfast room

15'10" x 9'10" (4.85 x 3.00)

#### Bedroom

14'1" x 10'6" (4.31 x 3.21)

#### Bedroom

16'9" x 7'4" (5.13 x 2.24)

#### Dressing room

7'9" x 6'5" (2.37 x 1.96)

## Floor Plan

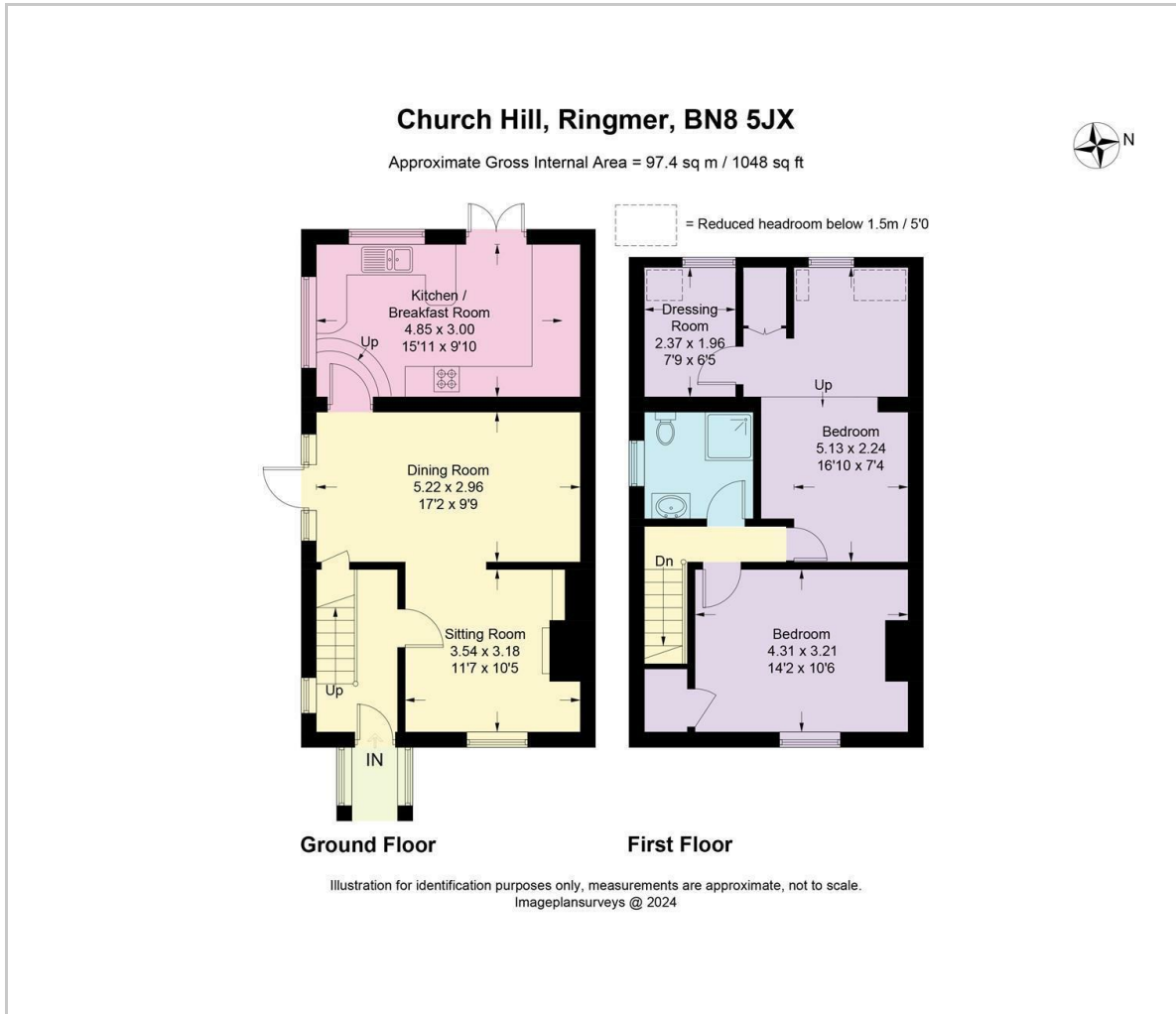

## Viewing

Please contact us on 01273 474101 if you wish to arrange a viewing appointment for this property or require further information.

These particulars, whilst believed to be accurate are set out as a general outline only for guidance and do not constitute any part of an offer or contract. Intending purchasers should not rely on them as statements of representation of fact, but must satisfy themselves by inspection or otherwise as to their accuracy. No person in this firm's employment has the authority to make or give any representation or warranty in respect of the property.

## Area Map

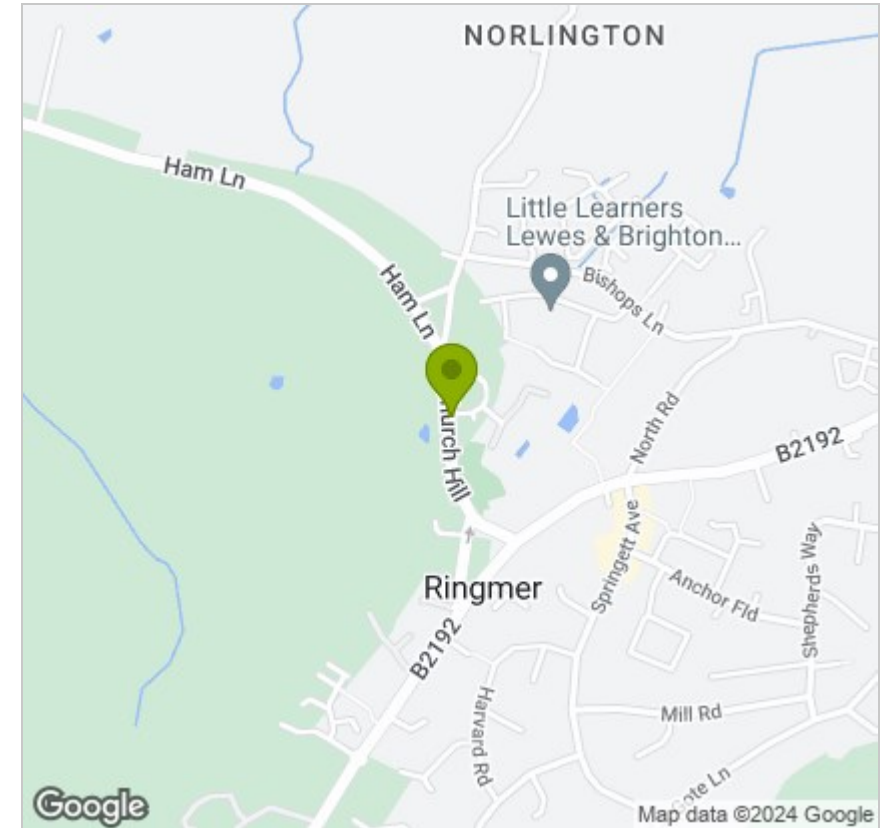

## Energy Efficiency Graph

