



OAKFIELD



Gorse Hill, Broad Oak, Heathfield TN21 8TP

Asking Price £319,950



Gorse Hill, Broad Oak, Heathfield TN21 8TP

Welcome to this meticulously renovated 2-bedroom end of terraced house, exemplifying contemporary living at its finest.

Situated on a larger than usual plot, this home boasts not only modern comforts but also an abundance of space both inside and out.

Upon entering, you are greeted by a seamless transition into the open-plan living room and dining area.

Natural light floods the space through double glazed windows, illuminating the room and creating an inviting atmosphere.

The downstairs area is adorned with luxurious Karndean flooring throughout, adding both elegance and practicality to the space.

Toward the rear of the home lies the beautifully refitted kitchen which features a range of meticulously crafted wall and base units, perfectly complemented by a wood effect work surface.

Equipped with brand new appliances, including a freestanding dishwasher and washing machine, as well as an integrated oven and hob, this kitchen is as functional as it is stylish.

Ascending the stairs, you'll find two generously proportioned double bedrooms, offering ample space for relaxation and rest.

The rear bedroom affords stunning views, providing a picturesque backdrop.

The family bathroom exudes luxury and sophistication, boasting Karndean flooring, a heated towel rail, and a suite comprising a hand wash basin, W/C, and a bath with shower overhead.

Whether unwinding after a long day or preparing for the day ahead, this sumptuous bathroom provides the perfect retreat.

Outside, the property continues to impress with its expansive garden, offering endless opportunities for outdoor enjoyment and relaxation.

A detached garage, coupled with off-road parking, ensures convenience and practicality for residents.

Further enhancing the appeal of this home are its modern conveniences, including double glazing throughout and a brand new central heating system, ensuring year-round comfort and energy efficiency.





In conclusion, this meticulously renovated 2-bedroom end of terraced house presents a rare opportunity to experience modern living at its finest.

With its spacious interior, stunning views, and array of luxurious features, this home offers the perfect blend of style, comfort, and convenience.

Location
Broad Oak is a popular village which has a church, excellent Spar shop/Post Office, hairdressers and bus service.

The bustling High Street in the old market town of Heathfield is only 2 miles away and offers an extensive and diverse range of retailers, supermarkets, banks, cafes and restaurants, whilst the highly regarded community college is just over a mile walking distance.

Sitting Room

16'0 x 11'10 (4.88m x 3.61m)

Kitchen

11'10 x 8'2 (3.61m x 2.49m)

Bedroom

11'10 x 9'1 (3.61m x 2.77m)

Bedroom

11'11 x 7'7 (3.63m x 2.31m)

Garage

6'9 x 8'2 (2.06m x 2.49m)

Council Tax Band - C £2100

Floor Plan

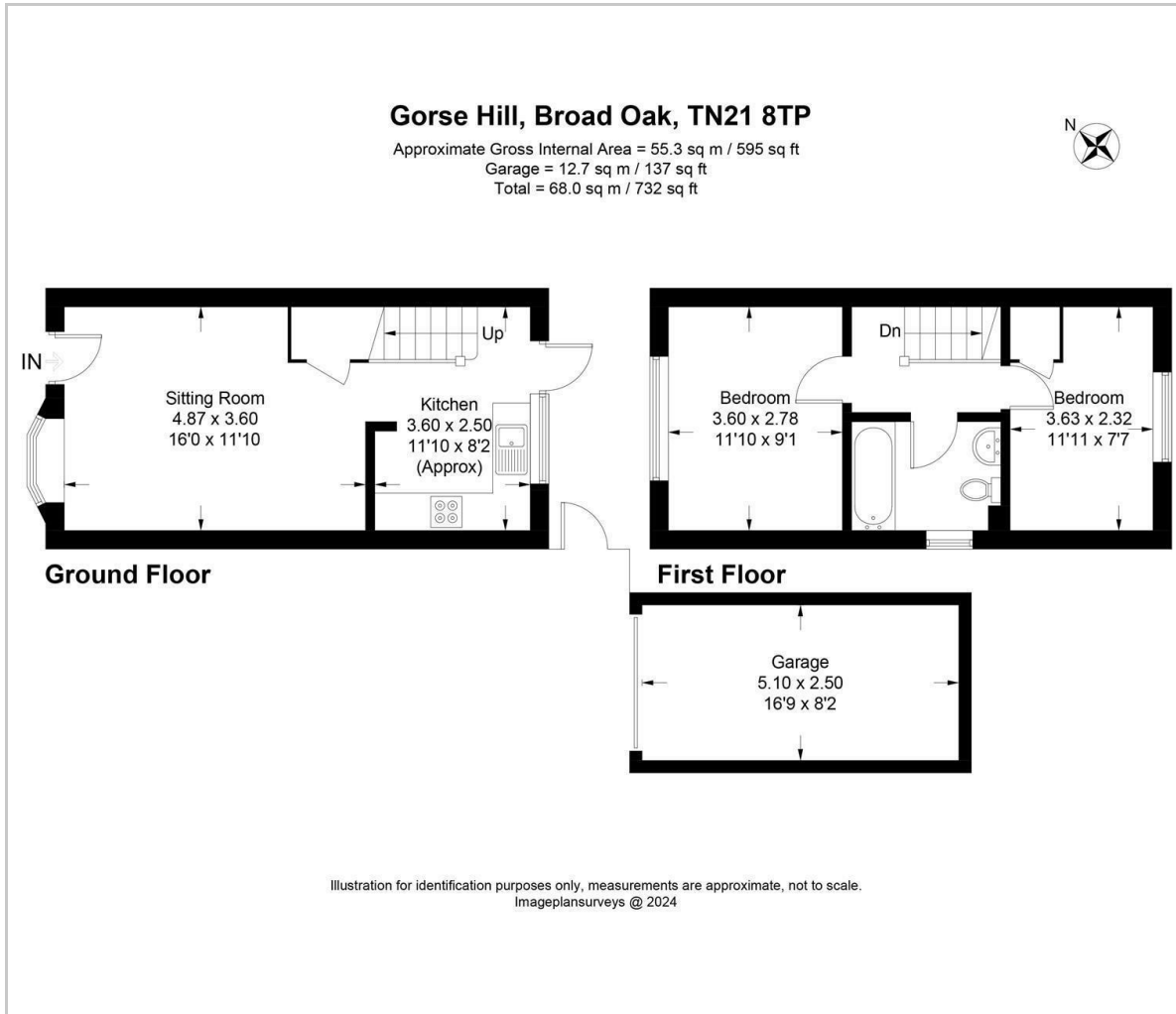

Viewing

Please contact us on 01435 864233
if you wish to arrange a viewing appointment for this property or require further information.

These particulars, whilst believed to be accurate are set out as a general outline only for guidance and do not constitute any part of an offer or contract. Intending purchasers should not rely on them as statements of representation of fact, but must satisfy themselves by inspection or otherwise as to their accuracy. No person in this firm's employment has the authority to make or give any representation or warranty in respect of the property.

Area Map

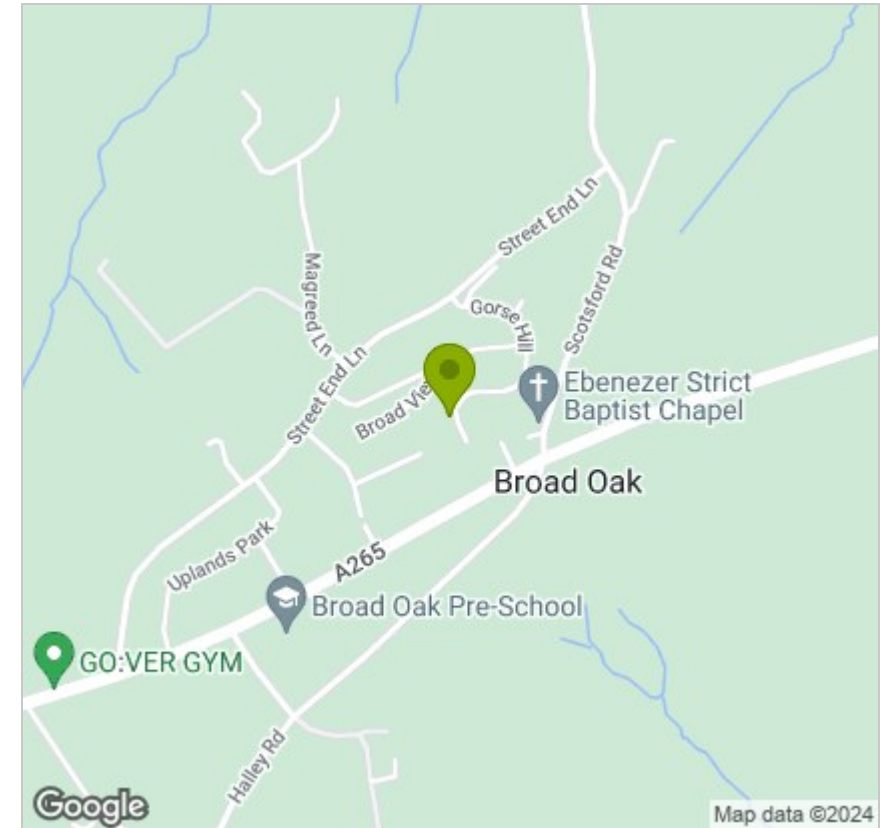

Energy Efficiency Graph

