



**FARROW**  
ESTATE AGENTS



24 Ancholme Avenue, Immingham, DN40 2DR  
Asking price £90,000





## Floor Plan

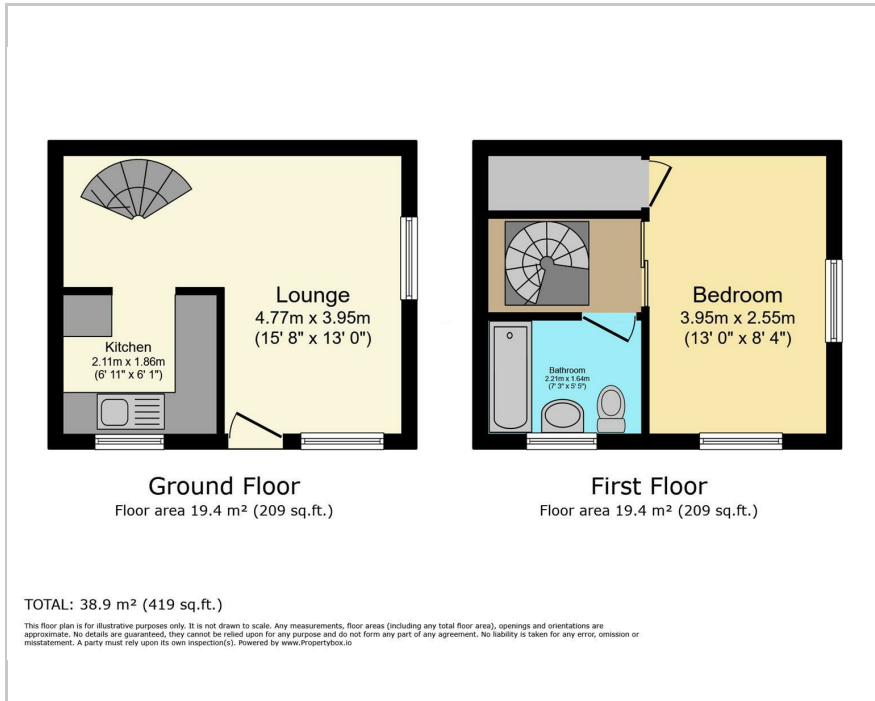

## Area Map

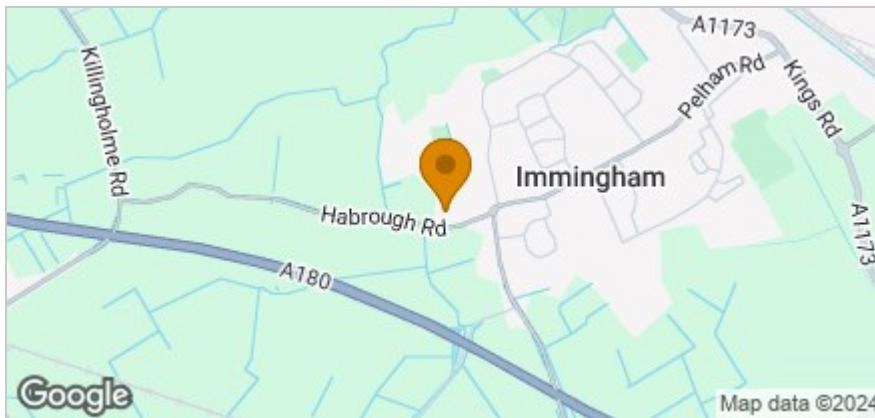

## Accommodation

- Ideal First Time Buy / Investment
- Planning Permission To Extend To The Side
- One Bedroom Semi-Detached Property
- Easy Access To The A180 Motorway
- UPVC Double Glazing & Gas Central Heating
- Convenient Immingham Location
- Short Drive To Local Amenities
- Council Tax Band A & EPC Rating C

## Viewing

Please contact our Farrow Estate Agents Office on 01472 355864 if you wish to arrange a viewing appointment for this property or require further information.

## Energy Efficiency Graph

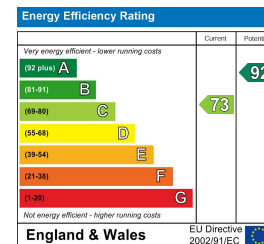

These particulars, whilst believed to be accurate are set out as a general outline only for guidance and do not constitute any part of an offer or contract. Intending purchasers should not rely on them as statements of representation of fact, but must satisfy themselves by inspection or otherwise as to their accuracy. No person in this firm's employment has the authority to make or give any representation or warranty in respect of the property.