

Local expertise with powerful national marketing

EDWARDS
ESTATE AGENTS

EDWARDS
ESTATE AGENTS
01202 855595 FOR SALE
edwardstates.com

COCKERELL CLOSE
WIMBORNE, BH21 1XR



GUIDE PRICE £275,000

This TWO DOUBLE BEDROOM MID TERRACE HOME is conveniently located in popular Merley with local amenities and transport links nearby. Accommodation includes a WELL PROPORTIONED LOUNGE/DINER, MODERN KITCHEN and BATHROOM. The REAR GARDEN is LANDSCAPED FOR LOW MAINTENANCE and has a SUMMER HOUSE.

This well presented home is located in popular Merley, with local amenities and transport links within easy reach and Wimborne town centre just a short drive away.

The property offers well proportioned accommodation including a dual aspect lounge/dining room with stairs rising to the first floor.

The kitchen is fitted with a range of modern base and wall units, with space for free standing white goods.

On the first floor there are two double bedrooms and these are served by a family bathroom fitted with a classic white suite with fully tiled walls and separate shower fitted above the bath.

Outside there is a small frontage with low maintenance landscaping and the rear garden enjoys a good degree of privacy with fencing to all boundaries. A paved patio is ideal for garden furniture and outdoor relaxation and towards the rear boundary there is a summerhouse/garden shed and gated access to the rear of the property. The property also benefits from a garage and allocated parking.

Energy Performance Rating C
Council Tax Band C



Local expertise with powerful national marketing

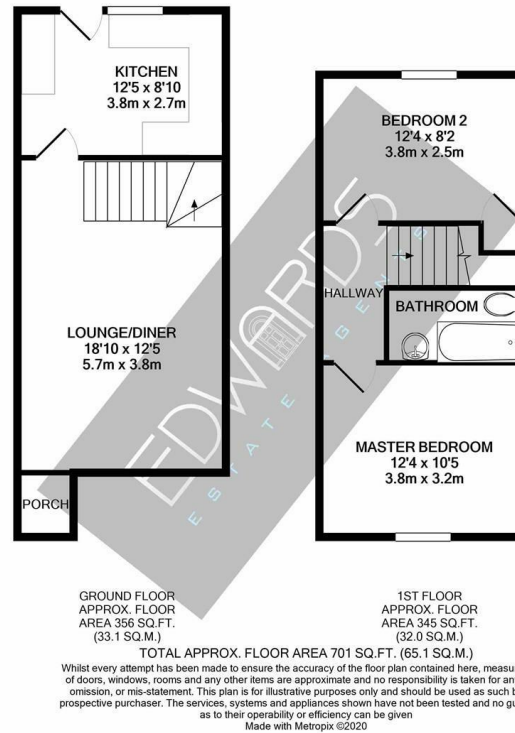

Ferndown Office

404 Ringwood Road, Ferndown, Dorset, BH22 9AU • www.edwardstates.com
01202 855595

EDWARDS
ESTATE AGENTS

These particulars are believed to be correct but their accuracy is not guaranteed and they do not form part of any contract. Whilst every effort is made to ensure the accuracy of these details, it should be noted that the above measurements are approximate only. Floorplans are for representation purposes only and prepared according to the RICS Code of Measuring Practice by our floorplan provider. Therefore, the layout of doors, windows and rooms are approximate and should be regarded as such by any prospective purchaser. Any internal photographs are intended as a guide only and it should not be assumed that any of the furniture/ fittings are included in any sale. Where shown, details of lease, ground rent and service charge are provided by the vendor and their accuracy cannot be guaranteed, as the information may not have been verified and further checks should be made either through your solicitor/conveyancer or by referring to the home information pack for this property. Where appliances, including central heating, are mentioned, it cannot be assumed that they are in working order, as they have not been tested. Please also note that wiring, plumbing and drains have not been checked.