

Local expertise with powerful national marketing

EDWARDS
ESTATE AGENTS

EDWARDS
ESTATE AGENTS
01202 855595 FOR SALE
edwardestates.com

SPICER LANE

BOURNEMOUTH, BH11 9RL

25
SPICER



GUIDE PRICE £585,000

UNEXPECTEDLY RE-AVAILABLE!

Absolutely immaculate, this EXTENDED FIVE BEDROOM detached family home has been EXTENSIVELY UPDATED to create THREE BATHROOMS, two receptions, low maintenance front and rear gardens with SUMMER HOUSE/OFFICE/GYM and OWNED SOLAR PANELS. Ideally located the property is within approximately four hundred meters of local shops and bus stops on King John Avenue and approximately three quarters of a mile from the retail park on Ringwood Road.

Energy Performance Rating B
Council Tax Band E



From the bright and spacious entrance hallway large porcelain tiles continue through to the downstairs cloakroom and kitchen/breakfast room at the rear.

Tastefully done, the kitchen/breakfast room is cream and cherrywood units and large centre island breakfast bar with induction hob, large pan drawers, pop up plugs and quality stone worktops. There are two electric fan assisted ovens and grills plus a full run of larder cupboards. A TV entertainment area (TV subject to separate negotiation) and separate utility room completes this great space.

A box bay window overlooks the front garden in the lounge and features wood effect flooring, modern half panelled walls and inset wood burning stove.

The dining room again has panelled walls plus a suspended ceiling with inset lighting. French doors have a view and lead out to the rear garden patio.

Upstairs, there are five bedrooms. The master suite has a full array of fitted built-in wardrobes and cupboard storage, and lovely en-suite shower room with large cupboard and vanity storage, large mirror with LED lights and 'his and hers sinks'. The guest bedroom also has an en-suite. Bedroom three is a generous double and bedrooms four and five are small doubles. A possibility with the bedroom accommodation would be to create a separate teenager's area by making a doorway off the landing between the guest bedroom and bedroom four.

Beautifully presented, the fully tiled family bathroom comprises a corner shower cubicle, sink, WC and double ended bath with bespoke inset shelving.

Externally, the front garden is low maintenance with artificial lawn and shingled flower beds. Plenty of off road parking is available on the extensive driveway in front of the single garage with up and over door, power and light. Ideal for sun worshipers, the southerly facing rear garden offers a high degree of privacy. Again, low maintenance with artificial lawn, patio and entertaining areas it also has an insulated summer house/gym/office which has power and light, composite decking and owned solar roof panels.



GROUND FLOOR
1043 sq.ft. (96.9 sq.m.) approx.

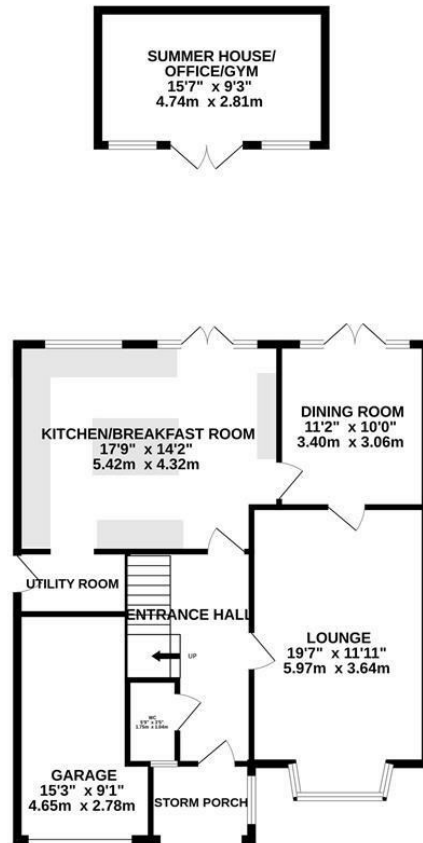

1ST FLOOR
803 sq.ft. (74.6 sq.m.) approx.

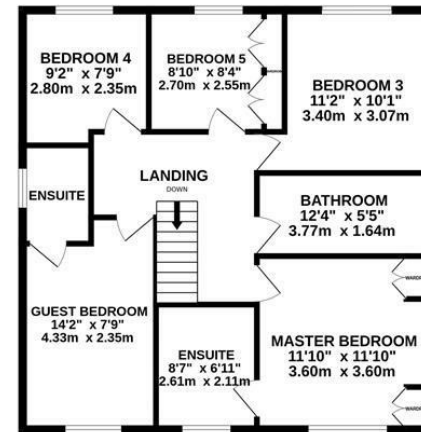

TOTAL FLOOR AREA : 1846 sq.ft. (171.5 sq.m.) approx.

Whilst every attempt has been made to ensure the accuracy of the floorplan contained here, measurements of doors, windows, rooms and any other items are approximate and no responsibility is taken for any error, omission or mis-statement. This plan is for illustrative purposes only and should be used as such by any prospective purchaser. The services, systems and appliances shown have not been tested and no guarantee as to their operability or efficiency can be given.
Made with Metropix ©2024

These particulars are believed to be correct but their accuracy is not guaranteed and they do not form part of any contract. Whilst every effort is made to ensure the accuracy of these details, it should be noted that the above measurements are approximate only. Floorplans are for representation purposes only and prepared according to the RICS Code of Measuring Practice by our floorplan provider. Therefore, the layout of doors, windows and rooms are approximate and should be regarded as such by any prospective purchaser. Any internal photographs are intended as a guide only and it should not be assumed that any of the furniture/ fittings are included in any sale. Where shown, details of lease, ground rent and service charge are provided by the vendor and their accuracy cannot be guaranteed, as the information may not have been verified and further checks should be made either through your solicitor/conveyancer or by referring to the home information pack for this property. Where appliances, including central heating, are mentioned, it cannot be assumed that they are in working order, as they have not been tested. Please also note that wiring, plumbing and drains have not been checked.

Local expertise with powerful national marketing

EDWARDS
ESTATE AGENTS

Ferndown Office

404 Ringwood Road, Ferndown, Dorset, BH22 9AU • www.edwardstates.com
01202 855595