



25 Milton Close, Norwich, NR1 3HX
£475 Per month

This single room to rent is set within a professional house share, located just 0.5 miles from the City Centre and is available from an immediate start.

The room is offered fully furnished and inclusive of bills, with the whole property having just been refurbished. To the rear you will find a large garden with ample outside storage, perfect as a bike shed.

Permit parking is also available in the area



Floor Plan



GROUND FLOOR
APPROX. FLOOR
AREA 415 SQ.FT.
(38.6 SQ.M.)

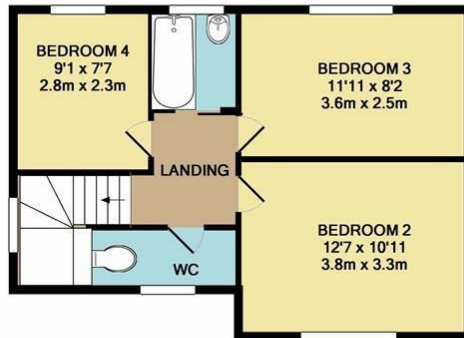

1ST FLOOR
APPROX. FLOOR
AREA 415 SQ.FT.
(38.6 SQ.M.)

TOTAL APPROX. FLOOR AREA 830 SQ.FT. (77.1 SQ.M.)

Whilst every attempt has been made to ensure the accuracy of the floor plan contained here, measurements of doors, windows, rooms and any other items are approximate and no responsibility is taken for any error, omission, or mis-statement. This plan is for illustrative purposes only and should be used as such by any prospective purchaser. The services, systems and appliances shown have not been tested and no guarantee as to their operability or efficiency can be given
Made with Metropix ©2019

Area Map

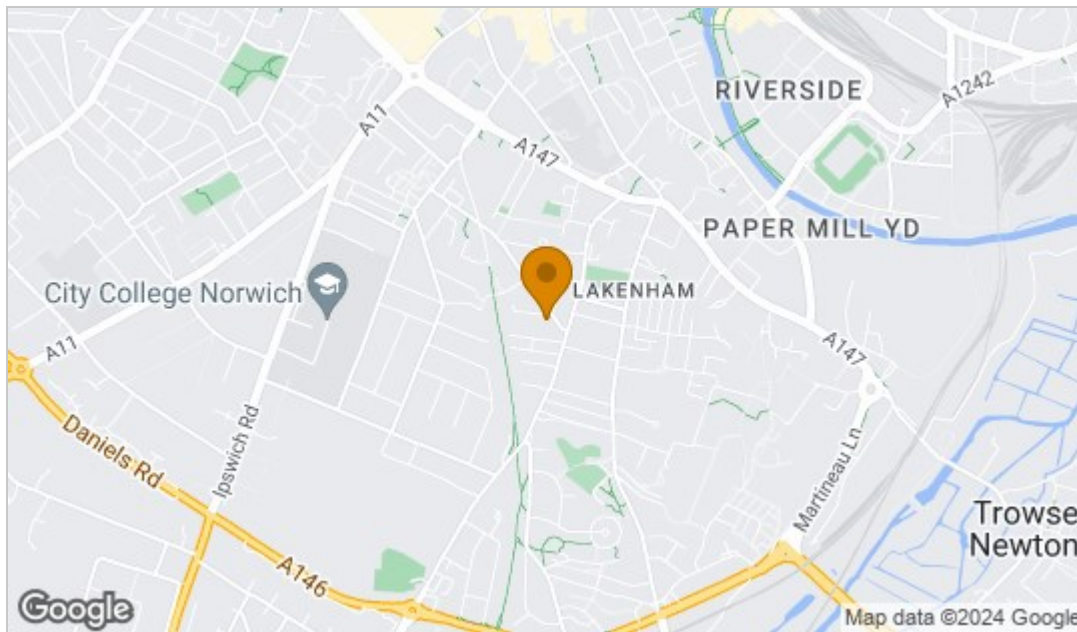

Energy Efficiency Graph

Energy Efficiency Rating		Current	Potential
Very energy efficient - lower running costs			
(92 plus) A			
(81-91) B			
(69-80) C			
(55-68) D			
(39-54) E			
(21-38) F			
(1-20) G			
Not energy efficient - higher running costs			
England & Wales		EU Directive 2002/91/EC	
Environmental Impact (CO ₂) Rating		Current	Potential
Very environmentally friendly - lower CO ₂ emissions			
(92 plus) A			
(81-91) B			
(69-80) C			
(55-68) D			
(39-54) E			
(21-38) F			
(1-20) G			
Not environmentally friendly - higher CO ₂ emissions			
England & Wales		EU Directive 2002/91/EC	

These particulars, whilst believed to be accurate are set out as a general outline only for guidance and do not constitute any part of an offer or contract. Intending purchasers should not rely on them as statements of representation of fact, but must satisfy themselves by inspection or otherwise as to their accuracy. No person in this firm's employment has the authority to make or give any representation or warranty in respect of the property.



T: 01603 558 666
M: 07369213457
E: david@musgroveandcoestates.co.uk
A: 48 Market Place, North Walsham, Norfolk, NR28 9BT