



Highfield Park, Row Town, KT15

Guide Price £600,000

🛏️ 4 🚿 2 🚗 2



This exceptional executive-style residence, nestled in the heart of the prestigious Rowtown area, offers the ultimate in modern living within an exclusive and private cul-de-sac of just eight homes. Designed with contemporary elegance, this stunning property spans three generous floors, providing a perfect blend of style, comfort, and functionality.

The ground floor boasts a sleek, open-plan kitchen/diner, ideal for family gatherings and entertaining, complemented by a separate utility room and a convenient downstairs cloakroom. The impressive reception room, with its floor-to-ceiling views of the beautifully landscaped rear garden, allows for seamless indoor-outdoor living, creating an inviting space for relaxation and socializing.

On the first floor, the luxurious principal bedroom comes complete with a beautifully appointed en-suite shower room, offering a peaceful retreat. Two further double bedrooms are found on this level, including one that has been thoughtfully transformed into a walk-in wardrobe/dressing room, showcasing the home's flexibility. A stylish family bathroom completes this floor.

Ascending to the second floor, you will find a vast double bedroom that spans the majority of the floor, offering an adaptable space that can also function as a private living area or TV room for older children, granting them independence while maintaining close proximity to the rest of the home.

This residence is a perfect blend of sophistication and versatility, offering an unrivaled living experience in one of Rowtown's most desirable locations. A rare opportunity to own a beautifully designed home that perfectly balances luxury and family living.



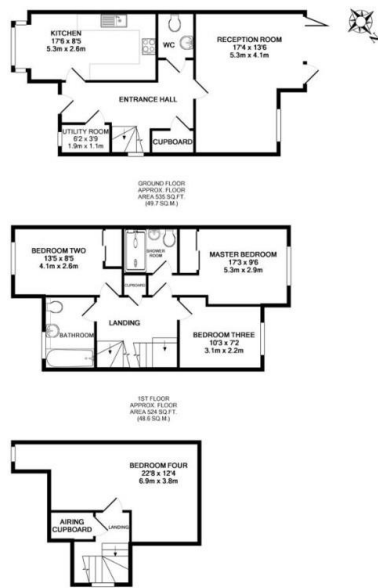

- Sought-After Location
- Immaculate Condition
- Modern Kitchen / Diner
- Family Bathroom & En-Suite To The Main Bedroom
- Close Proximity To Good Schools
- Driveway
- Generous Hallway & Landing Spaces
- Four Double Bedrooms
- Easy Access To Local Shops & Motorway Network
- Private Rear Garden

