



AR

ALEXANDER RUMSEY
REAL ESTATE

Dartnell Avenue, West Byfleet, KT14 6PJ

£1,250,000

5 4 3



Welcome to this stunning detached chalet bungalow, a contemporary retreat located on one of the most prestigious avenues in West Byfleet. Boasting nearly 3,000 square feet, this residence perfectly combines spaciousness, style, and modern convenience.

The interior features a sleek kitchen with a central island, ideal for culinary creativity and casual dining. The home includes three versatile reception rooms, perfect for relaxation or entertaining guests. The lounge, enhanced by a cozy log-burning stove, exudes warmth and character, while the conservatory offers a seamless transition to the outdoor space. Practicality is ensured with a dedicated utility room and cloakroom.

With five generously-sized bedrooms and four modern bathrooms, this home provides ample space for a growing family or guests. The contemporary design flows effortlessly throughout, creating a welcoming and stylish ambiance.

Outside, you'll discover a spacious rear garden with a manicured lawn and a covered decked seating area, perfect for alfresco dining or relaxation. A highlight of the property is the Garden Room/Office, which provides a tranquil workspace complete with an attached shower room.

Conveniently located within walking distance of West Byfleet, this property also features a gated driveway for secure parking. West Byfleet offers a variety of high street shops, unique boutiques, and a Waitrose supermarket. The mainline train station is nearby, providing fast and frequent service to London Waterloo.

The picturesque surrounding countryside is ideal for walking, cycling, and riding. The area is home to several renowned golf courses, including The Wisley, Wentworth, and Queens Wood, with Pyrford, West Byfleet, and New Zealand courses just minutes away. West Byfleet also boasts numerous educational options, with a range of primary and secondary state schools, as well as a selection of independent schools.



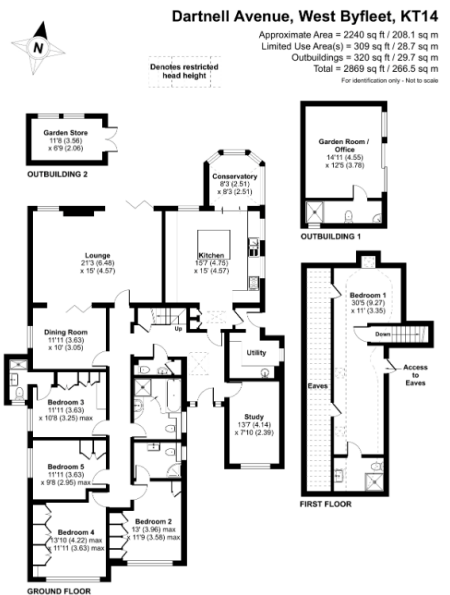

- Arguably One Of The Best Roads In West Byfleet
- Five Double Bedrooms
- Approx 2869 Sqft
- Four Bathrooms
- Substantial Kitchen With Centre Island
- Modern Garden Office With Bathroom
- Three Separate Reception Rooms
- Gated Driveway Providing Ample Off Road Parking
- Within Walking Distance Of West Byfleet Village & Station
- Stunning Large Rear Garden

