

3 The Green, Stoke-on-Trent, ST10 2AG

£740 PCM





ABODE are delighted to offer this two bedroom cottage situated in the popular village of Kingsley, Staffordshire.

The property briefly comprises of ; Lounge which has a focal fireplace. At the rear of the property is the Kitchen/Diner which has a selection of wall and base units. Family bathroom which has a modern white suite including a corner panelled spa bath with an electric shower over.

The first-floor landing leads to the two good sized bedrooms, the rear bedroom having a built-in storage.

To the rear there is a low maintenance garden having artificial lawn.

Call ABODE to arrange a viewing.

DESCRIPTION

ABODE are delighted to offer this two bedroom cottage situated in the popular village of Kingsley, Staffordshire.

The property briefly comprises of ; Lounge which has a focal fireplace. At the rear of the property is the Kitchen/Diner which has a selection of wall and base units. Family bathroom which has a modern white suite including a corner panelled spa bath with an electric shower over.

The first-floor landing leads to the two good sized bedrooms, the rear bedroom having a built-in storage.

To the rear there is a low maintenance garden having artificial lawn.

Call ABODE to arrange a viewing.







Floor Plans

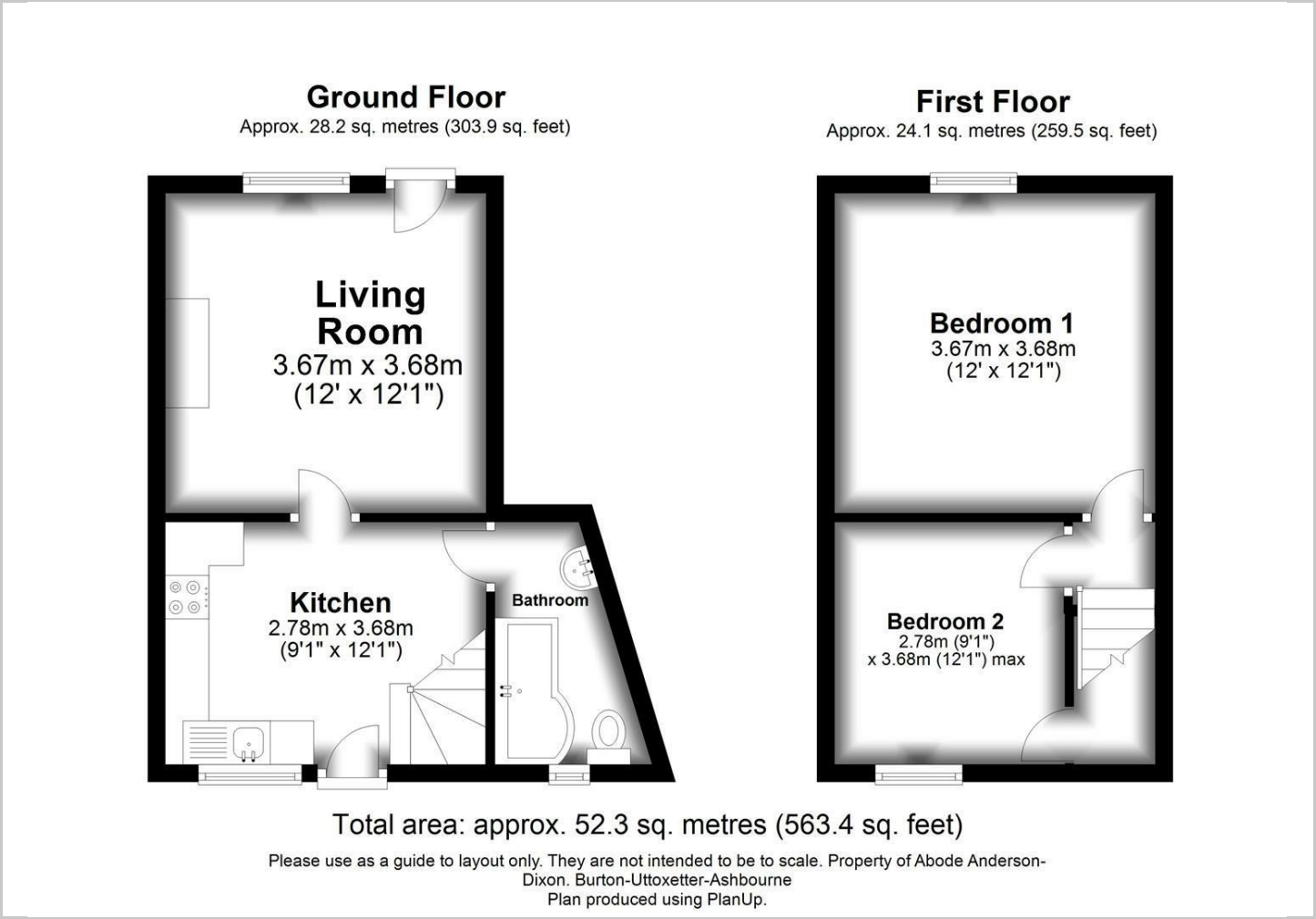

Location Map

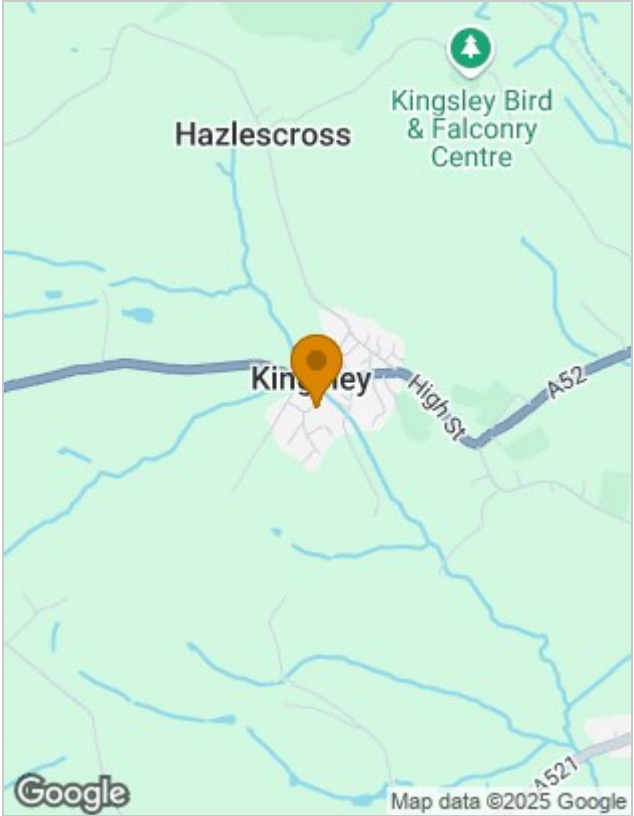

Energy Performance Graph

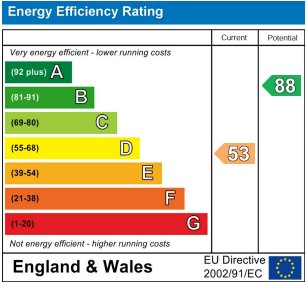

Please contact our Burton Lettings Office on 01283 845888 if you wish to arrange a viewing appointment for this property or require further information.

The particulars are set out as a general outline only for the guidance of intended purchasers or lessees, and do not constitute, any part of a contract. Nothing in these particulars shall be deemed to be a statement that the property is in good structural condition or otherwise nor that any of the services, appliances, equipment or facilities are in good working order. Purchasers should satisfy themselves of this prior to purchasing.