



rybull
group

1a Finsbury Road

£480,000

🛏️ 6 🚿 6 🚪 1



- Freehold six bedroom HMO
- Large garden
- Large communal space
- Short walk to Leagrave train station
- Income producing guaranteed rental agreement in place
- Six bathrooms
- Great location



A six bedroom six bathroom income producing fully licensed HMO investment for sale in a superb location. Benefiting from a guaranteed rental management agreement currently in place until October 2024.

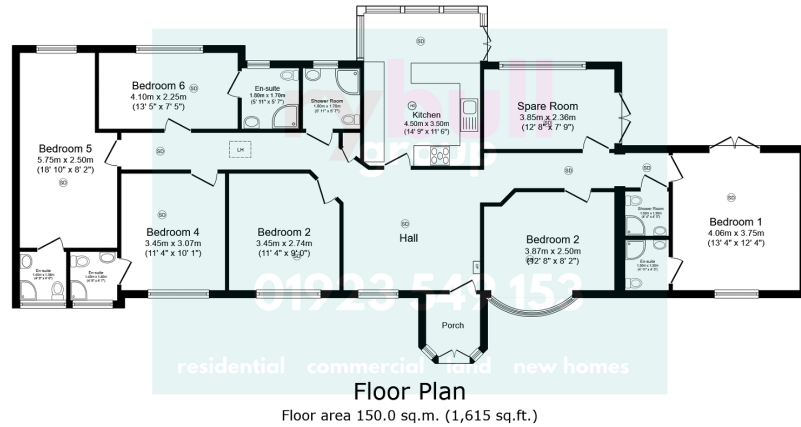

TOTAL: 150.0 sq.m. (1,615 sq.ft.)

This floor plan is for illustrative purposes only. It is not drawn to scale. Any measurements, floor areas (including any total floor area), openings and orientations are approximate. No details are guaranteed, they cannot be relied upon for any purpose and do not form any part of any agreement. No liability is taken for any error, omission or misstatement. A party must rely upon its own inspection(s). Powered by www.propertybox.co

Energy Efficiency Rating		
	Current	Potential
Very energy efficient - lower running costs		
(92 plus) A		
(81-91) B	84	89
(69-80) C		
(55-68) D		
(39-54) E		
(21-38) F		
(1-20) G		
Not energy efficient - higher running costs		
England & Wales	EU Directive 2002/91/EC	

0800 772 3532 / 01923 549 153

enquiries@rybull.co.uk

SAS House, Friarswood, Chipperfield Road, Kings Langley, WD4 9J

www.rybull.co.uk



Agents Notes: All measurements are approximate and quoted in metric with imperial equivalents and for general guidance only and whilst every attempt has been made to ensure accuracy, they must not be relied on. The fixtures, fittings and appliances referred to have not been tested and therefore no guarantee can be given that they are in working order. Internal photographs are reproduced for general information and it must not be inferred that any item shown is included with the property. For a free valuation, contact the numbers listed on the brochure