

oakheart



£1,250,000

Asking Price

Plot 2, Moulsham Green View,  
Chelmsford

Positioned within an exclusive, private development and enjoying views across the prestigious Chelmsford Golf Club, Plot 2 Moulsham Green View is a beautifully designed detached bungalow that exemplifies modern luxury and effortless style. Entered via a private road this property features a high-specification Shaker-style kitchen with integrated Siemens appliances, elegant 30mm quartz worktops, and a Quooker boiling water tap for ultimate convenience. The living spaces are

finished with Amtico flooring, solid oak doors, and contemporary tiling, all complemented by full underfloor heating throughout for year-round comfort.

Enjoy seamless indoor-outdoor living with a private landscaped garden and a dedicated EV charging point, perfect for sustainable living. High-speed fibre broadband ensures you stay connected, while the thoughtfully designed layout offers both privacy and

flexibility. With its blend of timeless craftsmanship and cutting-edge technology, Plot 2 delivers an exceptional lifestyle in one of Chelmsford's most sought-after locations.

Images are CGI and may be of other plots on the development\*



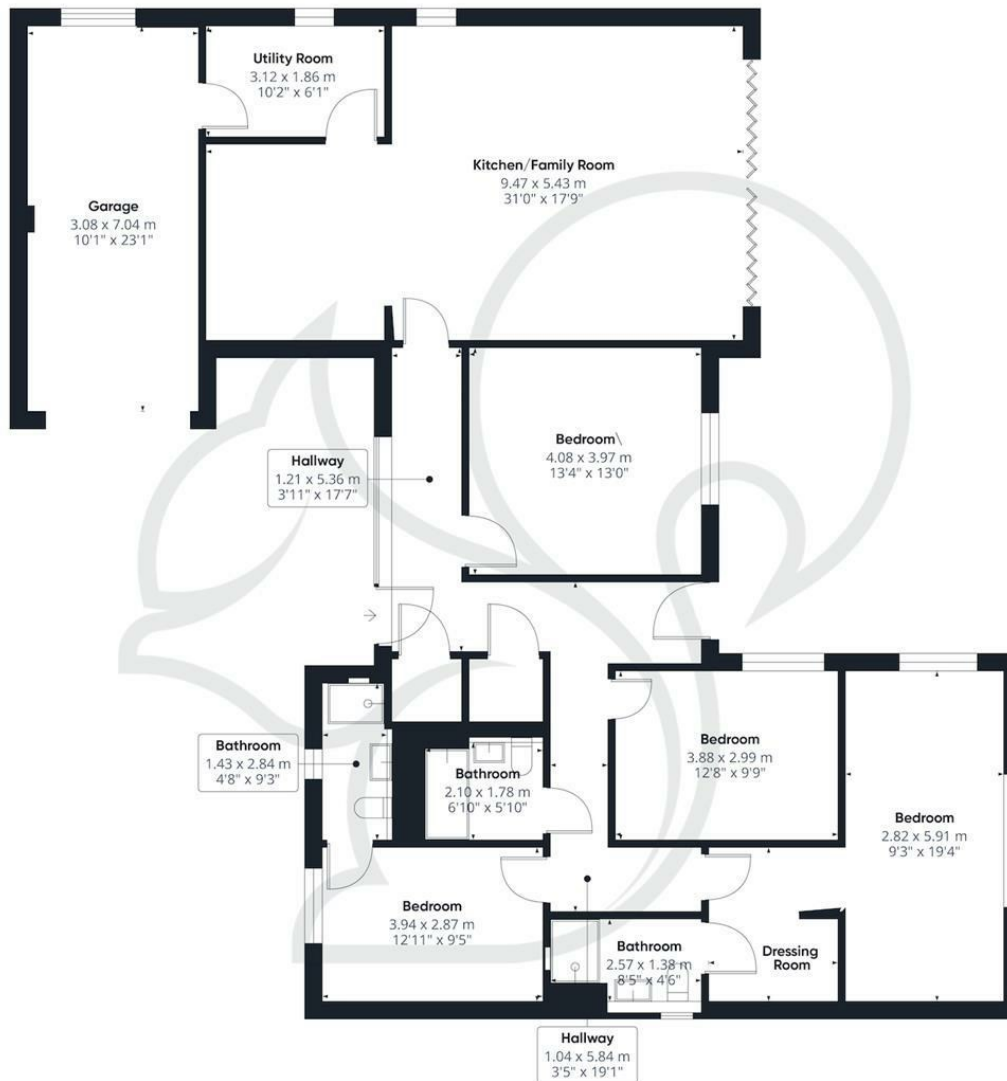

**Local Authority:**  
Chelmsford

**Tenure:**  
Freehold

**Council Tax Band:**  
New Build

#### Energy Efficiency Rating

	Current	Potential
<i>Very energy efficient - lower running costs</i>		
(92 plus) <b>A</b>		
(81-91) <b>B</b>		
(69-80) <b>C</b>		
(55-68) <b>D</b>		
(39-54) <b>E</b>		
(21-38) <b>F</b>		
(1-20) <b>G</b>		
<i>Not energy efficient - higher running costs</i>		
<b>England &amp; Wales</b>	EU Directive 2002/91/EC	

Agents Note: Whilst every care has been taken to prepare these particulars, they are for guidance purposes only. All measurements are approximate and are for general guidance purposes only and whilst every care has been taken to ensure their accuracy, they should not be relied upon.

Oakheart New Homes  
01245 808119  
newhomes@oakheart.co.uk  
20 Victoria Road, Chelmsford, Essex, CM1 1PA

**oakheart**