



38 Woodside Avenue, Corbridge

Guide Price: £375,000

A period, semi-detached property within walking distance of the heart of the desirable village of Corbridge in the Tyne Valley.







38 Woodside Avenue  
Corbridge, NE45 5EL

Ground Floor  
Entrance Hall | Living Room  
Downstairs Cloakroom | Kitchen  
Dining Room | Conservatory  
Utility | Rear Porch

First Floor  
2 Double Bedrooms  
1 Single Bedroom | Family Bathroom

External  
Driveway | Small Front Garden  
2 garden Sheds | Rear Garden

Distances  
Hexham 7 Miles  
Newcastle Airport 13 Miles  
Newcastle Centre 16 miles

Council Tax Band | D

EPC D | Rating 59

Tenure | Freehold

Services | Gas Fired Central Heating  
Mains Electric | Water | Drainage





# ANTON ESTATES

SALES & LETTINGS

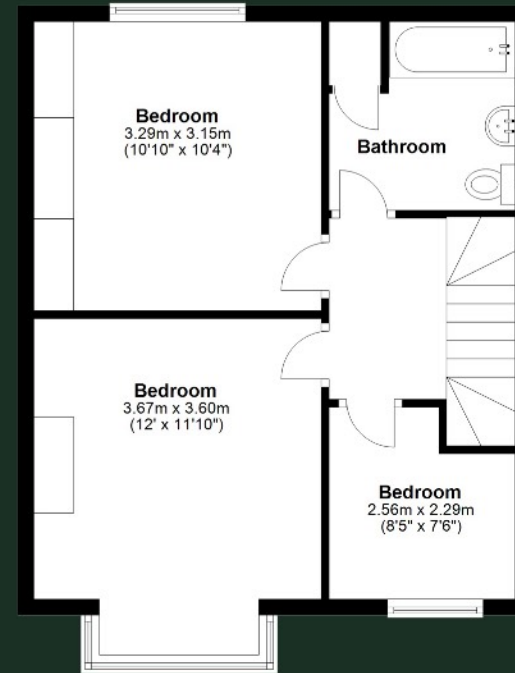
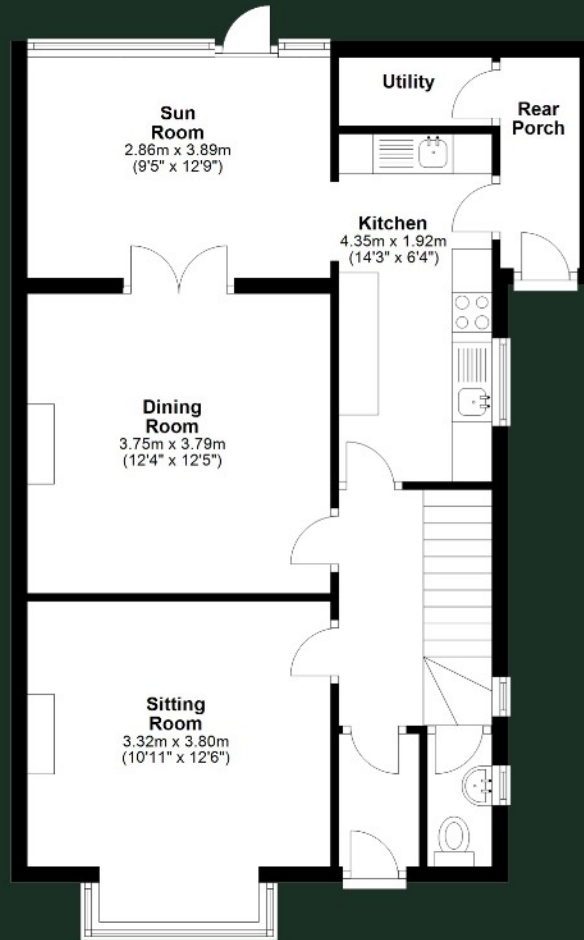

ANTON ESTATES

Telephone: 01434 632 080

Email: [home@antonestates.co.uk](mailto:home@antonestates.co.uk)

Website: [www.antonestates.co.uk](http://www.antonestates.co.uk)

Social Media: @antonestates

Address: 19 Middle Street, Corbridge, Northumberland, NE45 5AT

- These particulars do not form any part of any offer or contract.
- They are intended to give a fair description of the property, but neither Anton Estates nor the vendor accept any responsibility for any error they may contain, however caused. Any intending purchaser must therefore satisfy themselves by inspection or otherwise as to their correctness.
- Neither Anton Estates nor any of their employees has any authority to make or give any further representation or warranty in relation to this property.

